

Boone County Justice Commission Report



Boone County Justice Commission
Aaron Williams and Marcia Wilhoite, Co-Chairs
201 Courthouse Square
Lebanon, Indiana 46052

May 6th, 2022

BOONE COUNTY JUSTICE COMMISSION MEMBERS

Marcia Wilhoite
Co-Chairman
Boone County Council

Don Lamb
Boone County Council

Steve Owens
Boone County Probation

Justin Sparks
Boone County Coroner

Dr. Alex Choi
Zionsville Town Council

Brent Wheat
Lebanon City Council

Jim Caldwell
Advance Town Council

Alyson Gutwein
Zionsville Chamber of Commerce

Lynette Clark
InWell

Dave Truitt
Former Pauper Attorney

Dennis Brannon
Former Boone County Sheriff

Allyson Gutwein
Zionsville Chamber of Commerce

Aaron Williams
Co-Chairman
Boone County Council

Kent Eastwood
Boone County Prosecutor

Michael Nance
Boone County Community Corrections

Mike Martin
Boone County Emergency Management

Clinton Bohm
Whitestown Town Council

Chassity Hawkins
Jamestown Towns Council

Sarah Farfield
Thorntown Town Council

Dr. Ray Ingham
Witham

Dianna Huddleson
Aspire

Adam Owens
CEO- RL Turner Corporation

Molly Whitehead
Economic Development Corporation

- **Bolded names identify members of the Executive Committee**

Table of Contents

I. STATUTORY DIRECTIVE	4
II. BACKGROUND AND SUMMARY OF PUBLIC MEETINGS AND WORK STUDY GROUPS	4
A. BOONE COUNTY JAIL PROJECT TIMELINE.....	4
B. BOONE COUNTY COMMISSION PUBLIC MEETINGS	6
III. COMMISSION FINDINGS & RECOMMENDATIONS	7
A. COMMISSION FINDINGS.....	7
1. Jail and Administrative Space Expansion Work Group.....	7
a. Jail Space.....	7
b. Jail Staffing	11
c. Inmate Meals.....	12
d. Inmate Medical.....	12
e. Soft Costs	13
f. Administrative Space.....	13
2. Community Corrections and Probation Work Group.....	14
3. Prosecutor’s Office Work Group.....	15
4. Coroner’s Office & Morgue Work Group.....	15
5. Court/Flex Space Work Group.....	16
6. Mental Health and Infirmary Work Group.....	16
7. Juvenile Justice Work Group	18
B. COMMISSION RECOMMENDATIONS	18
IV. CONCLUSIONS & NEXT STEPS	19
V. APPENDIX	19
A. <u>Exhibit 1</u> : Boone County Board of Commissioners Resolution 2021-14.....	2 pgs.
B. <u>Exhibit 2</u> : Boone County Council Resolution 2021-01	2 pgs.
C. <u>Exhibit 3</u> :Boone County Board of Commissioners Jail Project Plan	18 pgs.
D. <u>Exhibit 4</u> : 2022 Indiana Department of Correction Boone County Jail Inspection Report.....	16 pgs.
E. <u>Exhibit 5</u> :Boone County Justice Commission Workgroup Questionnaire.....	16 pgs.

FINAL REPORT

Commission findings on the implementation of the proposed Boone County Justice Center:

I. STATUTORY DIRECTIVE

The Boone County Council (“Council”) is the County fiscal body for Boone County (“County”) and the Boone County Commissioners (“County Commissioners”) is the County executive. Pursuant to the powers set forth in Indiana Code § 36-1-10 *et. seq.*, the Council, acting in its capacity as the County’s fiscal body, established the Boone County Justice Commission (“Commission”) to conduct an investigation into the perceived need for a new Boone County Jail and Correctional Facility for the purpose of correcting deficiencies and insuring adherence to law, county policies, and regulations. To that extent, the Council charged the Commission with the following:

1. Engage in constructive dialogue pertaining to the need for a Boone County Justice Facility;
2. Evaluate the needs, scope, and plans pertaining to the proposed jail expansion, a new justice center, and the repurpose of existing correctional facility buildings;
3. Identify any cost savings through gains in efficiency or through innovative ideas that meet the goals of public safety;
4. Generate a report containing recommendations based on information gathered at investigative meetings and work study committees.

II. BACKGROUND AND SUMMARY OF PUBLIC MEETINGS AND WORK STUDY GROUPS

A. BOONE COUNTY JAIL PROJECT TIMELINE

The Council, at the May 11, 2021 Boone County Council Meeting, first heard a presentation by the County Commissioners regarding a timeline to pass a .2% Jail Local Income Tax (“Tax”) in July and August of 2021 in order to fund bonds to pay for the capital and operational costs for a Jail Expansion and new Boone County Justice Center (collectively, hereinafter referred to as the “Jail Project”).

In July of 2021, the Council did not pass the requested Tax as no tangible plan existed with respect to the Jail Project that could be evaluated and shared with the public. Several Council members asked the County Commissioners to share the plan for the Jail Project so that it could be investigated and an additional appropriation could be sought to fund it.

On August 2, 2021, the County Commissioners passed Resolution No. 2021-14: A Declaration of Official Intent to Reimburse Expenditures. This Resolution set forth that the County intends to finance the construction of the Jail Project pursuant to a subsequent ordinance to be adopted by the County. The Resolution further states that the County expects to issue debt or enter into a lease financing for the Project and intends to use the proceeds to reimburse or pay costs of the Project. [*Resolution 2021-14*, is attached as Exhibit 1].

On August 10, 2021 at their regular meeting, the Council was presented with and was asked to vote upon Resolution 2021-01 by the County Commissioners. However, the text of Resolution 2021-01 indicated that Council had already investigated the need for the Jail Project in Boone County. This was not a correct statement as the Council had not met to discuss it and was not aware of the details surrounding it. Review of Resolution 2021-01 would have obligated Boone County to fund the Jail Project. As the Council had not yet investigated the need for the Jail Project, but determined they had a statutory obligation to do so, Resolution 2021-01 did not receive the necessary votes from Council to pass on first reading. As a result, the Jail Project was not approved by Council and was not further discussed that evening. [*Resolution 2021-01*, is attached as Exhibit 2].

At the next regular Council meeting on September 14, 2021, in response to the presentation of Resolution 2021-01 to the Council on August 10, 2021 by the County Commissioners, the Council voted to establish the Boone County Justice Commission (“Commission”) in order to assist in the completion of their investigative duty of the Jail Project pursuant to Indiana Code § 36-1-10 *et. seq.*

On October 5, 2021, the Council discussed the formation of the Commission to carry out their investigatory duty under Indiana Code § 36-1-10 *et. seq.* and discussed the formation of Commission Work Study Groups (“Work Study Groups”) that would meet separately to discuss each area of the new Jail Project in more depth.

The County Commissioners convened via a Town Hall meeting on October 28, 2021 for the purpose of informing the community about the need to update the County’s criminal justice facilities. During the town hall, the Commissioners explained the County’s current conditions and its expected future needs that compelled them to decide a new justice center is in the best interests of the residents of Boone County. A video of the town hall meeting, as well as the materials presented at the meeting, can be viewed here: <https://www.livinginboonecounty.com/boone-county-board-of-commissioners-town-hall-meeting-october-2021/> . [*The Plan* is attached as Exhibit 3].

The next day, on October 29, 2021, the Executive Committee of the Commission met to discuss the formation of the Commission and the Work Study Groups.

The Work Study Groups met several times a month beginning in November of 2021 in order to evaluate the need for each identified area of the Jail Project. The Work Study Groups then reported their findings to the Commission at each of their regularly scheduled monthly meetings that were open to the public. These meetings were held on the second Monday of each month, beginning in November of 2021 and ending in April of 2022, at 6:30 p.m. at the Boone County Fairgrounds¹.

As a result of these public meetings and information gathered throughout the investigation, the Commission has compiled a report of their findings into this document entitled the Boone County Justice Commission Report (“Commission Report”). On May 6th, 2022, the Executive Committee of the Commission met to discuss the Commission Report. At the conclusion of the meeting, the Executive Committee unanimously voted to release the Commission Report to the Council. As such, the Commission Report will be provided to the Council at their next regular scheduled meeting on May 10, 2022 at 8:30 a.m.

¹ It should be noted that the February 2022 Commission meeting was cancelled due to insufficient public notice from the County Auditor. In lieu of this meeting, a link to the January meeting of the Justice Reinvestment Advisory Council (JRAC) was provided to Commission members. The JRAC presents a transformative effort to reform criminal justice in Indiana through a 2023 legislative effort with strong support from all three branches of the state government. The email also included the 2022 Indiana Department of Correction Boone County Jail Inspection Report (“2022 IDOC Report”). [The 2022 IDOC Report is attached as Exhibit 4].

B. BOONE COUNTY JUSTICE COMMISSION PUBLIC MEETINGS

The Commission, pursuant to Indiana Code § 36-1-10-7(c)(2), was created by the Council to investigate the need for the proposed justice center and jail expansion. The Jail Project, as designed by the County Commissioners, intends to add approximately two hundred (200) beds to the current jail facility and include a new complex for probation and community corrections, the coroner's office, a morgue and expanded infirmary, a juvenile justice center, and mental health services. The Commission convened five publically noticed meetings to discuss the needs, scope, and plans pertaining to the proposed jail expansion. These meetings were held on: 1) Monday, November 8th, 2021; 2) Monday, December 13th, 2021; 3) Monday, January 10th, 2022; 4) March 14th, 2022; and 5) April 12, 2022. Minutes from each of the aforementioned meetings can be found on the Council's webpage located at: <https://boonecounty.in.gov/offices/county-council/council-meetings/>.

Based on the Plan received from the County Commissioners on November 1, 2021, the Commission identified seven (7) categories that required evaluation as they relate to the Jail Project and its perceived need. (See *Figure 1* & *Figure 2*, below). The seven categories were split into specific Work Groups that reported their findings to the Commission. The Work Groups established are: (1) Jail and Administrative Space Expansion; (2) Community Corrections and Probation; (3) Prosecutors Office; (4) Coroner's Office/Morgue; (5) Court/Flex Space; (6) Mental Health; and (7) Juvenile Justice.



Figure 1: Obtained from the County Commissioners October 28, 2021 presentation, the Jail Project, *if determined to be necessary as proposed*, will consist of a new mental health housing unit addition, a new juvenile detention & coroner addition, a new probation & community corrections addition, and a new sheriff's administration addition. Each Work Group was developed to address the specifics of each proposed addition to the existing jail facility. Please refer to Exhibit 3 for the entire Jail Project as proposed by the County Commissioners

PRELIMINARY BUILDING GROSS SQUARE FEET (BGSF) AREAS BASED UPON CURRENT AND PROPOSED FUTURE USE ACTUAL AREAS MAY VARY	
SUMMARY	
Area Name	BGSF
1,000 SHERIFFS ADMINISTRATION	9,254
2,000 INVESTIGATIONS / LAB	4,978
3,000 DISPATCH	2,141
4,000 JAIL ADMINISTRATION, STAFF SUPPORT AND CONTROL	1,642
5,000 INTAKE	9,922
6,000 MEDICAL	2,874
7,000 PROGRAM SERVICES	9,145
8,000 HOUSING	31,087
8,000 HOUSING SHELL	
9,000 FOOD SERVICE	4,453
10,000 LAUNDRY	428
11,000 MAINTENANCE, BUILDING SERVICES, STORAGE	2,470
12,000 PROBATION AND COMMUNITY CORRECTIONS	13,174
13,000 COMMUNITY CORRECTIONS	18,163
14,000 CORONER	1,071
TOTAL	112,801

Figure 2: Obtained from the County Commissioners October 28, 2021 presentation, the Jail Project consists of an expansion totaling 112,801 sq. ft., with each new proposed section of the new jail facility set forth above

III. COMMISSION FINDINGS AND RECOMMENDATIONS

A. COMMISSION FINDINGS

The Council initiated this Commission in order to gain oversight and transparency into the County Commissioners decision to pursue building/renovating a new Boone County Justice Center. Creating oversight and transparency for Boone County taxpayers was, and still is, the number one goal of the Council and the Commission. Each Work Study Group spent countless hours speaking with experts in each respective field area. Based on the information gathered at each Work Study Group, the 2022 IDOC Report, and the Boone County Justice Commission Workgroup Questionnaire as answered by the County Commissioners (“Workgroup Questionnaire Response”) [*Workgroup Questionnaire Response*, is attached as Exhibit 5], the Commission’s findings are as follows with respect to each area of the proposed Jail Project:

1. Jail and Administrative Space Expansion Work Group

The Jail Project identifies certain needs with respect to the Jail and Administrative Space Expansion. Those needs include a.) Jail Space; b.) Jail Staffing; c.) Inmate Meals; d.) Inmate Medical; and e.) Soft Costs. Members of the Work Group and Commission toured the current jail facility in order to better understand the space. Each identified need will be discussed below in more detail.

a. **Jail Space:** The Jail Project, *as proposed*, is requesting additional jail space to increase the number of incarcerated inmate beds from its current 214 rated beds² to add 102 beds, in order for an initial expansion to reach 316 beds³. (See, Figure 3). A second expansion is planned to increase the bed count to another 48-150 beds. The proposed bed expansion focuses on mental health and rehabilitation, as well as an increased focus on community corrections and work release.

Total Number of Beds: Boone County Jail			
	Current Total Number of Beds	Requested increase Male Inmate Beds	Requested increase Female Inmate Beds
General Population Beds	184	+24	+12*
Mental Health Beds	unknown	+24	+36
Segregation Beds	unknown	unknown	+6
Holding	15	unknown	unknown
Work Release	15	<i>Discussed below</i>	<i>Discussed below</i>
Total	214	+48	+43

Figure 3: Current Bed Inventory and number of requested beds as set forth in both the 2022 IDOC Report (Exhibit 4) and the *Workgroup Questionnaire Response* (Exhibit 5). *The *Workgroup Questionnaire Response* identifies the 12 female beds as *Mental Health beds*, but it was understood to be an error, and meant to be referenced as an increase in general population beds for female inmates. The *Workgroup Questionnaire* also set forth that the general population beds would consist of two (2) to (4) bed cells in a transitional dormitory style, while the special needs beds would include medical, mental health, behavioral management, and special custody beds.

² Exhibit 4, 2022 IDOC Report.

³ If you add the current beds in the Boone County Jail (214) and add the 102 new beds, the total number of beds after expansion would be 316. However, The *Workgroup Questionnaire* states the total number of beds after expansion would be 301 beds.

After witnessing the facility first hand, the Commission **recognizes the perceived need for increased jail space** in order to accommodate more jail beds. However, no scientific data explaining that need was presented. At best, the data presented by the County Commissioners conflicts with the perceived need for increased jail space.

First, since 2018, the average monthly inmate population has actually decreased, not increased⁴. (See, **Figure 4**). Second, due to the focus on mental health and rehabilitation, and the philosophy that Boone County prosecutors and Judges may shift sentencing guidelines to utilize more community corrections and work-release programs, the **need** for secured jail beds theoretically would **decrease** in that the inmates would be utilizing work-release beds or receiving mental health services instead of residing in the secured jail facility.

Average Monthly Population of the Boone County Jail					
	2021	2020	2019	2018	2017
January	125	204	203	213	178
February	126	190	210	225	203
March	124	170	201	227	192
April	125	118	200	222	208
May	129	103	208	220	211
June	136	100	220	225	221
July	143	102	212	209	209
August	134	114	217	205	222
September	145	126	220	190	227
October	141	142	197	191	215
November	150	139	199	187	206
December	148	131	187	193	208
Average Monthly Population	136	137	206	209	208

Figure 4. Average Monthly Population of the Boone County Jail shown to decrease since 2018.

⁴ See Exhibit 5, pg. 5.

In order to determine the need to expand the current jail facility to prevent overcrowding, the Commission evaluated the constant state of flux of the inmate population and reviewed the data presented in the Workgroup Questionnaire Response as it relates to the average monthly highest daily population⁵ and the average length of stay for each inmate⁶. (See **Figure 5** and **Figure 6**).

Highest Daily Population- Boone County Jail					
	2021	2020	2019	2018	2017
January	134	215	213	226	197
February	136	200	225	235	211
March	133	189	211	241	208
April	136	138	209	234	223
May	140	113	216	234	220
June	154	109	235	237	230
July	153	108	221	219	224
August	142	129	230	212	237
September	153	140	233	201	246
October	148	152	207	205	225
November	161	147	212	195	215
December	159	138	198	199	223
Average Monthly Population	161	215	235	241	246

Figure 5. The average highest daily population in the Boone County Jail Population, as show here, has decreased since 2017.

Average Length of Stay in the Boone County Jail										
	2021	2021	2020	2020	2019	2019	2018	2018	2017	2017
	Male	Female	Male	Female	Male	Female	Male	Female	Male	Female
Average Length of Stay	27.4	20.8	36.7	27.4	25.7	20.5	28.4	25.2	25.2	21.3
Average Felony Length of Stay	52.3	29.8	70.1	58.5	52.3	44.3	64.7	57.2	45.4	37.5
Average Misdem. Length of Stay	14.8	15.3	17.5	12.3	14.9	9.7	15.8	11.8	20.8	17.8

Figure 6. Average Length of Stay of Boone County Jail inmate fluctuates based on type of crime charged against the offenders

⁵ See Exhibit 5, pg. 5.

⁶ See Exhibit 5, pg. 6.

The Commission also reviewed the 2022 IDOC Report. On the date the report was taken, the number of inmates at the jail totaled 148⁷. Accordingly, the Boone County Jail would be at 69% capacity and cannot be considered overcrowded. Nevertheless the County Commissioners have determined that an increase of jail inmates will occur over the next three years: 2023(41 more inmates), 2024 (41 more inmates), and 2025 (43 more inmates). Despite asserting these facts, no data was presented that validates their claim. (See, Figure 7).

Moreover, the percentage of Boone County residents the Jail serves is extremely low. The Workgroup Questionnaire Report⁸ sets forth the percentages of residents served over the past five years:

Residents of Boone County					
	2021	2020	2019	2018	2017
Advance	6	11	12	10	11
Jamestown	24	28	52	67	57
Lebanon	503	469	747	742	798
Thorntown	72	52	95	98	79
Whitestown	43	42	74	62	69
Zionsville	83	69	124	140	182
Boone County Resident Totals	731	671	1104	1119	1196
Total Inmates	1932	1636	2849	2782	2994
Percentage of Boone Residents	37.8%	41.0%	38.8%	40.2%	39.9%

Figure 7. Above data shows a low percentage of Boone County residents utilizing the jail

Findings and Recommendations:

Pursuant to information gathered during the investigation, as well as the data set forth in the 2022 IDOC Report and the Workgroup Questionnaire Report, the Commission finds that **increased jail space is needed** in order to **accommodate the need for an increased number of secured beds**. However, while the Commission finds the **need to expand** exists, the Commission further finds that **the need does not exist to the magnitude presented within the Jail Project**. The Commission therefore recommends that **additional investigation is warranted** to reconcile the differences in data and determine a suitable footprint to address the need for increased jail space and the need for each classification of secured bed type.

⁷ The date of the 2022 IDOC Report was January 20, 2022.

⁸ See Exhibit 5, page 6.

b. **Jail Staffing**⁹: The Commission reviewed the Jail Project’s staffing requests and found as follows with respect to the current state of the jail and the requested increase:

Identified Item	Current Staff	Proposed Staff	Commission Findings	Commission Recommendations
Jail Staffing	Corrections Officers: (2022 budget): 28	+2 in 2023 +\$94,137.84 ¹⁰ ; +5 in 2024 +\$242,404.95; +2 in 2025 +\$149,806.26	Increased jail staff is needed, but the need must be commensurate with the final footprint of the facility	Additional investigation is needed to determine the correct amount of staff needed, but once determined, it is recommended to hire additional staff
	Communications Officers: Unknown current number	+2 in 2023 +\$94,137.84 ¹¹ ; +2 in 2024 +\$96,961.98; +1 in 2025 +\$49,935.42	<i>See above</i>	<i>See above</i>
	Maintenance Technician: 1	+2 +\$45,295.80 ¹²	<i>See above</i>	<i>See above</i>
	Janitorial Staff:1	+2 +\$75,337.60	<i>See above</i>	<i>See above</i>
	General Maintenance: 0	+1 +\$37,668.80	<i>See above</i>	<i>See above</i>
County Budget Increase Required for 2023-2025, Not Including Benefit Package Costs		+\$886,686.49		

⁹ Exhibit 5, pages 8-9.

¹⁰ Exhibit 5, page 3, lists proposed increase in staff costs related to additional corrections officers required to staff proposed Jail Project. This number does not reflect benefit package costs.

¹¹ Exhibit 5, page 3, lists proposed increase in staff costs related to additional communications officers required to staff the proposed Jail Project. This number does not reflect benefit package costs.

¹² Exhibit 5, page 9, lists proposed salary (minus benefit package) for each new maintenance technician, janitorial staff and general maintenance position as required by the proposed Jail Project.

c. **Inmate Meals**¹³: The Commission reviewed the Jail Project with respect to inmate meal needs and found as follows:

Identified Item	Current	Proposed	Commission Findings	Commission Recommendations
<i>Inmate meals</i>	Current Budget (2022): \$360,000 \$2,432.00 per inmate based on 148 inmates	<u>2023: \$420,159</u> \$2,223.00 per inmate based on 189 inmates <u>2024: \$480,318</u> \$2,088.00 per inmate based on 230 inmates <u>2025: \$543,412</u> \$1,990.00 per inmate based on 273 inmates	If projected growth is accurate, the data provided in the Workgroup Questionnaire Response shows a decrease in cost in inmate meals despite the anticipated growth. If the growth is accurate, the need for an increased inmate food budget exists.	If perceived need to expand is determined to exist, increase food budget accordingly. However, additional investigation is warranted to verify costs and understand reasons for a cost/per person decrease.

d. **Inmate Medical**¹⁴: The Commission reviewed the Jail Project with respect to inmate medical needs and services and found as follows:

Identified Item	Current	Proposed Increase	Commission Findings	Commission Recommendations
<i>Inmate Medical</i>	Current Budget (2022): \$725,000 *\$4,898 per inmate based on 148 inmates	2847 sq. foot space <u>2023: \$846,688</u> *\$4,479.00 per inmate <u>2024: \$968,376</u> * \$4,210.33 per inmate <u>2025: \$1,096,000</u> *\$4,014.65 per inmate 2026: \$1,128,880 2027: \$1,162,746 2028: \$1,197,628 2029: \$1,233,557 2030: \$1,270,564 2031: \$1,308,681	From the information presented in the Workgroup Questionnaire Response, the data does not reconcile and appears to be predicated on every new inmate receiving medical services. Current numbers provided appear incorrect, <i>or</i> the future projected costs should be doubled.	The 2022 IDOC report identified a lack of adequate space for medical examination areas. While the need exists , based on conflicting data presented, additional investigation is warranted to determine space needs and associated costs.

¹³ Exhibit 5, page 10.

¹⁴ Exhibit 5, page 10.

e. **Soft Costs¹⁵:** The Commission reviewed the Jail Project’s soft costs requests and found as follows with respect to the requested increase of costs:

Identified Item	Current	Proposed	Commission Findings	Commission Recommendations
<i>Maintenance Contract</i>	Unknown amount	112,801 sq. foot jail proposal requests \$35,000 budget increase for maintenance needs	If jail sq. footage increases, the need for increased maintenance exists	If need to expand is determined to exist, increase maintenance budget accordingly
<i>Staff costs: Furniture, Fixtures, Equipment (“FFE”)</i>		Increased costs for FFE accounted for within total cost of project +\$450.23/sq. foot operating cost	If jail footprint expands, the perceived need exists	If need to expand is determined to exist, increase FFE budget accordingly
<i>Utilities</i>	2021 Budget: \$170,068	Lebanon Utilities indicated no way to predict increase	If jail footprint expands, the perceived need exists	If need to expand is determined to exist, increase utility budget accordingly

f. **Administrative Space:** The Commission reviewed the Jail Project’s administrative space request and found as follows:

	Current	Proposed	Findings	Recommendations
<i>Admin. Space</i>	Unknown sq. footage	9,254 sq. foot space including: 1. New Education & Training Space for Employees 2. Property Room	Based on statistics presented and jail visit by Work Group, increased jail administration space is needed.	Increase current administrative services space to incorporate an education/training space and a property room

¹⁵ Exhibit 5, pgs. 14-15

2. **Community Corrections and Probation Work Group**¹⁶- The Commission reviewed the Jail Project's Community Corrections and Probation request and found as follows:

Identified Item	Current State	Proposed Changes	Commission Findings	Commission Recommendations
<i>Space Increase</i>	<p>15 beds (men only);</p> <p>None have been occupied since beginning of COVID-19 pandemic</p>	<p>18,163 sq. foot addition for 144 beds</p> <p>- <u>Initial expansion of 82 Beds:</u> (58 Male Beds and 24 Female Beds)</p> <p>- <u>Future Expansion of 38 male beds and 24 Female beds</u></p>	<p>Need of increased beds for community corrections is theorized on <i>anticipated</i> increase of use from sentencing recommendations by Prosecutor's Office and Court Order. If <i>actual or planned future use</i> of community corrections programs is <i>increased</i> by Prosecutor/Court, expansion is needed.</p> <p>However, the Prosecutor/Courts have not communicated their current or future intent to increase use of community correction programs</p>	<p>1. Lack of current female beds may justify expansion. Additional investigation is required to determine need & to reconcile costs associated with contracting female services to Hendricks County vs. expansion costs for female beds.</p> <p>2. Additional investigation is needed to determine anticipated intent from the Prosecutor/Court to utilize community corrections vs. jail</p>
<i>Staff</i>	<p>No current staff within the jail facility</p>	<p>12 new employees</p> <p>2 positions are 24/7</p> <p>Each position requires "3" individuals per job</p> <p>Increase Cost: \$1.2M-1.4M</p>	<p>If projected growth is accurate, the perceived need exists for additional staff</p>	<p>If perceived need to expand is determined to exist, hire additional staff.</p> <p>If recommendations are accurate, additional funding is required <i>in excess of</i> current budget allocation. The increase will require investigation into additional funding sources and/or identification of programs/services for reduction elsewhere in County budget in order to accommodate requested increase</p>

¹⁶ Statistics obtained from Exhibit 5, pg. 1 and pgs. 15-16, and discussions held at Commission & Work Study meetings.

3. **Prosecutor’s Office Work Group-** The Commission reviewed the Jail Project as it relates to the requested needs of the Prosecutor’s Office and found as follows:

Identified Item	Current State	Proposed Changes	Findings	Commission Recommendations
Office Space	Located in Office Building owned by County, 384 feet from the Boone County Courthouse.	Vacate current location with new location at new jail space	While additional space may be warranted, it is not necessary or fiscally responsible for the Prosecutors office to relocate to the Jail Facility . Additional options appear available that requires further investigation .	1. Maintain current office footprint and explore available office space near the courthouse in order to reduce commute time and associated travel costs. 2. Investigate ability to terminate private business leases in current County-owned Key-Bank office building 3. Investigate costs of renovation of current County-owned office building for Prosecutor Office needs

4. **Coroner’s Office/Morgue Work Group-** The Commission reviewed the Jail Project as it relates to the requested needs of the Coroner’s Office and Morgue and found as follows:

Identified Item	Current State	Proposed Changes	Findings	Recommendations
¹⁷3,071 sq. Foot New Space in Jail	Location at Witham Hospital- two cooler beds and mobile trailer that is used to house bodies while waiting for autopsies, etc. Current volume: 11.5 bodies per month/130-140 bodies per year	New 3,071 sq. foot space to include space for: 1. Family members of deceased to meet 2. New offices, work stations, changing rooms, file room, conference room, break room, staff bathrooms and showers, public restroom, tissue specimen and equipment room, garage door for moving deceased 3. New lighting, infectious control ventilation, and negative pressure in cold storage areas	1. Based on Commissions Investigation, an expanded Morgue space is needed . 2. Witham Hospital has expressed interest in expanding the building space to suit Coroner’s requests and needs.	Additional investigation into options that include a partnership with Witham should be explored before a final decision is made.

¹⁷ See **Figure 1** & **Figure 2**, above.

5. **Court/Flex Space Work Group-** The Commission reviewed the Jail Project as it relates to the requested needs of the Court and has found as follows:

Identified Item	Current State	Proposed Changes	Findings	Recommendations
Additional flex space and Court Room	Courts are Located in Boone County Courthouse Court staff is housed in the Boone County Courthouse	New Courtroom and related offices in Jail	Based on the information provided with respect to Boone County's current level of incarceration and court utilization, the Work Study group determined the additional request for space and a new courtroom is not needed.	Maintain current court and administrative spaces in Boone County Courthouse. Boone County Judges declined to participate in the Commission study; Work Study Group found lack of desire to hold court in the jail by attorneys; Boone County has not received authorization from the State to add another Superior Court.

6. **Mental Health and Infirmary Work Group¹⁸**- Boone County Mental Health services discussed below are currently only offered for inmates at the Boone County Jail and are not obtainable to the general public. The Commission found that upon release from the jail, all county mental health programming terminated and no additional services were provided to former inmates. The Commission reviewed the Jail Project as it relates to the requested needs of Mental Health Services and the Infirmary and has found as follows:

Identified Item	Current State	Proposed Changes	Findings	Recommendations
Programming Space	No designated mental health space in current jail facility Non-inmate programs being offered at different locations throughout the county	Mental Health "wing" of new proposed jail to house all services in same location	Mental Health Space is needed , but based on the utilization levels of current programs and the data presented, the size of desired space, <i>as proposed</i> , is not justified.	Additional investigation on feasibility of the utilization of a shared flex-space with community corrections or use of the proposed Courtroom space is needed to determine best use of space.
Mental Health Staff	Staff includes: (3) Therapists; (3) Peer Support Individuals; (1) Doctor & (1) Nurse	Expansion of staff to increase group therapy and one-on-one therapy services within the jail	The need for additional staff is commensurate with the need of increase of space	Additional investigation is needed to determine what level of staff is needed with regard to services provided

¹⁸Statistics obtained from Exhibit 5, pages 10-16 and discussions from Work Group/Commission meetings.

Identified Item	Current State	Proposed Changes	Findings	Recommendations
<p>Program Offerings</p>	<p>Educational and Life Skills Classes Offered in Jail:</p> <p>1. <u>GED/HSE</u>- (2022)- 1 inmate graduated vs. (2019)- 9 inmates graduated</p> <p>2. <u>Parenting Skills</u>- (2021)-10 inmates utilized service</p> <p>3. <u>Resources Upon Release and Job Classes</u>: No data presented for usage</p> <p>5. <u>Anger Management</u>- (2021)-10 inmates utilized service</p>	<p>-Increased space would allow all inmates access to all programs.</p> <p>- Additional programing COULD including life skills, trade skills and other appropriate skills in “step-down” unit.</p>	<p>1. Due to current level of participation (10 inmates used services in 2021), and lack of established plan for additional programing, increased programing offerings and space is not needed at this time.</p> <p>2. Current incarceration programs require 60 day stay. As the average length of an inmate stay is less than 60 days, the increased space for services is not warranted.</p>	<p>Per the Commissioners Report:</p> <p>1. COVID-19 effected the level of participation in programs. As such, additional research on usage levels post COVID-19 is recommended</p> <p>2. Data supplied regarding added vocational programming is theoretical and not fact based. Additional research is recommended to determine programs that can be completed during incarceration</p>
<p>Mental Health Services</p>	<p>Inmate Services:</p> <p>1. Integrative Wellness;</p> <p>2. Clinical Assessment</p> <p>3. Peer Support Services</p> <p>4. Matrix Group</p> <p>5. Medication for Opioid Use Disorder</p> <p>6. Jail Chemical Addiction Program</p>	<p>Increased space will allow all inmates access to programs.</p>	<p>Due to current average length of inmate stay being less than 60 days, level of inmate participation, lack of an established plan for creating additional programing, and a perceived shift in sentencing trends to utilize community corrections, new programing space for inmate services is not needed.</p>	<p>Additional Investigation is needed to determine actual and projected need of both community based and incarcerated programs.</p>

7. **Juvenile Justice Work Group**¹⁹: The Commission reviewed the Jail Project as it relates to the requested needs for Juvenile Justice expansion and has found as follows:

Identified Item	Current State	Proposed Changes	Findings	Recommendations
<p>New proposed housing and administrative space</p>	<p>Short-term housing- range of stay from a few days up to 21 days- as determined by Court</p> <p>Not currently equipped to house juvenile offenders due to new “sight or sound” requirements posed by the State, effective July, 2021. As such, Boone County is contracting Juvenile Services to Hamilton, Johnson, and Virgo counties for 90k/year</p>	<p>New intake and juvenile facility would add 6 beds specifically for Juvenile offenders in order to comply with new “sight or sound” law requirements. Proposed addition of attorney/client meeting room, school services area, juvenile specific special beds</p>	<p>Despite the change in law, given the current and future overhaul of the Juvenile Justice System to utilize alternatives to detention through JDAI, a new juvenile facility is not needed.</p> <p>Additional investigation is warranted to determine need of bed space required for juveniles charged with major crimes and how to effectuate that need to comply with state law</p>	<p>Continue to contract with other counties to provide incarceration services for juvenile offenders. Based on the data provided, the amount of Boone County juveniles utilizing in-house jail services do not justify expanded services or space.</p> <p>Additional investigation is warranted to determine need of proposed juvenile specific attorney/client meeting room, school services area, padded cells</p>

B. COMMISSION RECOMMENDATIONS

Based upon the aforementioned findings, the Commission has made the following recommendations:

Pursuant to the investigation conducted under Indiana Code § 36-1-10-7(c)(2), the Commission recommends that that the Jail Project, *as proposed* by the County Commissioners, is **not needed**. Accordingly, the Commission further recommends that any Resolution requesting adoption of the Jail Project *as presented* by the County Commissioners **should not pass** until further evaluation and investigation can be performed to decrease the Jail Project’s construction costs and yearly operational costs to meet the current and anticipated needs of the Boone County inmate and community corrections population.

¹⁹ Statistics obtained from discussions from Work Group/Commission meetings.

IV. CONCLUSION AND NEXT STEPS

The Commission's findings will be presented to Council at their regular scheduled meeting on May 10, 2022 at 8:30 a.m.

The Council intends to meet to discuss the contents of this Report and to vote on whether to adopt this Report as prepared and recommended by the Commission. As the Report recommends denial of the Jail Project *as presented*, it is recommended that further investigation as set forth above should be conducted by the Commission pursuant to Ind. Code § 36-1-10-7(c)(2). Likewise, if the Council accepts the Commission's Report and recommendations, the Council should vote to continue the investigation for the purposes identified herein and as authorized by Indiana Code § 36-1-10-7(c)(2). The Commission should then reconvene to continue the investigation. At the conclusion of the investigation, the Council should act upon a resolution approving the lease, and then consider passing a Public Safety LIT to fund the cost of the project as determined based on the results of the investigation.

If the Council rejects the findings of this Report, and proceeds with the Jail Project *as presented* by the Commissioners, the Council should vote on whether to pass a .2% Jail Local Income Tax to fund the cost of the approximately \$60 Million Dollar Jail Project and should pass a Resolution requesting adoption of the Jail Project *as presented* by the County Commissioners.

**APPENDIX TO BOONE COUNTY JUSTICE
COMMISSION REPORT**

EXHIBIT 1

Boone County Commissioner's Resolution No. 2021-14

BOONE COUNTY BOARD OF COMMISSIONERS

RESOLUTION NO 2021-14

**A DECLARATION OF OFFICIAL INTENT
TO REIMBURSE EXPENDITURES**

WHEREAS, Boone County, Indiana ("County") intends to finance the construction of a County jail facility, including the addition of community corrections components, an infirmary and treatment areas, work release facilities, administrative and training space for the Sheriff's Office, expansion of the Communications Center, and a morgue with Coroner's offices, together with all necessary appurtenances, related improvements and equipment (collectively, "Project") pursuant to an ordinance or resolution to be adopted by the County; and

WHEREAS, the County expects to issue debt or enter into a lease financing for the Project and to use the proceeds to reimburse or pay costs of the Project;

NOW, THEREFORE, BE IT RESOLVED BY THE BOARD OF COMMISSIONERS OF BOONE COUNTY, INDIANA, THAT:

Section 1. The County hereby declares its official intent to construct the Project and to reimburse itself for all or a portion of the costs of construction of the Project with proceeds of debt to be incurred by or on behalf of the County in an amount not expected to exceed \$500,000 for purposes of paying or reimbursing costs of the Project; and to issue debt, or to approve debt issued by a leasing entity that will lease the Project to the County.

Section 2. The County reasonably expects to reimburse itself from proceeds of obligations issued by or on behalf of the County for costs of the Project paid prior to the issuance of the obligations.

Section 3. This resolution shall be effective from and after passage.

PASSED AND ADOPTED by the Board of Commissioners of Boone County, Indiana,
this 2nd day of August, 2021, by a vote of 2 ayes and 0 nays.

BOARD OF COMMISSIONERS OF BOONE
COUNTY, INDIANA

Absent
Tom Santelli, Commissioner

[Signature]
Jeff White, Commissioner

[Signature]
Donald Lawson, Commissioner

ATTEST:

[Signature]
Debbie Morton-Crum, Boone County Auditor

EXHIBIT 2

Boone County Council Resolution No. 2021-01

BOONE COUNTY COUNCIL

RESOLUTION NO. 2021-01

**A RESOLUTION ACKNOWLEDGING THE NEED FOR THE
PUBLIC SAFETY BUILDING PROJECT**

WHEREAS, a petition in six (6) counterparts containing the signatures of fifty-six (56) taxpayers of Boone County, Indiana ("County"), as certified by the County Auditor, has been filed with the Board of Commissioners of the County and this County Council regarding the acquisition, renovation and expansion of the County jail facility, including the addition of community corrections components, an infirmary and treatment areas, work release facilities, administrative and training space for the Sheriff's Office, expansion of the Communications Center, and a morgue with Coroner's Offices, together with all necessary appurtenances, related improvements and equipment (collectively, "Project");

WHEREAS, the County Council has heretofore investigated the need for the Project in the County;

NOW, THEREFORE, BE IT RESOLVED that the County Council hereby determines, after investigation, that a need exists for the acquisition, renovation and expansion of the Project and that funds needed therefor exceed the funds available to the County, and that the Board of Commissioners and the County Council proceed to take such steps as may be necessary to secure the acquisition, renovation and expansion and lease of the Project for the County as provided under IC 36-1-10 and IC 6-3.6;

BE IT FURTHER RESOLVED that the financing and the acquisition, renovation and expansion of the Project by the Boone County Building Corporation ("Corporation") and the leasing of same to the County is in the public interest of the citizens of the County and it is a

proper public purpose for which the County Council agrees to cooperate with the Corporation to assist in fulfilling the requirements of all agencies of the federal, state and county government.

Dated this 10th day of August, 2021.

BOONE COUNTY COUNCIL

Elise Nieshalla, Presiding Officer

Jennifer Hostetter

Don Lamb

Aaron Williams

John Riner

Kevin Van Horn

Marcia Wilhoite

ATTEST:

Debbie Morton-Crum, Boone County Auditor

EXHIBIT 3

Materials Presented at a Town Hall Meeting held by Boone County Commissioners on October 28, 2021 that relates to the Jail Project

Boone County Board of Commissioners Town Hall Meeting

10/28/2021



BOONE COUNTY, IN
GOVERNMENT



BOONE COUNTY, IN
SHERIFF'S OFFICE

Boone County Justice Center Update

The Agenda

- Introductions
- Opening Comments
- Update on Current Process
- Review of DLZ Feasibility Study Highlights
- Review of Current Programming
- Schedule, Budget / Funding Review
- Questions / Discussion

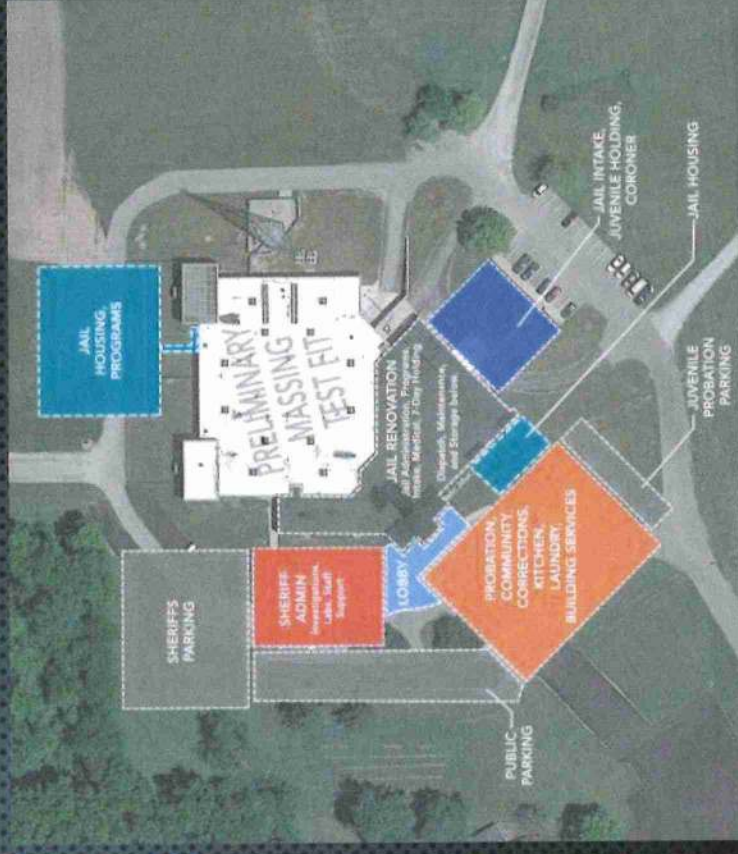

Boone County Justice Center – Preliminary Plan

Introductions & Opening Comments

- Introductions
 - Commissioners / Sheriff
 - GM Development Team
- Opening Comments
 - Tom Santelli – President Boone County Commissioners
 - Jeff Wolfe – Vice President Boone County Commissioners
 - Mike Nielsen – Boone County Sheriff
 - Michael Nance – Director Community Corrections
 - Justin Sparks – Boone County Coroner
 - Diane Huddleston – Director of Comprehensive Services – Boone & Hamilton Counties, Aspire Indiana
 - Impact / Success

Update on Current Process

- Feasibility Study #1
 - Sheriff's Office and Jail Feasibility Study #2
 - RFP/Q for BOT and Development Team Selection (IC 5-23)
 - Design Process
-
- Completed ~ 2015
 - Completed March 28, 2020
Year 2040 plan
 - Interviews Completed on 7/20/21 – GM Development Selected
 - Completed 8 Programming and Design Workshop Sessions ~ 56 hours + Design and Estimating

Review of DLZ Feasibility Study Highlights

- Sheriff's Office and Jail Feasibility Study Completed March 28, 2020
- Findings
 - Abundant ADA Non-Compliance Throughout the Facility
 - Space Needs Identified in all areas (Housing, Intake, Medical, Administration, Investigations, Programming)
 - Structure Designed to accommodate 110 beds. In 2007 the occupancy increased to 214 (double bunked)
 - Not covered in the DLZ report are space needs within Community Corrections, Probation, and Coroner's Office
 - No ability to classify Inmate population due to Jail housing at / near full capacity

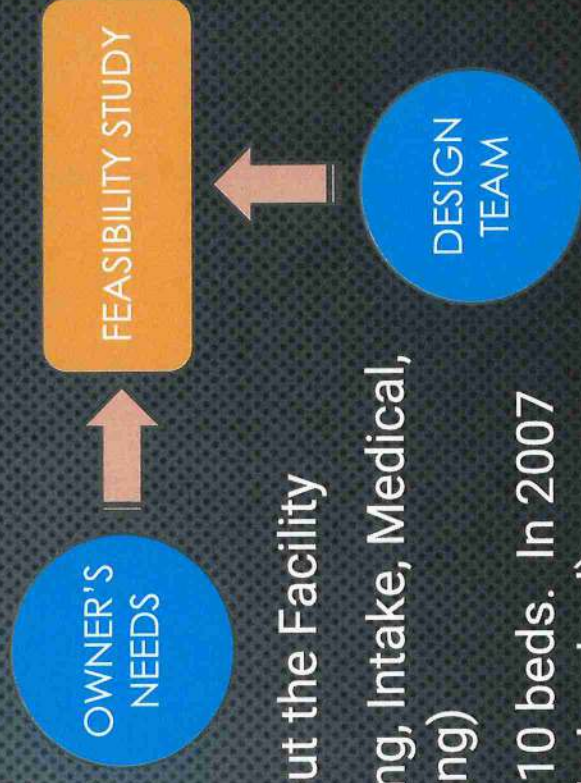

Review of DLZ Feasibility Study Highlights

TOTAL COUNTY POPULATION

	CO POP (X 1000)	COUNTY	YR BUILT/ RENOV	GEN POP BEDS	TOTAL RATED BEDS REPORTED	BEDS PER 1000 POP	INMATES PER 1000 POP	% OF BEDS FILLED	TOTAL INMATES	AVAIL BEDS
16	110.0	LaPorte	6/26/1905	368	368	3.35	3.71	111%	408	-40
17	107.4	VIGO	2001	267	267	2.49	2.68	117%	288	-21
18	82.8	BARTHOLOMEW	2009	366	366	4.42	2.71	61%	224	142
19	82.4	HOWARD	1991	364	364	4.42	5.66	128%	466	-102
20	79.3	KOSCIUSKO	2003	302	302	3.81	3.92	103%	311	-9
21	77.4	HANCOCK	1988	157	157	2.03	2.97	146%	230	-73
22	77.0	FLOYD	1994	234	234	3.04	3.77	124%	290	-56
23	70.1	MORGAN	2013	439	439	6.26	3.45	55%	242	197
24	67.0	BOONE	1992	214	214	3.19	2.82	88%	189	25
25	66.0	GRANT	1990	274	274	4.15	4.32	104%	285	-11
26	66.0	WAYNE	2004	416	416	6.30	4.73	85%	312	104
27	62.6	WARRICK	1989	127	127	2.03	1.41	69%	88	39



Information provided by the Indiana DOC 2019 Jail Report

Review of DLZ Feasibility Study Highlights

YEAR 2040 PLAN PROJECTED JAIL BEDS

- Currently 214 Rated Beds per current Indiana DOC Report
- Projections do not include a 20% classification factor

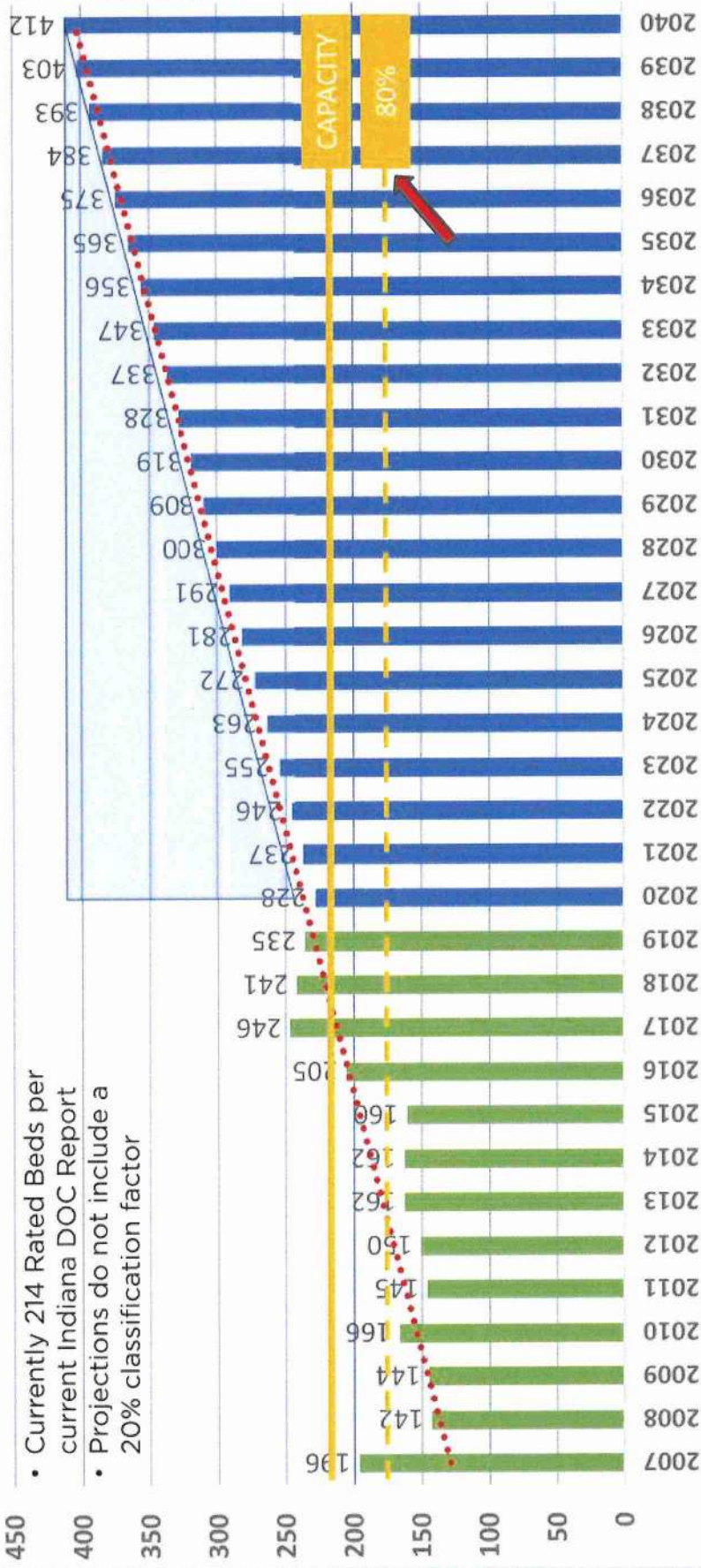

Review of DLZ Feasibility Study Highlights

OBJECTIVE CLASSIFICATION: 80% RULE and GROWTH POTENTIAL

NIC
National Institute of Corrections
U. S. Department of Justice

**Objective Jail
Classification Systems:
A Guide for Jail
Administrators**

80% rule: Difficult to classify and to separate prey from predator in overcrowded jails.

Safety and Security of Inmates and Staff

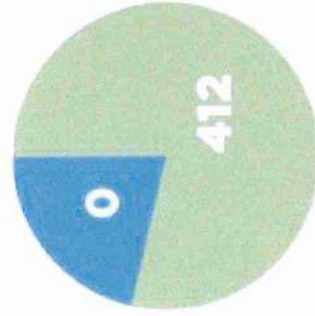

412
RATED BEDS

Limits objective classification recommendations

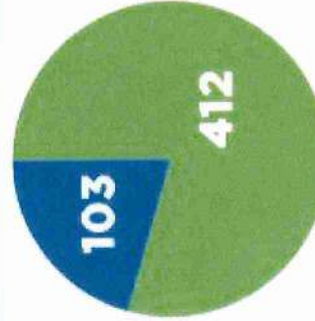

515
RATED BEDS

Meets Year 2040 projections with 20% classification

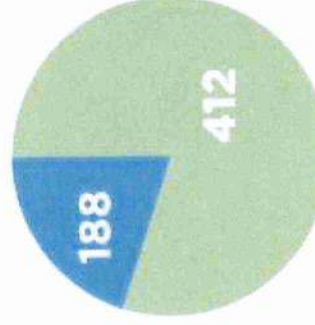

600
RATED BEDS

Provides additional growth above Year 2040 Projections

PROPOSED PROGRAM SPACES

- 214 rated beds per current Indiana DOC Report
- Expansion of 301 rated beds to meet Year 2040 jail capacity projections
- New beds as follows:

192 RATED GENERAL POPULATION BEDS
144 male beds 48 female beds

2 and 4 bed cells
Dorm style
Transitional

77 RATED SPECIAL NEEDS BEDS
53 male beds 24 female beds

Medical
Mental Health
Behavioral Management
Special Custody

32 RATED SEGREGATION BEDS
24 male beds 8 female beds

Single bed cells



Actual Proposed Spaces

Recommendation from Feasibility Study = **301 Rate Beds** within the Jail

192 RATED GENERAL POPULATION BEDS	77 RATED SPECIAL NEEDS BEDS	32 RATED SEGREGATION BEDS
144 male beds 48 female beds	53 male beds 24 female beds	24 male beds 8 female beds
2 and 4 bed cells Dorm style Transitional	Medical Mental Health Behavioral Management Special Custody	Single bed cells

Actual Proposed Expansion of **202 rated beds** that meets the VISION and GOAL of the project – Focus on Mental Health and Rehabilitation

Addition of 102
Rated beds

Transitional / Dorm
Style & Segregation

Addition of 30 Rated
Beds Dorm Style off
Intake

Addition of 70 beds
in Community
Corrections / Work
Release

Review of Current Programming

- **Visioning, Project Goals and Expectations Determined**
 - Need for Expansion
 - Focus to be on Mental Health and Rehabilitation
 - Increased focus on Community Corrections, Work Release and Training vs Incarceration
 - Creating a Collaborative and Efficient Environment between the County Jail and Other Justice Departments
- Programming & Planning along with Schematic Design in Process

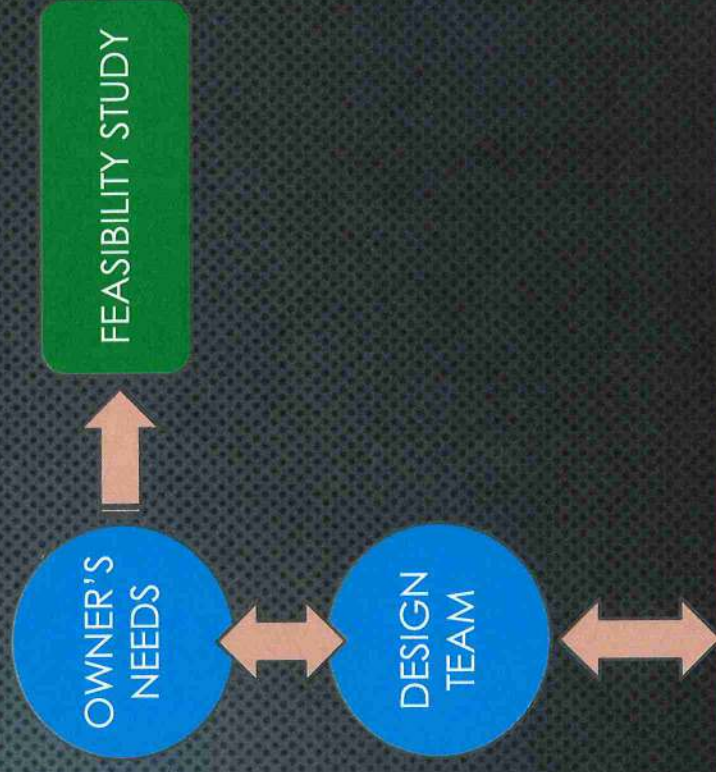

VISIONING
PROJECT GOALS
EXPECTATIONS

PROGRAMMING
&
PLANNING

SCHEMATIC
DESIGN

DESIGN
DEVELOPMENT

Construction
Documents

Review of Current Programming

PRELIMINARY BUILDING GROSS SQUARE FEET (BGSF)
 AREAS BASED UPON CURRENT AND PROPOSED FUTURE USE
 ACTUAL AREAS MAY VARY

SUMMARY	
Area Name	BGSF
1.000 SHERIFFS ADMINISTRATION	9,254
2.000 INVESTIGATIONS / LAB	4,978
3.000 DISPATCH	2,141
4.000 JAIL ADMINISTRATION, STAFF SUPPORT AND CONTROL	1,642
5.000 INTAKE	9,922
6.000 MEDICAL	2,874
7.000 PROGRAM SERVICES	9,145
8.000 HOUSING	
8.000 HOUSING SHELL	31,087
9.000 FOOD SERVICE	4,453
10.000 LAUNDRY	428
11.000 MAINTENANCE, BUILDING SERVICES, STORAGE	2,470
12.000 PROBATION AND COMMUNITY CORRECTIONS	13,174
13.000 COMMUNITY CORRECTIONS	18,163
14.000 CORONER	3,071
TOTAL	112,801

PRELIMINARY
 NOT FOR CONSTRUCTION
 ACTUAL DESIGN MAY VARY

Preliminary Summary Table only

Schematic Site Plan

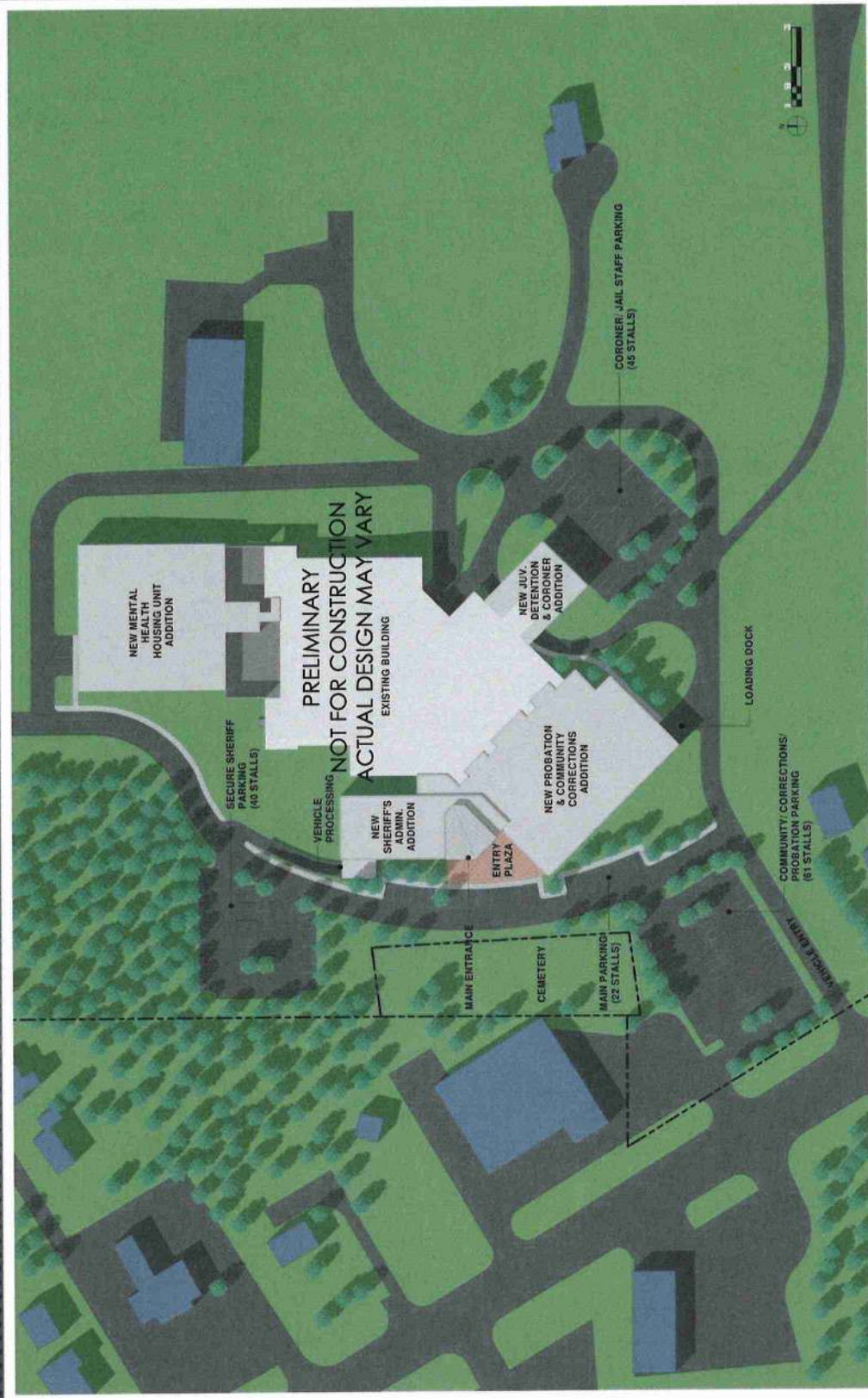

Overall First Floor Plan

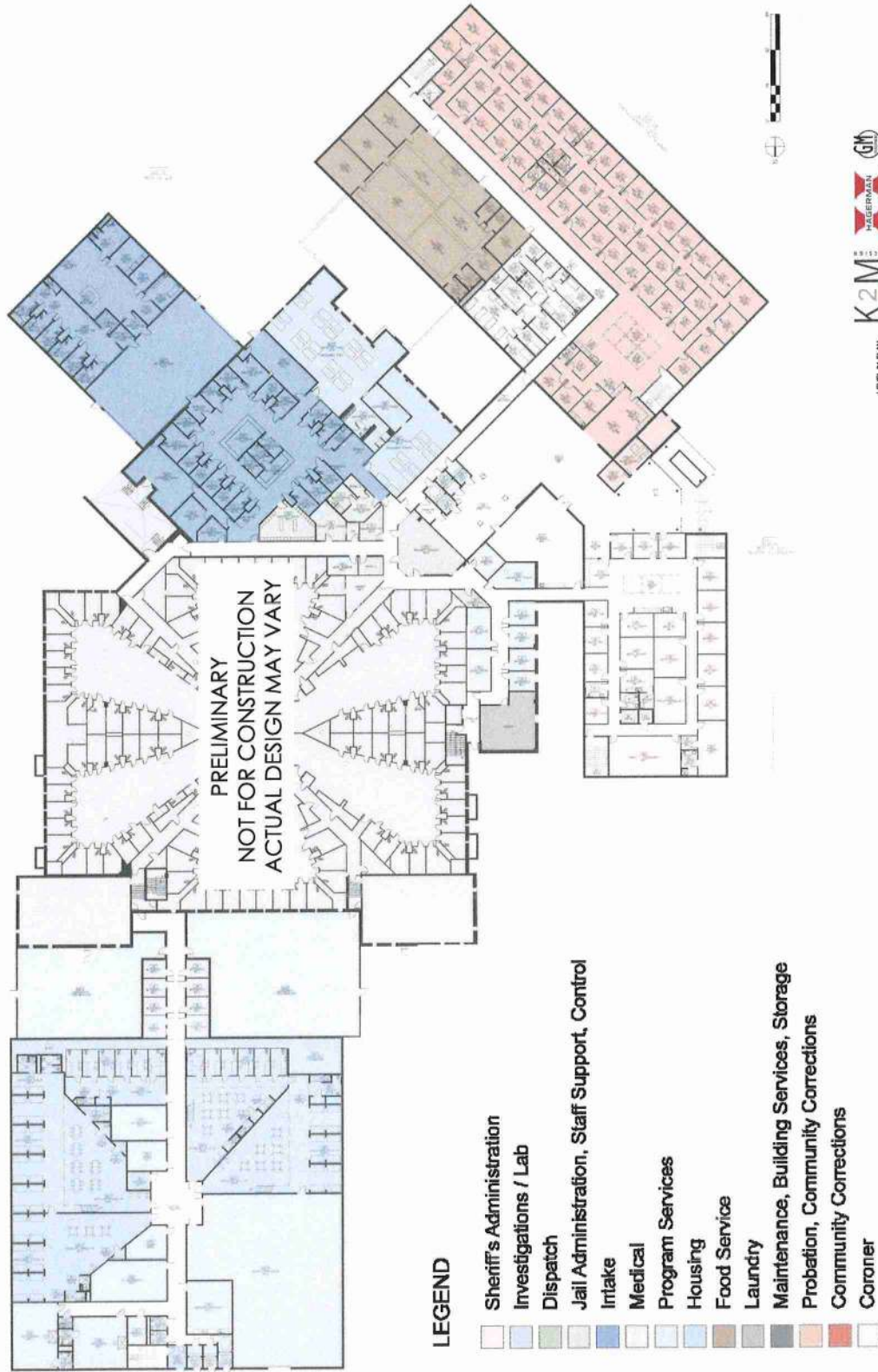

Overall Lower Level Plan



LEGEND

- Sheriff's Administration
- Investigations / Lab
- Dispatch
- Jail Administration, Staff Support, Control
- Intake
- Medical
- Program Services
- Housing
- Food Service
- Laundry
- Maintenance, Building Services, Storage
- Probation, Community Corrections
- Community Corrections
- Coroner

Schedule / Budget Update

Anticipated Schedule:

- Q4 – 2021
 - Complete Schematic Design (currently in process)
 - Budget Finalized
 - Design Development Commences
 - Pending Funding Approval by County Council
 - County adopts approving resolution to enter into BOT agreement and related documents
 - Close on Financing
- Q3 - 2022
 - Design complete
 - Developer begins permitting / submittal process
 - Construction begins
- Q4 – 2023
 - Construction Completed

Boone County Board of Commissioners Town Hall Meeting

10/28/2021



BOONE COUNTY, IN
GOVERNMENT



BOONE COUNTY, IN
SHERIFF'S OFFICE

Questions

EXHIBIT 4

2022 Indiana Department of Corrections Jail Inspection Report

Date:

Sheriff :

County:

City:

IN

Zip:



RE: Jail Inspection Report

Dear Sheriff:

Attached is a copy of our recent inspection of the county jail. For a detailed explanation of each jail standard, please refer to 210 IAC 3.

Observations and recommendations are noted in the right column of the report. General comments, not outlined elsewhere within the report, may be found at the conclusion of the report.

We trust this report will be helpful to you. Please feel free to call us at (317) 233-4787 if you have any questions concerning this report.

Respectfully,

Kenneth Whipker
Director, Sheriff & County Jail Operations Division

cc: Judge of the Circuit Court
All Judges having adult or juvenile jurisdiction within the county
Board of County Commissioners
County Prosecutor
IDOC



**COUNTY JAIL SERVICES DIVISION
INDIANA DEPARTMENT OF CORRECTION
JAIL INSPECTION REPORT**

COUNTY: **Boone**
 DATE OF INSPECTION: **1/20/2022**
 COUNTY NUMBER: **6**
 JAIL STREET ADDRESS: **1905 Indianapolis Avenue**
 CITY: **Lebanon**
 ZIP: **46052**
 SHERIFF: **Michael T. Nielsen**
 YEAR OF OFFICE (including prior terms): **8th Year, 2nd Term**
 PHONE: **(765) 482-1412**
 FAX: **(765) 483-3370**
 E-MAIL: **mnielsen@co.boone.in.us**

CIRCUIT COURT JUDGE: **Lori Schein**
lschein@co.boone.in.us

SUPERIOR COURT JUDGE: **Matthew Kincaid**
mkincaid@co.boone.in.us

COUNTY COMMISSIONERS: **Thomas Santelli**
tsantelli@co.boone.in.us

COUNTY COMMISSIONERS: **Jeff Wolfe**
jwolfe@co.boone.in.us

COUNTY COMMISSIONERS: **Don Lawson**
dlawson@co.boone.in.us

COUNTY PROSECUTOR: **Kent Eastwood**
keastwood@co.boone.in.us

YEAR JAIL BUILT/YEAR(S) ADDED OR RENOVATED: **1992**

DEATHS SINCE LAST INSPECTION:	0 Natural
	0 Suicide
	0 Homicide

ESCAPES SINCE LAST INSPECTION:	0 From the jail
	0 From custody
	0 Walk-away/did not return

Administration and Organization	Remarks
---------------------------------	---------

1. Is there an Jail Administrator/Commander?	Yes	Captain Tim Turner (765) 483-5782 tturner@co.boone.in.us
1a. Telephone Number:		
1b. E-mail address:		
1c. Is there an Assistant Jail Commander?	No	
1d. E-mail address:		
1e. Telephone Number:		

2. Was there an annual report of services prepared? **Yes**
3. Is there a manual of policies and procedures? **Yes**
 3a. Has it been reviewed by all employees? **Yes**
4. Has it been reviewed and updated in the last year by the sheriff or his/her designee? **Yes**
 4a. Date of review: November 2019 (on- going w/ Lexipol)
 4b. Reviewed by: Sheriff
 4c. Liability Insurance Carrier: The Travelers Insurance

Fiscal Management	Remarks
-------------------	---------

5. Is there a written procedure for the handling of monies? **Yes**
6. Is there a written jail cost record? **Yes**
7. Have you had a State Board of Accounts audit? **Yes**
8. Is there a written budget request prepared by the Sheriff? **Yes**
9. Is there a written inventory of county jail property? **Yes**

Training and Staff Development	Remarks
--------------------------------	---------

10. Is there a written training and staff development plan? **Yes**
 10a. Date of annual evaluation and revision: November 2021 (on- going w/ Corrections
 10b. Reviewed by: Sheriff One)
11. Has each new jail officer received eighty (80) hours of orientation and training, at the jail, prior to job assignment? **Yes**
12. Has each new jail officer received forty (40) hours of certified training through the Law Enforcement Training Board during their first year of employment? **Yes** Three (3) new hires to complete certified training within year of hire date
13. Has each jail officer received sixteen (16) hours of documented training this year and the Jail Commander twenty-four (24) hours of training for those subjects outlined in the **Yes**
14. Has each authorized employee been trained and qualified in the past year with weapons? **Yes**
 14a. Is this training documented? **Yes**
15. Has every employee authorized to use a weapon been trained in the use of deadly force? **Yes**
16. Did you request a training allowance in your budget? **Yes**
 16a. Was it approved? **Yes** If no, why not?

Management Information Systems and Inmate Records	Remarks
---	---------

- 17. Does the intake form contain all the required information? **Yes**
- 18. Are there proper records maintained on all inmates? **Yes**
- 19. Are population movement records properly maintained? **Yes**
- 20. Is there a written policy concerning jail incident reports? **Yes**
- 21. Is there a written policy regarding inmate records privacy? **Yes**
- 22. Is the inmate's medical record separate from the confinement record? **Yes**

Physical Plant	Remarks
-----------------------	----------------

- | | |
|--|----------------------------|
| 23. Is there a written plan for preventative maintenance? | Yes |
| 24. Is it reviewed and/or updated annually? | Yes |
| 25. Is there twenty (20) foot candles of light at desk level throughout the cell blocks at the time of inspection? | Yes 47.7 - 61.1 f/c |
| 26. What was the cubic feet per minute of air flow movement on the day of inspection? | 352.9 - 688.4 c/f/m |
| 27. The noise level decibels at the time of inspection was: | 64.7 - 68.7 dBA |
| 28. The temperature at the time of inspection was: | 69-71 degrees Fahrenheit. |
| 29. Was the clothing and bedding adequate for the prevailing temperature? | Yes |
| 30. Was there both hot and cold running water in each cell at the time of inspection? | Yes |
| 31. Is there one toilet and one shower for twelve (12) inmates in the activity area? | Yes |
| 32. Is the inmate receiving and booking area outside the inmate living area? | Yes |
| 33. Is the inmate receiving and booking area inside the secured perimeter? | Yes |
| 34. Does this area have proper weapons lockers outside of the secured perimeter? | Yes |
| 35. Does it have proper temporary holding space? | Yes |

36. Are there fixed benches in ample supply for its capacity? **Yes**
37. Is there audio and visual communication in the temporary holding area? **Yes**
38. Are there available toilets, washbasins with hot and cold running water in the temporary holding area? **Yes**
39. Is there a booking area in the reception area? **Yes**
40. Is there a medical examination area in the reception area? **Yes**
41. Are there shower facilities in the reception area? **Yes**
42. Is there secure storage for the inmate's personal property in the reception area? **Yes**
43. Are there telephone facilities in the reception area? **Yes**
44. Are supply areas separate from inmate living and activity areas? **Yes**
45. Is there adequate secure storage space for all supplies and equipment? **Yes**
46. Are arsenals located outside the security perimeter of the inmate living and activity areas? **Yes**
47. Is there an area for inmates under special medical supervision? **Yes**
48. Is there a special area for temporary detention of inmates under the influence of alcohol? **Yes**
49. Is there a special area for temporary detention of inmates that are violent, uncontrollable or self-destructive? **Yes**
50. Are the above two (2) areas equipped with audio-video monitoring? **Yes**
- 50a. Do inmates have access to a toilet and running water? **Yes**
51. Is there a bed for all incarcerated inmates? **Yes**
52. Total number of operational jail beds (elevated at least 12 inches off the floor and permanently installed) . **214**
53. Number of adult males incarcerated. **114**
a.) Average male inmate monthly population? **124**
54. Number of adult females incarcerated? **24**
a.) Average female inmate monthly population? **23**

55. Number of waived males less than 18 years old? **0**
56. Number of waived females less than 18 years old? **0**
57. Total inmate count on inspection day. **148**
- 57a. Total inmates housed out of county **10**
- 57b. Average inmate daily population **148**
58. Number of inmates sentenced to serve county time? **13**
- 58a. How many of these are sentenced to a work release program? **0** Due to Covid 19
59. Is this an IDOC Holding Jail? **No**
- 59a. Total number of beds identified for IDOC holding. **N/A**
60. Number of inmates being held for IDOC? **20** L6 Inmates
- 60a. Annual average number of Level 6 inmates **14**
61. Number of sentenced inmates awaiting transfer to IDOC? **9**
62. Number of inmates being held for the US Marshal or I.C.E? **2**
63. Number of military prisoners? **0**

Commissary	Remarks
------------	---------

64. Did the State Board of Accounts approve your commissary policy? **Yes**
65. Is Commissary under supervision of the jail administrator or contractor? **Yes** Sgt. Ford (jail administrator)

Safety and Sanitation	Remarks
-----------------------	---------

66. Is cleaning equipment available to inmates daily? **Yes**
67. Is the jail inspected weekly by a designated official? **Yes**
68. Are written inspection reports maintained? **Yes**
69. Are insect and rodent inspections made weekly? **Yes** Contract with T- Rex Extermination
70. Is there a licensed exterminator contract? **Yes**
71. Are plumbing fixtures functional? **Yes**
72. Are faulty plumbing fixtures repaired promptly? **Yes**
73. Are exits clearly marked, illuminated continuously and clear? **Yes**
74. Is there a written evacuation plan for emergencies? **Yes**

75. Are evacuation instructions in all living and working areas? **Yes**

75a. Is there documented quarterly fire evacuation drills? **Yes**

76. Has the Sheriff requested the Board of Health to inspect the jail annually? **Yes**

77. Has the Board of Health inspected the jail annually? **Yes** *Kitchen area only*

77a. Has the Sheriff requested the state fire marshal to inspect the jail annually? **Yes** *Lebanon Fire Department conducted annual inspection on 1/07/2022*

77b. Has the state fire marshal inspected the jail annually? **Yes** *IDHS completed inspection on 1/08/2022*

78. Is there a written policy concerning safety, sanitation and supply control? **Yes**

Clothing and Personal Hygiene		Remarks
--------------------------------------	--	----------------

79. Are suitable clothing, bedding and towels provided for the total inmate population? **Yes**

80. Are all inmates provided with shaving materials, bar soap, **Yes**

toothpaste and toothbrush?

81. Do inmates shower upon admission to general population? **Yes**

82. Are inmates afforded the opportunity to shower at least **Yes**
three (3) times within every seven (7) days?

83. Are haircuts available, upon request, at least every six (6) **Yes**
weeks?

84. May inmates wear personal clothing to their trials? **Yes**

Medical Care and Health Services & Suicide Prevention		Remarks
--	--	----------------

85. Is there a licensed physician responsible for medical screening and qualified for suicide screening and prevention services at the jail? **Yes** *Quality Correctional Care provides 24 hour and 7 days a week medical care*

86. Are there written procedures for medical service delivery to inmates? **Yes**

87. Are these procedures approved by a physician? **Yes**

88. Are health care personnel licenses or certification on file with the Sheriff? **Yes**

89. Do jail security regulations apply to medical personnel? **Yes**

90. Are there adequate space, equipment, supplies and materials for medical services available?	No	3-1-11: (d) adequate space; (medical examination area)
91. Are first aid kits available at the jail?	Yes	
92. Are first-aid kits inspected and refilled according to the responsible physician that is contracted by your jail?	Yes	
93. Are inmates medically screened upon admission?	Yes	
94. Has the doctor approved the medical screening form?	Yes	
95. Are all inmates in jail given a medical examination within fourteen (14) days?	Yes	
96. Is this medical examination given by a physician or his designee?	Yes	
97. Are inmates medical complaints collected daily?	Yes	
98. Are medical and mental health complaints responded to by medically and mental health trained personnel?	Yes	
99. Is there a physician available at least weekly to respond to medical complaints?	Yes	
100. Is twenty-four (24) hour emergency medical, dental care and psychiatric care available pursuant to a written plan and contract?	Yes	
101. Is there a written emergency medical plan?	Yes	
101a. Emergency evacuation of inmates	Yes	
101b. Use of an emergency medical vehicle	Yes	
101c. Use of one or more designated hospital emergency rooms or appropriate health facilities	Yes	Witham hospital
101d. Emergency On-call physicians and dentists services when the emergency health facility is not located in a near by community.	Yes	
101e. Security procedures that provide for the immediate transfer of inmates when appropriate.	Yes	
101f. Arrangements for emergency psychological services.	Yes	Quality Correctional Care provides mental health care 20-30 hours a week
102. Are all jail personnel first aid trained?	Yes	
103. Is one (1) person per shift trained in receiving screening?	Yes	
104. Is one (1) person per shift trained in CPR and/or AED?	Yes	
105. Is one (1) person per shift trained in common symptom recognition?	Yes	

106. Is one (1) person per shift trained to recognize symptoms of mental illness or retardation? **Yes**
107. Does jail refuse acceptance of an unconscious or critically injured person? **Yes**
- 107a. What is your BAC/BrAC cut off level for booking refusal? **Yes** 0.25% B.A.C
108. Are all injured inmates examined immediately by competent medical personnel? **Yes**
109. Is a written description of the injury prepared? **Yes**
110. Are photographs taken of the injury? **Yes**
111. Are prescribed medications given as per physician orders? **Yes**
112. Are all persons administering medication trained by the responsible physician? **Yes**
113. Are records of medication administered kept? **Yes**
114. Did the physician approve the record form? **Yes**
115. Is chronic care, convalescent care and medical preventive maintenance provided? **Yes**
116. Did the inmate medical file contain all information approved by a responsible physician? **Yes**
117. Is access to inmate medical records controlled by the responsible physician? **Yes**

Diet and Food Preparation		Remarks
118. Has the Sheriff established written policies and procedures concerning food, quantity and quality?	Yes	
119. Is discipline by means other than denial of food?	Yes	
120. Are meals served under supervision of the jail administrator or his designee?	Yes	Trinity Foodservices began operations in November 2021
121. Is there always less than fourteen (14) hours between meals?	Yes	
122. Do inmates receive three (3) meals a day?	Yes	
123. Is at least one (1) meal each day cooked?	Yes	

124. Are menus prepared in advance? **Yes**
125. Are records retained of meals served? **Yes**
126. Have the meals been approved by a qualified dietician and reviewed every 2 years? **Yes** *Laurie LeClair, RD, LD approved facility menu on 12/24/2021*
127. Are all food service areas and equipment inspected daily by administrative jail personnel? **Yes**
128. Is all stored food placed on racks off the floor? **Yes**
129. Is food covered while being transported to the inmate? **Yes**
130. Is the kitchen floor cleaned daily? **Yes**
131. Is the kitchen equipment cleaned daily? **Yes**
132. Are walls and vents clean? **Yes**
133. Has the jail administrator requested the local Board of Health officer to inspect the kitchen facilities? **Yes** *Boone Co Health Department conducted annual inspection on October 13, 2021*
134. Does the local health officer or other qualified agency inspect it annually? **Yes**
135. Are eating utensils sanitized after each use? **Yes**
136. Is kitchen equipment operational? **Yes**
137. Do you use inmates in the kitchen? **Yes**
138. Do kitchen inmates receive pre-service medical examinations? **Yes**
139. Do kitchen inmates receive daily visual examinations? **Yes**
140. Do kitchen inmates wear approved clothing for food handling? **Yes**
141. Are medical diets served when approved by the responsible physicians? **Yes**
142. Are religious diets served when accessible and authorized by the sheriff? **Yes**

143. Has the sheriff established, in writing, a control system to monitor and control food pilferage, misuse or spoilage? **Yes**

Security and Control	Remarks
-----------------------------	----------------

144. Is there an established manual of policies for security and control? **Yes**

145. Is it accessible and reviewed by all jail personnel? **Yes**

146. Is it reviewed and updated annually and documentation provided? **Yes**

147. Have jail officers been trained consistent with the manual? **Yes**

148. Have pre and post training exams been administered? **Yes**

149. Have the results been made a part of the employee's records? **Yes**

150. Is there an extra set of jail keys securely stored? **Yes**

150a. Are security doors & security locks repaired promptly? **Yes**

150b. Are security doors and security locks functional? **Yes**

151. Are written reports prepared when a weapon is discharged by jail personnel? **Yes**

152. Are weapons restricted from designated areas? **Yes**

153. Do you use Oleoresin Capsicum (O.C.) and/or Taser? **Yes** Taser

154. Is there a list of persons authorized to use Oleoresin Capsicum (O.C.) and/or Taser? **Yes** Taser

155. Have they been trained in its usage? **Yes**

156. If a person is injured by a chemical agent, does he receive an immediate medical examination? **Yes**

157. Is there a communication control center? **Yes**

157a. Was it secured? **Yes**

158. Is there an audio communication system between the control center and the inmate living area? **Yes**

159. Is there an emergency generator? **Yes**
160. Is it functional? **Yes**
161. Is it tested weekly? **Yes**
 161a. What day is it tested? Monday, 0900
162. Is security equipment sufficient to meet facility needs and stored in a secure readily accessible area? **Yes**
163. Are all doors on security perimeters kept locked? **Yes**
164. Do you prohibit a jail officer from entering a high security cell area without a back-up? **Yes**
165. Are contraband searches held? **Yes**
166. Are written reports made of items confiscated? **Yes**
167. Are inmates informed of their authorized articles? **Yes**
168. Are contact visitors and inmates searched? **N/A** Non- contact visit only
169. Are all inmates searched before leaving or returning to the jail? **Yes**
170. Is there a written policy concerning contraband, searches and seizures? **Yes**

Supervision of Inmates	Remarks
------------------------	---------

171. Is there sufficient jail personnel present in the jail to provide adequate 24 hour supervision of inmates? ***See Comment Section***
 171a. How was your number of sufficient jail personnel established? *Data-Driven Staffing Analysis conducted by Jail Services in 12/2013*
172. Is there personal observation of the inmate at least every sixty(60) minutes during lockdown hours at night? **Yes**
173. Is this observation documented? **Yes**
174. Is there written policy on male-female supervision by male-female staff? **Yes**
175. Are privacy rights considered in this policy? **Yes**
176. Are there written policies for segregation of inmates? **Yes**
- 177a. Do jail officials review the status of the inmate at least once every seven (7) days. **Yes**
- 177b. Does time spent confined or separated from the general population before determination of guilt credit toward **Yes**

177c. Does the disciplinary segregation period exceed thirty (30) day for any single instance of disciplined conduct without review? **Yes**

177d. Do jail officials maintain a permanent written record of activity in segregation areas? **Yes**

178. Is each area of the jail visited by the Sheriff or his designee at least once weekly? **Yes**

179. Is each area of the jail visited by supervisory staff daily? **Yes**

180. Are these visits documented? **Yes**

181. Are inmates prevented from supervising or exerting control or assuming any authority over other inmates? **Yes**

Inmate Rights	Remarks
---------------	---------

182. Do inmates have access to courts? **Yes**

183. Do inmates have confidential access to attorneys? **Yes**

184. Do inmates have reasonable access to an adequate law library, if operating pro se? **Yes** Inmates can access law library by laptop usage and tablets are being purchased in the near future.

185. Are all forms of discrimination of inmates forbidden? **Yes**

186. Do inmates have access to reading material (not pornography)? **Yes**

187. Do inmates have religious freedom where security is not broken? **Yes**

188. Is physical exercise available indoor? **Yes**

189. Is physical exercise available outdoor? **Yes**

190. Is refusal of recreation documented? **Yes**

191. Do you provide a list of all inmates, sentenced and incarcerated, to the county clerk quarterly, as required by IC 3-7-46-6? **Yes**

192. Is there a written inmate work assignment record? **Yes**

193. Is there a written grievance policy and procedure? **Yes**

194. Is it distributed to the inmates? **Yes**

195. Is there a written jail visitation policy and procedure? **Yes**

196. Is there a written jail telephone policy and procedure for inmates? **Yes**

197. Is there jail visitor registration? **Yes**

Mail		Remarks
-------------	--	----------------

198. Is there a written procedure governing inmate correspondence? **Yes**

199. Is mail unlimited in volume? **Yes**

200. May inmates correspond within the jail by mail? **Yes**

201. Do you forbid the opening or censoring of mail for government officials, courts, attorneys or news media? **Yes**

202. If mail is delayed, censored, or withheld, is the inmate given prompt notice? **Yes**

203. Is there a written record of this action? **Yes**

204. Are indigent inmates provided free writing supplies? **Yes**

Discipline		Remarks
-------------------	--	----------------

205. Are there written rules of inmate conduct? **Yes**

206. Do they describe disciplinary actions to be taken? **Yes**

207. Do they describe the procedure to be followed? **Yes**

208. Are copies of rules distributed to inmates or posted in the living areas? **Yes**

209. Do you prohibit the use of physical force as a discipline? **Yes**

210. Have personnel been trained as to inmate rules of conduct? **Yes**

211. Have personnel been trained as to sanctions available? **Yes**

212. Are all disciplinary standards met? **Yes**

213. Are disciplinary hearings provided for and held? **Yes**

214. Are these consistent with the standards? **Yes**

215. Are there provisions for an appeal? **Yes**

Classification		Remarks
-----------------------	--	----------------

216. Is there a written plan for classification of inmates? **Yes**

217. Are inmates with contagious diseases separated? **Yes**

218. Are intoxicated inmates segregated? **Yes**

219. Are inmates experiencing drug withdrawal segregated? **Yes**

220. Are inmates experiencing mental conditions segregated? **Yes**

Reception, Orientation. Property Control and Release		Remarks
---	--	----------------

221. Are there written procedures governing reception and orientation? **Yes**

222. Is the inmate's personal property inventoried and securely stored? **Yes**

223. Is the inmate's money securely stored? **Yes**

224. Does the inmate sign for his property upon release? **Yes**

Jail Program Survey		
----------------------------	--	--

Have arrangements been made for the provision of special education services as needed? **Yes**

Does the jail provide GED or TASC services? **Yes** 3 - 6 month time cuts being offer to inmates for completing GED/TASC program

Does the jail provide any substance abuse counseling services in the jail? **Yes**

Is smoking or tobacco based products within the jail prohibited? **Yes**

Does the county have a Community Corrections program? **Yes**

Is the Community Corrections program on the same grounds as the jail **Yes**

Is the Community Corrections program under the supervision of the Sheriff, County Judges or Contracted?

Other programs? Life Skills classes which includes parenting resources upon release, Job class, Anger Mangement/Transformation

COMMENTS SECTION

All essential posts are staffed daily authorize by the Jail Commander. Control room post is occupied 24/7. Jail officers are completing & documenting required visual checks every 60minutes. Jail had zero deaths or escapes since last inspection report.

Accompanied by:
Mike Nielsen, Sheriff

Anthony Harris - Chief Deputy
Tim Turner - Captain (Jail Commander)
Susan Kinney- Sergeant (Jail Administrator)

Inspected by:
Chance Sweat

County Jail Services Division
Division Director
Indiana Dept. of Correction
Phone: (317) 232-5764
csweat@idoc.IN.gov

Yes
No
N/A

EXHIBIT 5

Boone County Justice Commission Workgroup Questionnaire

Questions posed by Boone County Justice Commission

Answers provided by: Boone County Commissioners Lawson, Santelli, and Wolf;
David Rainey-The Veridus Group

Boone County Justice Commission Workgroup

The Boone County Justice Commission has been meeting with various workgroups to determine the need for the proposed jail expansion. Below is a summary of initial questions from those meetings. Please be thorough and detailed in your answers and explanations. If you need further clarity on any question, please let Councilman Aaron Williams know.

Future Jail Growth

- 1) The graph used in the report to explain the jail expansion uses a 45-degree projection of estimated bed needs, although the last four years overall population has decreased each year. How were the numbers derived and the datasource?

See answer below on jail population answer to question one, the average monthly population graph and also the highest daily population graph below. This clearly shows the jail population started to increase; the only decrease has been in 2020 & 2021 due to COVID-19. We feel that we would have continued to see a significant increase had COVID not impacted us.

- 2) How many jail beds do we currently have? How many jail beds are being added?

Answer: There are currently 214 rated beds per current Indiana DOC Report (See page 63 of the feasibility study). This count includes the 184 in general population housing / 15 beds in Holding and 15 beds in Community Corrections - Work Release. The feasibility study was focused on incarnation and proposed an increase in beds to an additional 301 rated beds (all secured housing).

- *The proposed expansion is focused on mental health and rehabilitation as well as community corrections / work release.*
- *The proposed expansion consists of an initial expansion with the ability to add additional beds to serve future needs. These expansions consist of the following areas:*

- *Secured Jail – Initial Expansion:*

- *24 Male General Population*
- *24 Male Metal Health*
- *12 Female Mental Health*
- *36 Female Mental Health*
- *6 Female Segregation*

- *Total Initial Expansion of 102 bed expansion*

- *Future expansion of up to 48 beds to 150 beds*

- *Community Corrections – Initial Expansion:*

- *58 Male beds*
- *24 Female beds*

- *Total Initial Expansion Community Corrections of 82 Beds*

- *Future expansion of 38 male beds to 96 beds*

- *Future expansion of 24 female beds to 48 beds*

- *Total build out is 144 beds*

- *Overall Initial expansion of 184 beds*

- *Future Expansion up to total of 294*
- *total beds*

- 3) What is the current cost per day to house an inmate? What are the anticipated costs for the next 10 years?

Answer (part 1): The cost per day to house an inmate is \$37.50 (from \$35/day in 2018) which is what the Department of Corrections pays us to house an inmate per day. According to the feasibility study, the cost per day rate is often higher than \$35 (this was the rate used during the feasibility study). The feasibility study did not include information on future anticipated costs. (See page 69 of the feasibility study)

Answer (part 2): This is truly dependent on economic, social, and political future of our country. It would be hard to estimate 10-year cost to house an inmate.

- 4) What will the daily utilization rate be for all the proposed spaces?

See chart below in yellow as the proposed increase in inmates/needs each year.

Inmate Needs	2023 Inmate Increase	Cost	2023 Need
Inmate Meals	41	\$1.34	\$60,159.30
Inmate Medical	41	\$2,968.00	\$121,688.00
Inmate Supplies	41	\$136.00	\$5,576.00
Laundry/Cleaning	41	\$77.00	\$3,157.00
Grand Total			\$190,580.30
Inmate Needs	2024 Inmate Increase	Cost	2024 Need
Inmate Meals	41	\$1.34	\$60,159.30
Inmate Medical	41	\$2,968.00	\$121,688.00
Inmate Supplies	41	\$136.00	\$5,576.00
Laundry/Cleaning	41	\$77.00	\$3,157.00
Grand Total			\$190,580.30
Inmate Needs	2025 Inmate Increase	Cost	2025 Need
Inmate Meals	43	\$1.34	\$63,093.90
Inmate Medical	43	\$2,968.00	\$127,624.00
Inmate Supplies	43	\$136.00	\$5,848.00
Laundry/Cleaning	43	\$77.00	\$3,311.00
Grand Total			\$199,876.90

- a) Will it all be used immediately? If not, at what rate will the space be utilized over the next 10 years?

Answer: We do not anticipate the needs of any future staff after 2025 (3 years projection). We predict that all areas will be used once the new facility is open/available. This is truly dependent on economic, social, and political future of our country.

	2023	Cost	2023 Need
Corrections Officers	2	\$47,068.92	\$94,137.84
Corrections Uniforms	2	\$1,000.00	\$2,000.00
Corrections Equipment	2	\$3,500.00	\$7,000.00
Central Control	4	\$47,068.92	\$188,275.68
Central Control Uniforms	4	\$1,000.00	\$4,000.00
Central Control Equipment	4	\$3,500.00	\$14,000.00
Communications Officers	2	\$47,068.92	\$94,137.84
Communications Uniforms	2	\$250.00	\$500.00
Communications Equipment	2	\$120.00	\$240.00
Security Guard	2	\$47,169.02	\$94,338.04
Security Guard Uniforms	2	\$1,000.00	\$2,000.00
Security Guard Equipment	2	\$9,000.00	\$18,000.00
Grand Total			\$518,629.40
New Positions	2024	Cost	2024 Need
Corrections Officers	5	\$48,480.99	\$242,404.95
Corrections Uniforms	5	\$1,000.00	\$5,000.00
Corrections Equipment	5	\$3,500.00	\$17,500.00
Central Control	0	\$48,480.99	\$0.00
Central Control Uniforms	0	\$1,000.00	\$0.00
Central Control Equipment	0	\$3,500.00	\$0.00
Communications Officers	2	\$48,480.99	\$96,961.98
Communications Uniforms	2	\$250.00	\$500.00
Communications Equipment	2	\$120.00	\$240.00
Security Guard	0	\$48,584.09	\$0.00
Security Guard Uniforms	0	\$1,000.00	\$0.00
Security Guard Equipment	0	\$9,000.00	\$0.00
Grand Total			\$362,606.93
New Positions	2025	Cost	2025 Need
Corrections Officers	3	\$49,935.42	\$149,806.26
Corrections Uniforms	3	\$1,000.00	\$3,000.00
Corrections Equipment	3	\$3,500.00	\$10,500.00
Central Control	0	\$49,935.42	\$0.00
Central Control Uniforms	0	\$1,000.00	\$0.00
Central Control Equipment	0	\$3,500.00	\$0.00
Communications Officers	1	\$49,935.42	\$49,935.42
Communications Uniforms	1	\$250.00	\$250.00
Communications Equipment	1	\$120.00	\$120.00

Security Guard	0	\$50,041.62	\$0.00
Security Guard Uniforms	0	\$1,000.00	\$0.00
Security Guard Equipment	0	\$9,000.00	\$0.00
Grand Total			\$213,611.68

5) What has been the full operational cost of the jail for the following years? 1. 2017, 2018, 2019, 2020, 2021

Answer:

FUND	2017	2018	2019	2020	2021
1170.0520 Jailers	\$431,046.12	\$497,361.64	\$533,377.76	\$596,287.50	\$626,001.70
1170.0516 Cooks	\$40,920.80	\$41,865.80	\$43,418.58	\$41,935.84	\$45,083.41
1170.0023 Overtime	\$9,751.11	\$11,237.50	\$21,078.90	\$8,510.90	\$20,829.98
1170.0564 Inmate Meals	\$219,962.95	\$249,525.35	\$232,061.85	\$187,938.57	\$246,981.91
1170.1362 Laundry/Cleaning	\$15,571.06	\$18,428.94	\$17,000.00	\$16,070.43	\$929.57
1170.0531 Mental Health	\$122,988.95	\$67,629.49	\$69,381.56	\$95,000.00	\$95,000.00
1170.0532 Medical	\$290,691.80	\$375,942.12	\$340,211.10	\$612,649.29	\$781,419.58
1170.9173 Vehicles	\$0.00	\$0.00	\$0.00	\$64,024.00	\$0.00
1170.0575 MV Labor	\$0.00	\$0.00	\$0.00	\$7,200.00	\$0.00
1170.9175 Vehicle Equip	\$0.00	\$0.00	\$0.00	\$51,386.00	\$0.00
1000.0005.0520 Jailers	\$535,701.91	\$551,587.40	\$424,620.95	\$392,039.74	\$382,524.55
4926.0073 Uniforms	\$8,000.00	\$11,914.61	\$8,199.56	\$22,892.83	\$11,110.20
4926.0570 Inmate Supplies	\$14,802.41	\$18,566.27	\$28,813.54	\$19,155.07	\$28,598.83
4926.0052 Repairs	\$7,703.11	\$651.34	\$3,441.81	\$0.00	\$5,301.79
4926.0009 Training	\$5,036.41	\$7,833.30	\$5,234.09	\$3,375.00	\$5,675.00
4926.0066 Equip	\$39,487.11	\$30,000.00	\$119,999.13	\$209,393.56	\$211,220.44
1175.0534 Jail Operations	\$16,025.52	\$5,000.00	\$5,000.00	\$0.00	\$0.00
1175.8551 Jail Programs	\$22,290.00	\$22,920.00	\$23,055.00	\$7,630.00	\$17,970.00
Grand Total	\$1,779,979.26	\$1,910,463.76	\$1,874,893.83	\$2,335,488.73	\$2,478,646.96

6) Will the former PSLIT tax that was implemented take care of cost for any portion of this project?

Answer: Yes, as much as it will support.

Jail Population

1. What has the daily average jail population been for the following years? a. 2017, 2018, 2019, 2020, 2021

Answer:

Average Monthly Population

	2021	2020	2019	2018	2017
January	125	204	203	213	178
February	126	190	210	225	203
March	124	170	201	227	192
April	125	118	200	222	208
May	129	103	208	220	211
June	136	100	220	225	221
July	143	102	212	209	209
August	134	114	217	205	222
September	145	126	220	190	227
October	141	142	197	191	215
November	150	139	199	187	206
December	148	131	187	193	208
Average Monthly					
Population	136	137	206	209	208

Highest Daily Population

	2021	2020	2019	2018	2017
January	134	215	213	226	197
February	136	200	225	235	211
March	133	189	211	241	208
April	136	138	209	234	223
May	140	113	216	234	220
June	154	109	235	237	230
July	153	108	221	219	224
August	142	129	230	212	237
September	153	140	233	201	246
October	148	152	207	205	225
November	161	147	212	195	215
December	159	138	198	199	223
Average Monthly	161	215	235	241	246

Note: Gray denotes Covid months

- b. How many inmates have received mental health services during this time? *In Answer: 2017 when PSLIT was implemented we began extensive mental health treatment in our facility. Between our medical provider which provides 30 hours of institutional mental health and our mental health/addiction providers which provide 112 hours/week, we have implemented substantial programs to deal with mental health. Much of this is funded by grants through DMHA, Recovery Works and other grants.*

- c. What was the average number of days they received treatment/services?

Answer: We provide treatment Monday-Friday. Because of lack of counseling/classroom space not all clients/inmates are provided services at this time.

2. How many days on average is an inmate incarcerated at the jail?

Answer:

	2021	2021	2020	2020	2019	2019	2018	2018	2017	2017
	Male	Female	Male	Female	Male	Female	Male	Female	Male	Female
Avg. Length of Stay	27.4	20.8	36.7	27.4	25.7	20.5	28.4	25.2	25.2	21.3
Avg. Felon Length of Stay	52.3	29.8	70.1	58.5	52.3	44.3	64.7	57.2	45.4	37.5
Avg. Misd. Length of Stay	14.8	15.3	17.5	12.3	14.9	9.7	15.8	11.8	20.8	17.8

3. On a weekly basis, how many inmates are on holds from other counties?

Answer: On an average two, however we are currently holding four for Vermillion County because they are building a new jail and we are receiving \$37.50/day for each inmate.

4. What percentage of inmates are Boone County residents?

Answer:

Residence of Boone County

	2021	2020	2019	2018	2017
Advance	6	11	12	10	11
Jamestown	24	28	52	67	57
Lebanon	503	469	747	742	798
Thorntown	72	52	95	98	79
Whitestown	43	42	74	62	69
Zionsville	83	69	124	140	182
Boone County Residence	731	671	1104	1119	1196
	37.8%	41.0%	38.8%	40.2%	39.9%
	1932	1636	2849	2782	2994

5. What is the breakdown of offenses (felonies and/or misdemeanors) of the jail population?

Answer:

As of today January 26, 2022 we have 133 inmates

6 awaiting transport to Department of Corrections

Due to Covid DOC will not allow us to transport these inmates. However, they pay us \$37.50 for every day the inmate is housed at our facility once sentenced.

10 serving DOC sentence at our facility.

These inmates are F6 felons. DOC pays us \$37.50 per day to house them at our facility.

8 serving misdemeanor sentences at our facility

These inmates either committed a misdemeanor or they committed a felony that was pled down to a misdemeanor. These sentences can range from 2 days to 2 years.

95 with Felony Charges awaiting court dates (2 Murder, 5 F-1 , 4 F2, 5 F3, 10 F4, 26 F5, 43 F6)

2 Murder cases: Buchanan and Grimball

8 with misdemeanor charges awaiting court dates.

Some inmates are held on a No Bond based on the level of their charges. The majority of inmates waiting for their court dates choose not to bond out for a variety of reasons:

- They cannot afford the bond*
- They decide to stay in jail and serve time now so that when they do go to court the days they were here will counted on their sentence and often it will be time served when the sentence given.*
- Inmates that are here on Probation Violation will stay and serve the remainder of their time so then when they are released, they are no longer on probation.*
- 6 that are Back for Court, Hold for another County or Safekeeper*
- 2 are Back for Court transports from Prison*
- 3 are Vermillion County inmates we are holding for them due to their construction. They are paying us \$37.50 a day to house them in our facility.*
- 1 Safekeeper from Marion County. It's a reciprocal agreement, Marion County takes inmates to hold for as well when needed.*

- a. How many inmates could be immediately eligible for work release, community corrections, probation or any other program that won't require them to be incarcerated with a judge's order or the prosecutor's recommendation?

Answer: That would be a question for Probation and Community Corrections. We work for the courts.

6. How many juveniles have been sent to another facility due to lack of space at the Boone County Jail?
 a. 2017, 2018, 2019, 2020, 2021 (Please include the cost for each year?)

Answer:

We no longer are allowed to house juvenile (adjudicated) within sight or sound of an adult inmate. We have not had any juvenile inmates brought into our facility in 2021.

We are not equipped to house juvenile due to the above restrictions. We did reach out to other Facilities and they would charge \$300-\$400 per day. This would not include cost of for two transport officers to bring the juvenile to and from the facility as needed for court.

The new Justice Center will provide 6 beds specifically for Juveniles. This will allow us to be compliant.

7. Have we received any notifications from any state or federal agency?
Answer: In 2014 it was indicated in the Jail State inspection report. We contracted to conduct a staffing analysis and found out we were understaffed by 14 corrections officers. Since the implementation of PSLIT we have been able to add 10 additional correctional officers.

Jail Staffing

1. How many correctional officers/jailers are budgeted for the 2022 fiscal year?
Answer: 28
2. How many correctional officers/jailers are currently working full-time?
Answer: 19 positions are currently filled, and we continue to supplement our Corrections Staff with Enforcement staff. We continue to run hiring processes to fill the remaining positions.
3. How many correctional officers/jailers are currently working part-time?
Answer: 1
4. What was the budget and for salary & benefits, training, and equipment cost for correctional officers/jailers working full-time and part-time for the following years:
 a. 2017, 2018, 2019, 2020, 2021
Answer: (Benefit package costs are controlled by the county council and are not included in these numbers below)

FUND	2017 (28)	2018 (28)	2019 (28)	2020 (28)	2021 (28)
1170.0520 Jailers	\$596,300.09	\$631,125.00	\$657,068.00	\$844,500.00	\$925,863.00
1000.0005.0520 Jailers	\$836,317.00	\$599,049.00	\$613,004.00	\$434,712.00	\$474,230.00
4926.0073 Uniforms	\$8,000.00	\$12,000.00	\$8,219.21	\$12,240.00	\$11,016.00
4926.0009 Training	\$8,000.00	\$8,000.00	\$4,000.00	\$8,160.00	\$7,344.00
4926.0066 Equip	\$30,000.00	\$30,000.00	\$80,000.00	\$220,000.00	\$198,000.00
Grand Total	\$1,478,617.09	\$1,280,174.00	\$1,362,291.21	\$1,519,612.00	\$1,616,453.00

5. What was the actual cost and for salary & benefits, overtime, training, and equipment cost for correctional officers/jailers working full-time and part-time for the following years:

a. 2017, 2018, 2019, 2020, 2021

Answer: (Benefit package costs are controlled by the county council and are not included in these numbers below)

FUND	2017 (28)	2018 (28)	2019 (28)	2020 (28)	2021 (28)
1170.0520 Jailers	\$431,046.12	\$497,361.64	\$533,377.76	\$596,287.50	\$626,001.70
1170.0023 OT	\$9,751.11	\$11,237.52	\$21,078.90	\$8,510.90	\$20,829.98
1000.0005.0520 Jailers	\$535,701.91	\$551,587.40	\$424,620.95	\$392,039.74	\$382,524.55
4926.0073 Uniforms	\$8,000.00	\$11,914.61	\$8,199.56	\$22,892.83	\$11,110.20
4926.0009 Training	\$5,036.41	\$7,833.30	\$5,234.09	\$3,375.00	\$5,675.00
4926.0066 Equip	\$39,487.11	\$30,000.00	\$119,999.13	\$209,393.56	\$211,220.44
Grand Total	\$1,029,022.66	\$1,109,934.47	\$1,112,510.39	\$1,232,499.53	\$1,257,361.87

6. Based on the proposed additions, what are the staffing level needs for the next 10 years?

a. Please include all positions, salary & benefits, training, and equipment cost

Answer: See question above under Future Jail Growth, Question 4(a).

7. How many maintenance staff are currently budgeted and how many do we currently have staffed?

Answer: We currently have 1 Maintenance Technician and 1 Janitorial/ Housekeeping at the Jail; this is fully staffed at this time.

8. Based on the proposed addition how many new maintenance/facility staff members will be added per year?

Answer: Based on the proposed addition and current workload at this building. We anticipate needing 5 additional employees, 2 Maintenance Technicians, 1 General Maintenance, 2 Janitorial/ Housekeeping. We do not foresee needing any more employees once fully staffed.

a. Please include position, salary & benefits, training, and equipment cost

Answer:

Fund	Salary	Benefits
1000.0380.410.411.0.3812 - Maintenance Tech	\$44,262.40	\$22,641.90
1000.0380.410.411.0.3812 - Maintenance Tech	\$44,262.40	\$22,641.90
1000.0380.410.411.0.3812 - General Maintenance	\$37,668.80	\$22,641.90
1000.0380.410.411.0.3812 Janitorial/Housekeeping	\$37,668.80	\$22,641.90
1000.0380.410.411.0.3812 Janitorial/Housekeeping	\$37,668.80	\$22,641.90

9. What will be the increase per year, over the next five years for our food service agreement?

Answer Part 1: In yellow below you will see what we are estimating for the next three years as an increase. Below that in green you will see the projected amount needed per year based on the numbers in yellow plus a 3% increase after the first three years.

Inmate Needs	2023 Inmate Increase	Cost	2023 Need
Inmate Meals	41	\$1.34	\$60,159.30
	2024 Inmate Increase	Cost	2024 Need
	41	\$1.34	\$60,159.30
	2025 Inmate Increase	Cost	2025 Need
	43	\$1.34	\$63,093.90

Answer Part 2: This is truly dependent on economic, social, and political future of our country. It would be hard to estimate 10-year cost to the food service agreement.

5 Year Projection

Inmate Needs	2022	2023	2024	2025	2026
Inmate Meals	\$360,000.00	\$420,159.30	\$480,318.60	\$543,412.50	\$559,714.88

10. How many additional medical and programming personnel need to be added based on the current project proposal? What are the anticipated increases over the next 10 years?

Answer Part 1: In yellow below you will see what we are estimating for the next three years as an increase. Below that in green you will see the projected amount needed per year based on the numbers in yellow plus a 3% increase after the first three years.

Inmate Needs	2023 Inmate Increase	Cost	2023 Need
Inmate Medical	41	\$2,968.00	\$121,688.00
	2024 Inmate Increase	Cost	2024 Need
	41	\$2,968.00	\$121,688.00
	2025 Inmate Increase	Cost	2025 Need
	43	\$2,968.00	\$127,624.00

Answer Part 2: This is truly dependent on economic, social, and political future of our country. It would be hard to estimate 10-year cost for inmate medical.

10 Year Projection

Inmate Needs	2022	2023	2024	2025	2026
Inmate Medical	\$725,000.00	\$846,688.00	\$968,376.00	\$1,096,000.00	\$1,128,880.00
	2027	2028	2029	2030	2031
	\$1,162,746.40	\$1,197,628.79	\$1,233,557.66	\$1,270,564.39	\$1,308,681.32

Programming

1. What programming is currently being offered at the jail?

Answer:

We offer educational classes and various mental health services.

Education

HiSet (formerly GED and HSE)

COVID has really hurt us this year. We ceased classes twice this year for COVID; July 23rd - August 16th and November 6th - December 6th. this has been a real switch for all of us to get used to.

We had 1 male inmate receive his HSE in 2021. (We graduated 18 in 2019!). We hold 1 class of ladies and 2 classes of gentlemen twice weekly; extra classes are added for test takers around exam time. In our HSE classes, our main emphasis is to prepare inmates to either take the HSE test or to complete coursework in order to earn their high school diploma. We also provide career testing, preparation for the COMPASS and SAT tests; materials for CDL license and regular driver's licenses, as well as extended math work. Many students refresh their academic skills so they will be ready for college/trade schools when they are released. We encourage peer tutoring in the block from those who have passed the test. It is working very well and the tutors take pride in doing it and giving back.

LIFE SKILLS' CLASSES

There are 4 Life Skills' classes available to the inmates: PARENTING, RESOURCES UPON RELEASE, JOB'S CLASS, AND ANGER MANAGEMENT/TRANSFORMATION. The inmates decide which class is offered. This year, because of COVID, we were lucky to get 1 class of Parenting and 1 class of Anger Management done.

The PARENTING CLASS that we offer is a compilation of two classes:
How to be a Responsible Father/Mother - Stawar and Parenting Now - Popkin.

Topics include:

Active Parenting (ages 1 - 4, 5 - 12, and 12+)

Child Development

Family Communications

Winning Cooperation

Responsibility and Discipline

Building Courage, Character, and Self-Esteem

We also work on activities that can be done with the children to help them form healthy bonds; one of those is reading. We purchase books to be shared with the inmates for their children. They love this activity.

7 male inmates and 3 female inmates completed this program in 2021.

The ANGER MANAGEMENT CLASS is an education and intervention, evidence-based class. The materials used are the SAMHSA Anger Management materials. This is a 3-month class which includes up to 12 - 90 minutes sessions. It helps the participants learn to manage anger, stop violence/the threat of violence, helps participants develop self-control over thought and actions, and provides support and feedback. The anger meter is used; journaling is practiced. A myriad of activities is used that helps them de-stress. Role-playing is utilized. 6 female inmates and 4 male inmates completed this program in 2021.

Mental Health

Integrative Wellness

Integrative Wellness (InWell) is a local behavioral health practice located in Lebanon, IN. InWell is currently providing several treatment services to our offender population that suffers from a substance use disorder (SUD). Currently, InWell is providing one hundred and thirty-six hours of pharmacological and psychosocial services per week in our facility. These hours and the various treatment modalities are broken down as follows:

**Clinical Assessment and Treatment Plan Development – Jessie Loghmani
LCSW (16 hours/week)**

This is where the initial treatment process begins for the offenders. They are given a full biopsychosocial assessment which looks at their substance use hx, psych hx, criminal hx, family hx, and medical hx. Based upon offender self-disclosures and clinical observations, the therapist will formally diagnose the offenders, and subsequently a treatment plan will be designed to both assist them with treating their addiction while incarcerated and have treatment recommendations for post-incarceration as well.

**Peer Support Services – Jennifer Van Nuys CHW, CRS, Shannon Fannon
CAPRC I, Stephany Bedolla CAPRC II (50 hours/week)**

A peer support is someone with the lived experience of both active addiction as well as recovery. The peer support helps to remove personal and environmental obstacles to recovery, links the newly recovering person to the recovery community, and serves as a personal guide and mentor in the management of personal and family recovery.

Matrix Group – Allene Brown LMFT (24 hours/week)

Matrix Model for Criminal Justice Settings Early Recovery (ER) group. In this group participants will learn basic skills to achieve initial sobriety and address the thinking errors that led to their involvement in the criminal justice system. They learn basic cognitive-behavioral tools for abstinence and the value of Twelve Step and other spiritual or self-help participation. The Matrix Model for Criminal Justice settings also adds an Early Recovery session prior to Family education. Matrix Model for Criminal Justice Settings Relapse Prevention (RP) group. These groups help offenders maintain abstinence and a pro social lifestyle by delivering information, support, and guidance as they proceed through recovery. This group includes a co-leader, an important element in the group dynamic. He or she should be a graduate participant (or in later stages of the program) who is continuing to work on a program of recovery that other participants can emulate.

Medication for Opioid Use Disorder (MOUD) - Dr. Crystal Jones, Vicki Wilky, NP, Elaine Myers RN (30-40 hours/week)

The purpose of the Medication-Assisted Treatment (MAT) Program is to provide pre-release treatment and post-release referral for opioid-addicted and alcohol-addicted justice involved individuals. This program involves jail-based substance abuse treatment and collaboration with community-based clinics to provide aftercare treatment. The goal is to facilitate transition into an outpatient substance abuse treatment program which employs a multi-faceted approach to treatment including the use of the FDA approved medications, counseling, and aftercare referral to community-based providers.

Jail Chemical Addiction Program (JCAP) – Anita Parks-Gherung LCSW and Stephany Bedolla CAPRC II

The JCAP program is a intensive treatment program funded by the local community corrections. This program has a unique curriculum that is based in Cognitive Behavioral Therapy (CBT) and provides for approximately 14 group service hours per week. Along with the core addition curriculum, there is also a skill component which allows for the provision of skills for addressing maladaptive behaviors. The resources used in this program provide comprehensive and integrated models addressing the broad range of needs and key internal and external factors for the justice involved population. Supporting a flexible open group/open admissions format.

2. What is the budget for all programming being offered at the jail?

Answer:

- a. **\$30,600 is budgeted for HSE, Anger Management, Parenting Classes, Life Skill Classes**
- b. **MAT/MOUD Program is based of an Indiana Sheriff's Association Grant (\$4 million through DMHA for all 92 Sheriff's)**
- c. **JCAP is funded through a \$75K grant through Community Corrections.**
- d. **Mental Health/Addiction services – 112 hours funded through Recovery Works and other State Grants, this is not a budgeted amount through the Sheriff's Office we contract this out with InWell & Aspire.**

3. How are these programs currently funded?

Answer: See above

4. What is the plan if funding is cut or reduced for these programs? How will they be funded?

Answer: The Sheriff is currently working sustainability for funding through legislation, Governor's Office, DMHA.

5. What programming will be offered at the new jail?
Answer: All programs stated above, but ALL inmates will have access to these programs with the additional programming space. We will also offer, life skills, trade skills and other appropriate skills in the step-down unit.

6. What is the proposed cost per program (new and existing) at the new jail?
Answer: Undetermined, but hope to continue funding through grants as stated above.

7. What vocational programs are being offered in the proposed expansion?
Answer: Trade skills COULD consist of auto mechanic, welding, HVAC, ServSafe, etc. Life skills could consist of interviewing skills, budget preparation, household management, etc. productive

8. What are the staffing levels for the next 10 years for each vocation program?
 - a. Please include position, salary & benefits, training, and equipment cost
Answer: We will continue to contract this out and if there are costs our goal is to get funding through State Grants and State Funded Programs through the Department of Corrections or Workforce Development.

Variable Soft Cost

1. What will be the additional transport fleet cost over the next 10 years?
Answer: Our strategic plan has our two current transport vans that were put in service in 2020 with an anticipated life cycle of ten years.

2. Based on the proposed addition, what will the increased water/electricity, natural gas and all other utilities be each month?
Answer: After contacting Lebanon Utilities, there is no reliable way to estimate utilities until the building is in use.

3. What will be the increased annual mechanical/HVAC/routine maintenance costs. Please provide projections over the next 10 years.
*Answer: Boone County Currently has a maintenance contract in place for mechanical & HVAC and based off the square footage increase we should anticipate an increase to \$35,000 per year. Routine maintenance for original structure will most likely stay the same or slightly increase over the next ten years,
 As for the new building it will be under warranty for the first year, and we do not anticipate a lot of repairs for the first 5 years. After the building is occupied, we will have a better idea of the maintenance needs and will be able to estimate routine maintenance cost.*

4. As new staff are added, what is the cost for new furniture, fixtures and equipment per employee?
Answer: See above for personnel costs. With regard to FFE (furniture, fixtures and equipment), the cost for FFE for the project will be accounted for within the total cost of the project.

5. What is the cost per square foot for the added space?
Answer: The cost per square foot (Hard Costs) for the added space is \$450.23 dollars per square foot.
6. What have been the annual cost for all utilities for the following years: a. 2017, 2018, 2019, 2020, 2021

Answer:

Fund	2017	2018	2019	2020	2021
1000.0380.430.435.0.0026 -Utilities	\$190,226.83	\$210,236.35	\$196,295.73	\$172,973.76	\$170,068.60

Work Release

1. What is the budget for 2022 for work release staff?
Answer: The Community Corrections budget for work release staff for 2022 is contained in the budget adopted by the County Council.

2. What is the cost for work release staff?

Answer: See Answer above

- a. Please include position, salary & benefits, training, and equipment cost
Answer: See Answer above

3. How many work release staff members do we currently have staffed at the jail?
Answer: None

4. How many work release beds are in the current jail? What has been their use and occupancy over the last five years?

Answer: There are currently fifteen (15) work release beds (men only) at the jail. They have not been occupied since the pandemic to attempt to reduce transmission among residents and staff.

5. How many new work release beds are being added to the proposed project? How was this number determined?

Answer (Part 1): Community Corrections – Initial Expansion:

- *58 Male beds*
- *24 Female beds (Currently NO female Work Release)*
 - *Total Initial Expansion Community Corrections of 82 Beds*
 - *Future expansion of 38 male beds to 96 beds*
 - *Future expansion of 24 female beds to 48 beds*
 - *Total build out is 144 beds*

Answer (Part 2): Work Release numbers were determined based on several things:

- *Current Work Release is small and in past could only accommodate 15 beds. Not large enough to accommodate current / future load.*
- *Based on current numbers of individuals with outstanding warrants, current probation numbers, as well as the pretrial process work release numbers will increase exponentially.*

6. How many work release staff members are budgeted for the proposed expansion?

Answer: If the unit is fully occupied, we would anticipate one staff member and 9 living unit coordinators.

a. Please include position, salary & benefits, training, and equipment cost

Answer: We estimate the total personnel cost to be approximately \$850,000 annually. As previously stated much of this cost can be covered by accepting residents through the Community Treatment Program (CTP) run by IDOC. They will reimburse the County \$25/day per resident and will utilize the same programs and services that we will be offering to our residents. If 50 of the work release beds were utilized for CTP residents it would generate approximately \$450,000 annually that could be used to pay for personnel costs. County clients would pay \$12/day for work release, which will also be used to defray the operational costs of the facility. Also, the Jail LIT tax provides that 20% of the amount collected can be used to pay for operational expenses of the correctional facility (including personnel costs).

b. Include projected needs over the next 10 years

Answer: See answer above