

SECTION CORNER RECORD

SW 500-200

BOONE COUNTY SURVEYOR'S OFFICE

State Plane grid coordinates NAD83 (2011):

North: 1719012.77 East: 3114389.63 (U.S. survey feet)

Type of monument: Harrison, 4" disk 'Section Corner'

Depth: Four inches above adjacent ground

Indiana tie card references:

IN02_T18NR1W27_80 IN02_T18NR1W26_72

IN02_T18NR1W34_08 IN02_T18NR1W35_00



CORNER WITNESS DETAIL

SCALE 1" = 50'

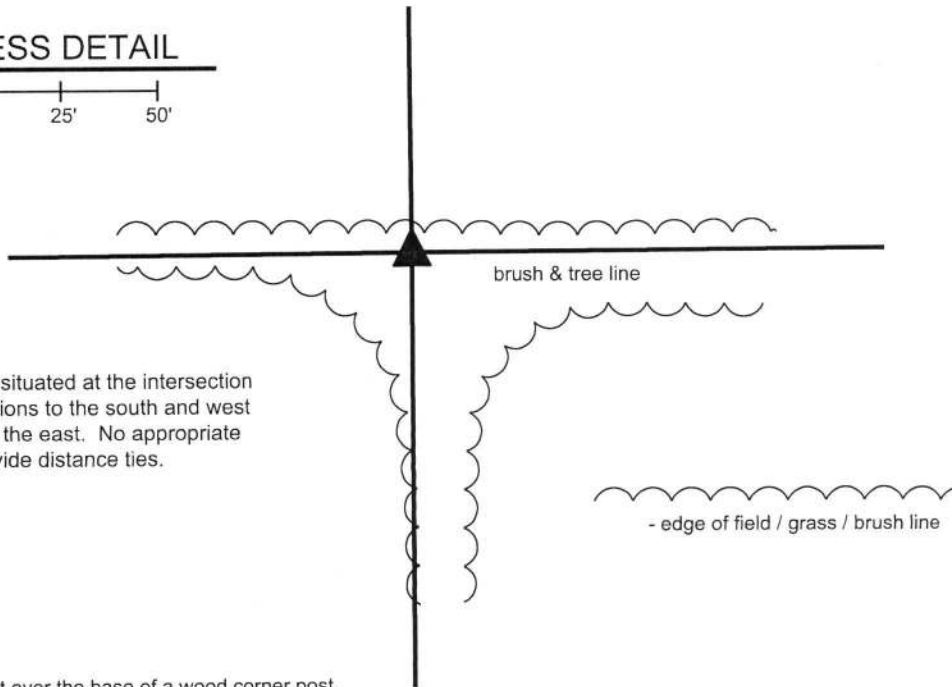
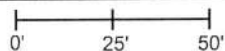

The Harrison monument is situated at the intersection of brush lines and field divisions to the south and west and a brush and tree line to the east. No appropriate objects are available to provide distance ties.

The Harrison monument was set over the base of a wood corner post.

No specific descriptions of this corner were found in the BCS Surveyor's Record beyond the original establishment of the corner as a wood post in 1820. The corner is referenced as the terminal point for measurements in an entry of April 20, 1874. No recent BCS tie cards were found referencing the corner. A survey for INDOT by Frank T. Luse, LS #20000223, recorded in Survey 15, pages 52-53 in the Office of the Boone County Recorder, shows the corner as "post base." No other recorded surveys were found which reference the corner.

This corner was excavated on April 2, 2019. Prior to excavation, in April 2016, a wood corner post had been observed at the corner, fallen on the ground. On April 2, 2019, the post was found yet lying on the ground amidst a variety of rocks and rubble, in-line with field divisions to the east and west and at the west edge of a wide, humped field division to the south. The position of the post, as it had stood prior to falling over, was confirmed by physically standing up the post which was yet attached to wires to the east and west. This position was found to agree well with the 2016 observation and the position shown on the Luse survey. Excavation in the vicinity of the post revealed numerous rocks, none of which could be confirmed as being a purposely set corner stone. The base of the post was found at 18 inches deep. It is noted that the position of the post is slightly west of what appears to be an old fence hump to the south, but the post itself had not only fencing attached to the east and west but evidence fencing cut-off to the north and south. No evidence of another post was found in line with the hump to the south. The position of the post works well with the measurement references from 1874 and the relative positions of a stone at the corner 1/2 mile west (see BCS corner SW-500-250) and a wood corner post found providing evidence of the quarter-quarter corner between said stone and the subject corner. The post was accepted as the best available evidence of the corner. The fencing was cut from the post and the top section of the post was placed nearby, amidst the various rubble. A Harrison monument was set directly over the base of the post on April 17, 2019.

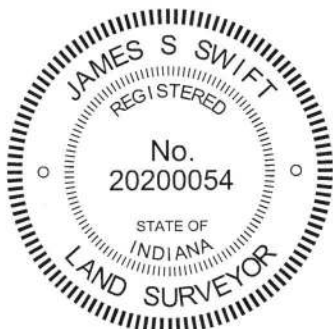

Kenneth E. Hedge, County Surveyor

James S. Swift, IN LS 20200054
May 8, 2019

Harrison Township

Section 27 T18N, R1W	Section 26 T18N, R1W
Section 34 T18N, R1W	Section 35 T18N, R1W

SECTION CORNER RECORD

SW 500-250

BOONE COUNTY SURVEYOR'S OFFICE

State Plane grid coordinates NAD83 (2011):

North: 1718996.24 East: 3111711.38 (U.S. survey feet)

Type of monument: 5/8 inch rebar with metal cap stamped 'Boone County Surveyor'

Depth: 2 inches above adjacent grade

Indiana tie card references:

IN02_T18NR1W27_76 IN02_T18NR1W34_04

CORNER WITNESS DETAIL

SCALE 1" = 50'

0' 25' 50'

- edge of grass / field / tree line

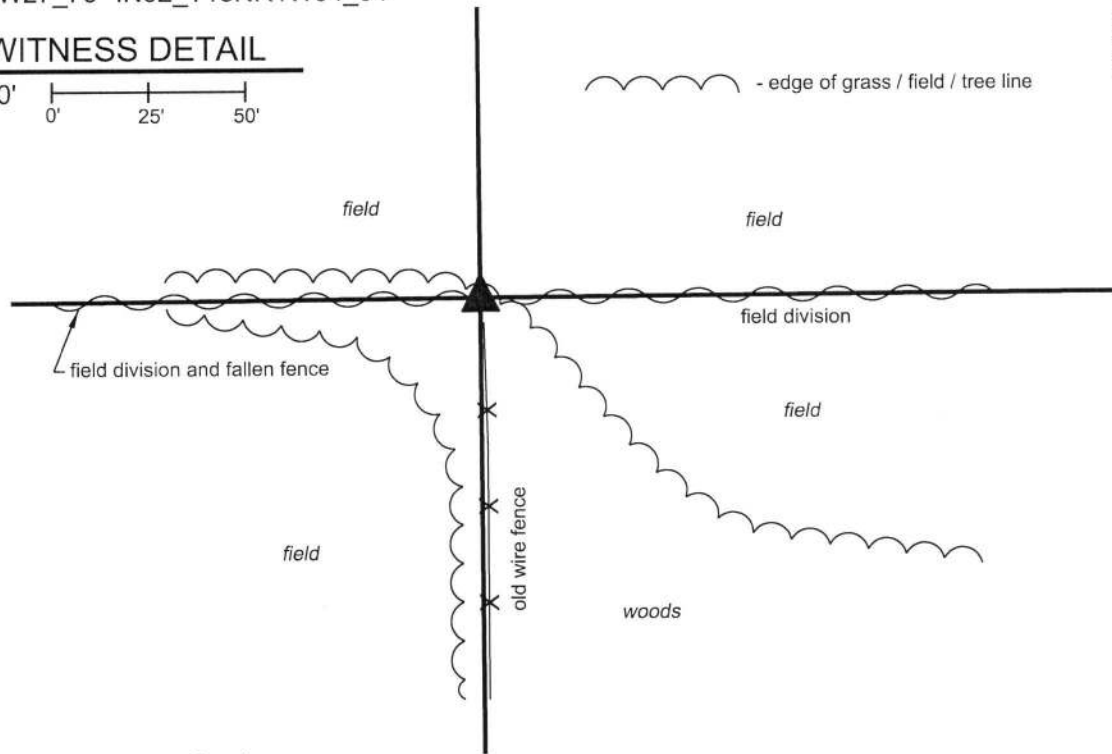

The rebar was set directly above a stone found.

A BCS record dated April 20, 1874 states, with respect to this corner, "Reestablished from N. tree after tracing the lines meeting here to prove that it was the tree (as the tree had been boxed before.) Set Rock 17,13, 9+." A subsequent record dated May 4, 1881 states "Rock established from North tree as above. Found Rock 17,13, 9." No recent BCS tie cards were found referencing the corner. A survey by Jerry L. Carter, LS #S0350, recorded as Instrument 0305086 in the Office of the Boone County Recorder shows the corner as "Accepted Headpost."

This corner was excavated on March 29, 2019. Prior to excavation, the headpost shown on the Carter survey was found at the northwest corner of a small woods, at the terminus of an old fence to the south and a fallen fence to the west and in-line with field divisions to the east and west. Excavation in the vicinity of the post revealed the stone described in the 1874 and 1881 records at 18 inches deep, adjacent to the west edge of the post. The stone has a clear and distinct etched "+" mark on the top, center. The post is leaning in such a manner that it was not possible to establish a Harrison monument in a stable manner over the top of the stone. However, a smaller monument could be set directly over the mark on the stone. On April 17, 2019, the stone was uncovered again. The top several inches of the stone were encased in concrete amidst a large base of concrete integrated with 2-foot lengths of 1/2 inch rebar driven around the stone. A 4 inch diameter section of PVC pipe was set directly above the stone, attached to the concrete base with 2-foot lengths of 3/8 inch diameter rebar. The PVC pipe was filled with concrete and a 12 inch long section of 5/8 inch rebar was set vertically in the concrete, directly above the etched "+" mark on the stone. A metal cap stamped Boone County Surveyor was placed on the rebar. The capped rebar is directly above the mark on the stone and appears, at ground level, to be at the northwest edge of the post.

This corner was originally established as a wood post in 1820.

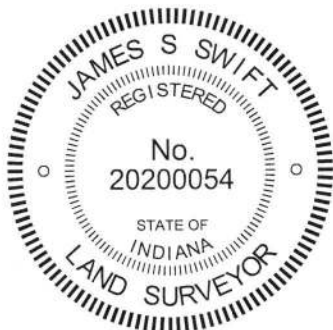

Kenneth E. Hedge, County Surveyor

James S. Swift, IN LS 20200054
May 8, 2019

Harrison Township

Section 27
T18N, R1W

Section 34
T18N, R1W

SECTION CORNER RECORD

SW 500-300

BOONE COUNTY SURVEYOR'S OFFICE

State Plane grid coordinates NAD83 (2011):

North: 1718978.20 East: 3109053.71 (U.S. survey feet)

Type of monument: Harrison, 4" disk 'Section Corner'

Depth: 5 inches above adjacent ground

Indiana tie card references:

IN02_T18NR1W28_80 IN02_T18NR1W27_72

IN02_T18NR1W33_08 IN02_T18NR1W34_00

CORNER WITNESS DETAIL

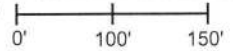
SCALE 1" = 150' 

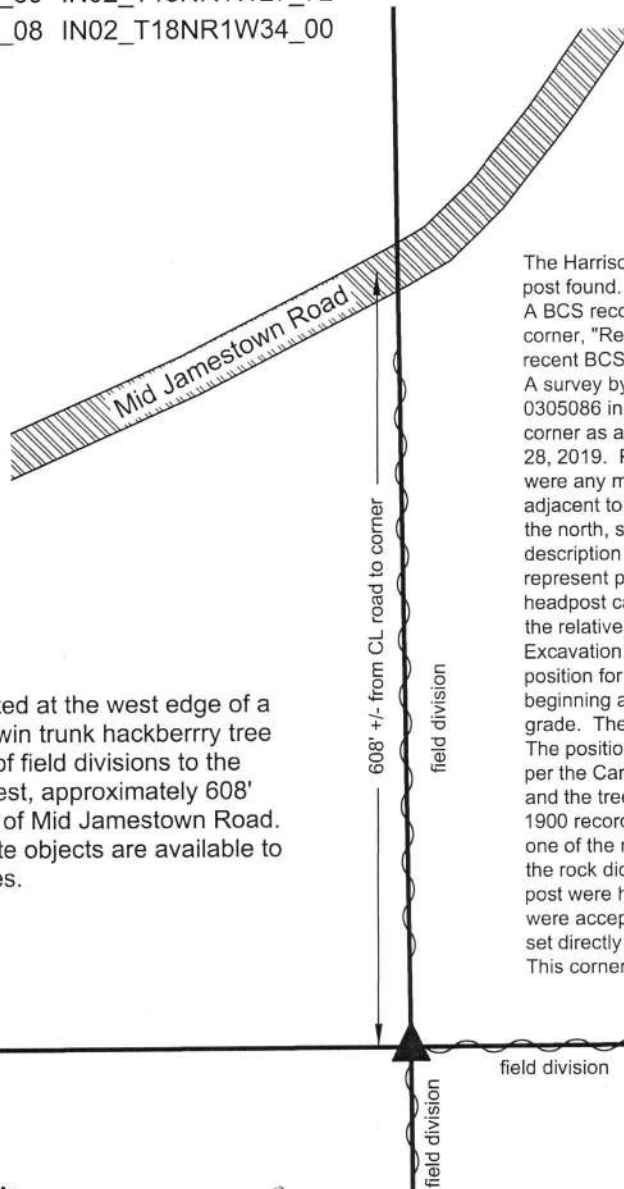

The corner is situated at the west edge of a 20 inch diameter, twin trunk hackberry tree at the intersection of field divisions to the north, south and west, approximately 608' south of the center of Mid Jamestown Road. No other appropriate objects are available to provide distance ties.

The Harrison monument was set over remnants of a wood corner post found. A BCS record of October 11, 1900 states, with respect to this corner, "Reestab. Set Rock 15,17 +. Small rock beneath." No recent BCS tie cards were found referencing this corner. A survey by Jerry L. Carter, LS #S0359 recorded as Instrument 0305086 in the Office of the Boone County Recorder shows the corner as a "HEADPOST". This corner was excavated on March 28, 2019. Prior to excavation, the headpost was not visible, nor were any metal monuments. Two rocks were visible on the ground adjacent to a hackberry tree at the intersection of field divisions to the north, south and east. Neither of the rocks matched the description called in the 1900 record nor did they appear to represent purposely set corner stones. The position of the headpost called in the Carter survey was computed with respect to the relative positions of other monuments shown on that survey. Excavation in the vicinity of the hackberry tree and the computed position for the headpost revealed remnants of a wood post found beginning at 12 inches deep and exposed up to 20 inches below grade. The post is adjacent to the west edge of the hackberry tree. The position of the post precisely matched the computed position per the Carter survey. A small rock was found between the post and the tree but the rock did not match the dimensions called in the 1900 record. It was observed that the rock appeared to be part of one of the rocks found above ground. Combined, the two pieces of the rock did not match the 1900 description. The fragments of the post were held as the best available evidence of the corner and were accepted as marking the corner. A Harrison monument was set directly over the found base of the post. This corner was originally established as a wood post in 1820.

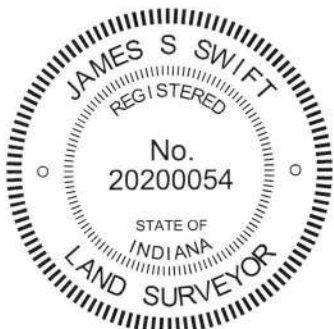

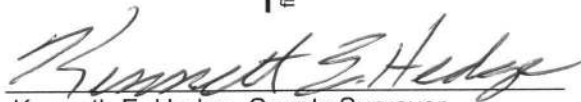
Kenneth E. Hedge, County Surveyor

James S. Swift, IN LS 20200054
May 8, 2019

Jackson Township

Section 28 T18N, R1W	Section 27 T18N, R1W
Section 33 T18N, R1W	Section 34 T18N, R1W

SECTION CORNER RECORD

SW 550-200

BOONE COUNTY SURVEYOR'S OFFICE

State Plane grid coordinates NAD83 (2011):

North: 1716366.08 East: 3114400.82 (U.S. survey feet)

Type of monument: 5/8" rebar with metal cap stamped 'Boone County Surveyor'

Depth: Two inches above surrounding ground

Indiana tie card references:

IN02_T18NR1W34_44 IN02_T18NR1W35_36

CORNER WITNESS DETAIL

SCALE 1" = 50'

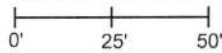

- A - S.E. side 16" diameter Walnut tree, 1' a.g., 34.4'
 - B - E. side 24" diameter multi trunk Maple tree, 1' a.g., 12.5'
 - C - N. side 12" diameter Walnut tree, 1' a.g., 34.6'
- Note: the corner monument is situated 0.95 feet WSW of the southwest corner of an 8x8 inch wood corner post.

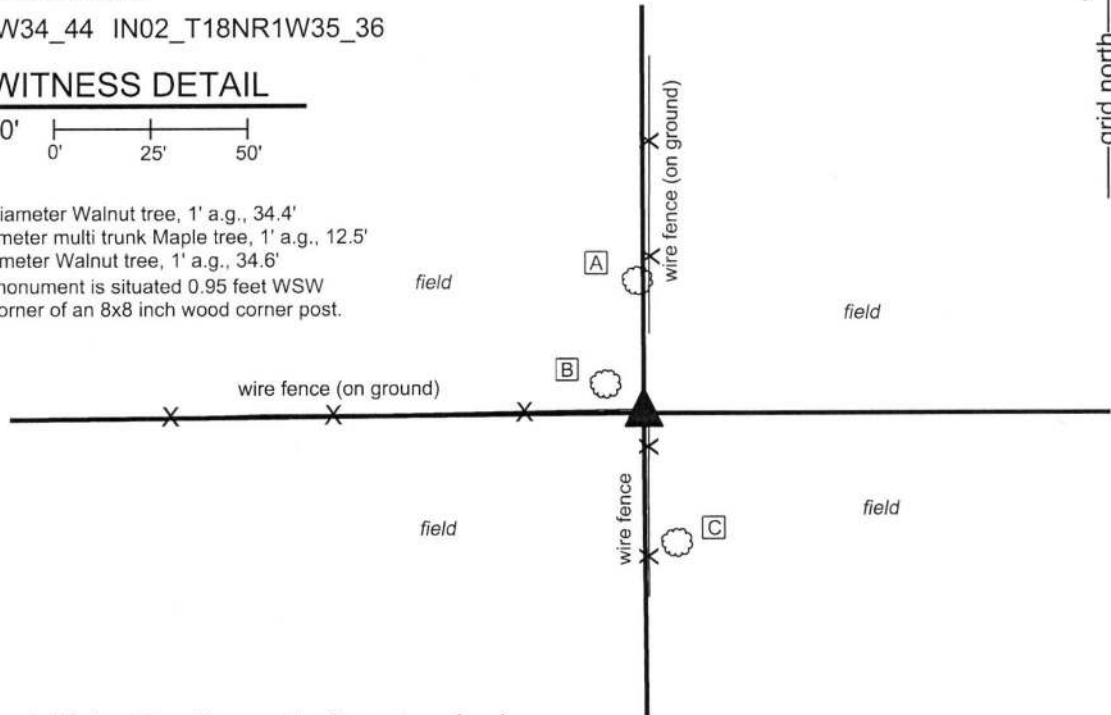

The rebar was set in a calculated position with respect to witness stones found.

A BCS record of October 10, 1912, states, with respect to this corner, "Set two rocks, each 5 links and 5 links west of true corner." No recent BCS tie cards were found referencing this corner. A survey by Jerry L. Carter, LS #S0350, recorded as Instrument 0410697 in the Office of the Boone County Recorder, shows the corner as a headpost.

This corner was excavated on May 16, 2019. Prior to excavation, a wood corner post matching the position of the headpost shown on the Carter survey was found at the intersection of fences to the north, south and west. The fence to the south is standing while the fencing to the north and west are generally on the ground. The post is ancient, 8 inches square, with wooden braces to the south and west. Excavation around the post revealed two large rocks found north and west of the post and one small rock found to the south of the post. None of these rocks appeared to be monuments marking the corner. All three were haphazard in orientation and appeared to simply be rocks located in the vicinity of the post. Probing to the east and west of the post revealed two stones found, each at 20 inches deep, the top centers of which were located precisely 10 links (6.6 feet) apart. The tops of both stones were exposed and measured. The easterly of the stones measures approximately 6 inches N-S by 8 inches E-W on top. The westerly of the stones measures 9 inches N-S by 10 inches E-W on the top. Possible etched marks were detected on both stones, though the marks are not deeply etched in the rocks and it is not possible to positively confirm them as purposely etched markings. As noted, the centers of the tops of the stones were located precisely 10 links apart. No other stones were found in the vicinity of the post via excavation or probing. The stones were accepted as representing the witness rocks called in the 1912 record. The position of the corner was established at the midpoint of a line connecting the respective tops of the stones, 5 links from each stone. This position falls 0.95 foot WSW of the southwest edge of the corner post and slightly south of the wood brace attached to the west side of the post. A 36 inch length of 5/8 inch rebar was set vertically in concrete to mark the corner position. The rebar is capped with a metal cap stamped 'Boone County Surveyor' with a punch mark at the precise position of the corner. This corner was originally established as a wood post in 1820

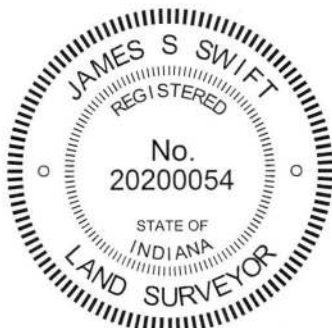

Kenneth E. Hedge
Kenneth E. Hedge, County Surveyor

James S. Swift
James S. Swift, IN LS 20200054
June 12, 2019

Harrison Township

Section 34 T18N, R1W	Section 35 T18N, R1W
-------------------------	-------------------------

SECTION CORNER RECORD

SW 600-250

BOONE COUNTY SURVEYOR'S OFFICE

State Plane grid coordinates NAD83 (2011):

Corner 1: North: 1713705.93 East: 3111757.27 (U.S. survey feet)

Corner 2: North: 1713706.71 East: 3111875.74 (U.S. survey feet)

Corner 1: Iron plug, flush with road surface

Corner 2: Harrison, 4" disk 'Section Corner', flush with road surface

Indiana tie card references:

IN02_T18NR1W34_76 IN02_T17NR1W34_04

CORNER WITNESS DETAIL

SCALE 1" = 50'

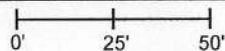

① South quarter corner
Section 34, T 18 N, R 1 W

② North quarter corner
Section 3, T 17 N, R 1 W

Distance between monuments:
118.47 feet = 179.5 links



A - Boone County witness mark, flush,
33.3' to corner 1, 89.3' to corner 2

B - X carved in guardrail bolt, flush,
74.7' to corner 1, 47.5' to corner 2

C - Notch carved in top guardrail post,
125.2' to corner 1, 14.8' to corner 2

D - N.E. corner concrete headwall,
125.1' to corner 1, 17.0' to corner 2

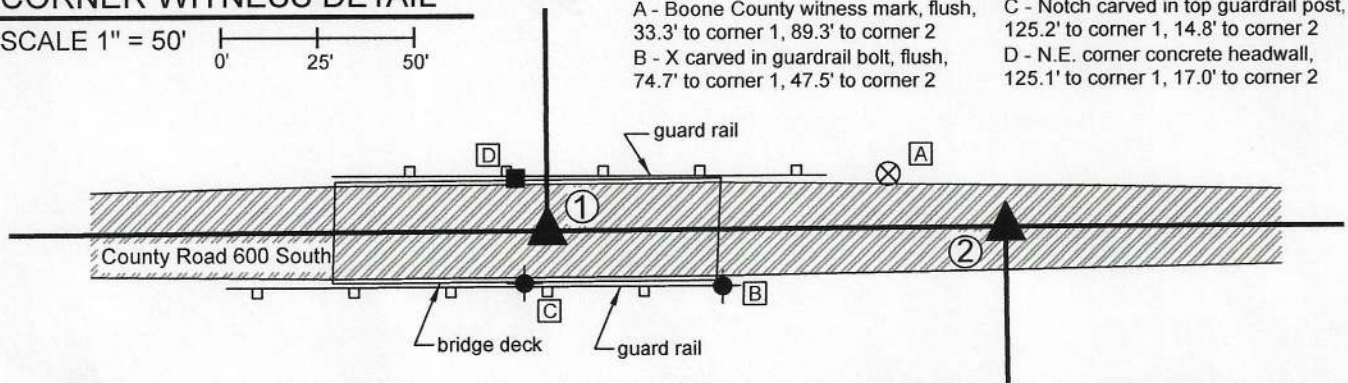

The Harrison monument at Corner 2 was set by contractors working on reconstruction of Bridge 161 over Grassy Branch, in the place of a 5/8 inch rebar previously accepted as marking the corner. The iron plug in concrete was set as part of the same project at a computed position, established by this office. With respect to Corner 1, this corner was originally established in 1819 on the township line. A BCS record dated September, 1870 states that Corner 1 was "found by measuring the lap." In this record, the term lap refers to the offset between the closing and standard corners. Corner 1 is also shown as the terminal point of measurements in entries of June 4, 1838 and December 17, 1912. Corner 2 is shown as the terminal point for measurements in records of June 30, 1839 and October 5, 1919. Corner 2 is also shown on a BCS tie card dated December 21, 1982 which demonstrates the corner in the approximate center of County Road 600 South, in line with a fence to the south. The tie card states "No stone found. Set steel rod."

It is noted that Corner 2 is not an original federal corner. The average of the township line offsets at the northeast and northwest corners of section 3 is 179.5 links or 118.47 feet. The 1870 reference does not specifically refer to this dimension but it has been demonstrated repeatedly and consistently at other similar corners that the Boone County Surveyors of that era held the average of the original federal closing distances at quarter corners on range and township lines. A route control survey recorded as Instrument 2018009806 Survey Book 18, page 63 in the Office of the Boone County Recorder shows both corners. Corner 2 was held as the rebar shown on the 1982 tie card. Corner 1 is shown as being 127.29 feet to the west, having been established at 684.12 feet easterly of a mag nail found ostensibly marking the southeast corner of a parcel of land conveyed by Warranty Deed recorded as Instrument 200800008852 in said recorder's office. The Route Control survey does not provide further justification for the position of Corner 1 beyond the record deed tie distance. Right-of-way parcels conveyed to the Boone County Commissioners by Instruments 20019004208 (section 34) and 20019004209 (section 3) hold the respective corners as shown on the route control survey. Subsequent to the recording of the survey and the deeds, this office was contacted to establish these corners for purposes of monumentation during the bridge reconstruction project. After careful analysis and study, the position of Corner 2 (shown at point 3 on the Route Control Survey) was held as marking that corner, in agreement with the 1982 tie card. This position is supported by the evidence of the fence shown on the 1982 tie card. The position of Corner 1 as established by the Route Control Survey (shown as point 9 on the survey) is not held. It was discovered that by establishing the corner at the average federal closing distance of 179.5 links, in apparent agreement with the 1870 BCS record and well established BCS procedures, the line between Corner 1 and a nail commonly accepted as marking the center of section 34 lines up precisely with ancient wood posts found on the north and south sides of State Road 39 and works well with the deed distances for the south line of a 1.72 acre parcel described in Instrument 201700002630 with respect to the section line and the center of State Road 39. The "lap" of 179.5 links (118.47 feet) was held to establish Corner 1, as supported by the evidence of the posts providing evidence of ancient occupation along the east line of the southwest quarter, section 34. This position was marked for contractors on April 28, 2020. The iron plug marking Corner 1 was set that day, as was the Harrison monument marking Corner 2. It is noted that, due to uncertainties associated with the northeast corner of section 3 and southeast corner of section 34, an angle point was introduced into the township line at Corner 2 and Corner 1 was established on-line between Corner 1 and the northwest corner of section 3. It is further noted that uncertainties with the position of Corner 1 with respect to the aforementioned route control survey are 8.82 feet east-west. The right-of-way parcel description in Instrument 2019004208 was described from the position of the corner established by the Route Control Survey. This description calls for that survey and should be retraced with respect to the totality of the calls in the description and the referenced Exhibit B, Right-of-way Parcel Plat, which should account for the variation between the corner as established on the Route Control Survey and the position of the corner as established by this document.

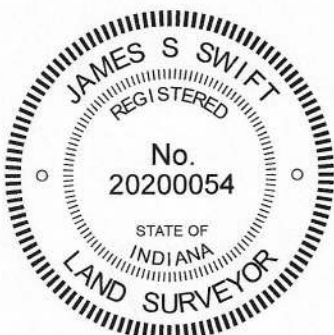

Kenneth E. Hedge
Kenneth E. Hedge, County Surveyor

James S. Swift
James S. Swift, IN LS 20200054
September 30, 2020

Harrison
Township

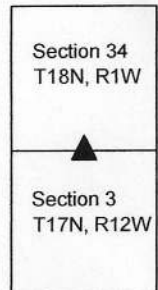

SECTION CORNER RECORD

SW 600-300

BOONE COUNTY SURVEYOR'S OFFICE

DATA FOR CORNER 2 ONLY:

State Plane grid coordinates NAD83 (2011):

North: 1713689.49 East: 3109261.13 (U.S. survey feet)

Type of monument: Harrison, 4" disk 'Section Corner'

Depth: Four inches above adjacent ground

Indiana tie card references:

IN02_T18NR1W33_80 IN02_T18NR1W34_72

IN02_T17NR1W04_08 IN02_T17NR1W03_00

① S.E. Corner, Section 33
S.W. Corner, Section 34
T 18 N, R 1 W
POSITION NOT YET DETERMINED
SEE NOTES

② N.W. Corner, Section 3
N.E. Corner, Section 4
T 17 N, R 1 W
HARRISON MONUMENT SET



CORNER WITNESS DETAIL

SCALE 1" = 60'

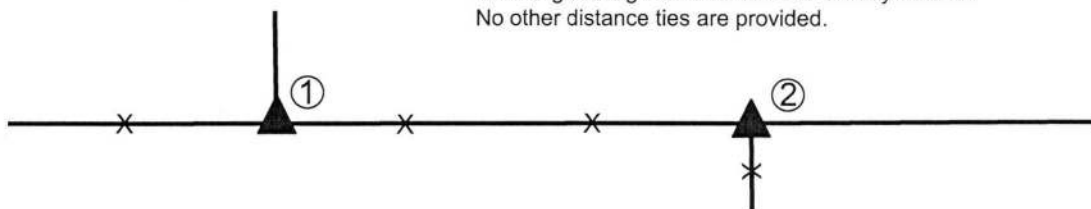

Note: The Harrison monument marking Corner 2 is situated at the east edge of a wood corner post at the intersection of fences to the south and west, witnessed by an orange fiberglass lathe labeled 'Survey Marker.' No other distance ties are provided.

The Harrison monument at Corner 2 was set in place of a stone found. The precise position of Corner 1 has not yet been established as of the date of publication of this document.

A BCS record of February 22, 1894 states, with respect to Corner 2, "Found from red oak stump after running line." The record does not specify the monument found. No specific descriptions of Corner 1 were found in the BCS Surveyor's Record beyond the original establishment of the corner as a wood post in 1819. An entry of September 30, 1971 calls Corner 1 as "Stone Found Railroad Rail put in" but no further information was found with respect to this entry and it is believed most likely to be a reference a different corner entirely.

The stone at Corner 2 was found with the top approximately 2 inches above flush at the east edge of an ancient corner post, being at the corner of fences to the south and west. The stone is known to have been held as marking the corner by numerous surveys in the past including a survey by Dewey L. Witte, LS #29800022, recorded in Survey Book 11, pages 16-17 in the Office of the Boone County Recorder and a survey by Mark A. Schepers, LS #29500001, recorded in Survey Book 18, page 63 in said Recorder's Office. The stone is also shown as marking the Corner 2 on Bruner Minor Plat recorded in Plat Book 14, page 27 in said Recorder's Office. The stone was found, apparently undisturbed in May, 2018. The position of the stone matched closely with the position shown on the aforementioned surveys and plat. The stone was horizontal and oriented NW-SE. It measured 21 inches NW-SE by 10 inches NE-SW by 8 inches tall. A clear and distinct etched "+" mark was found on the approximate top center of the rock. Although, evidently not disturbed in position in recent years, the stone was not particularly stable in the ground, and was able to be moved with a shovel with reasonably minimal effort. Being neither vertical nor oriented in cardinal directions, the stone does not fit the characteristics associated with most found and accepted corner stones. However, the mark on the stone was readily visible and it is known to have been held as marking the corner by numerous surveyors. Given the obvious mark on the top of the stone and the acceptance of the monument as marking the corner by previous surveyors along with a lack of obvious contrary evidence, the stone was held as marking Corner 2. The stone was removed and another, smaller, though vertical, stone was found below. The lower stone was left in place and a Harrison Monument was set in place of the etched mark on the top stone on May 16, 2019. Minimal uncertainty is associated with the position of Corner 2, as monumented. However, significant uncertainty is associated with the position of Corner 1. The two recorded surveys referenced above both call Corner 1 as a wood corner post found approximately 148 feet west of the stone. The Bruner Minor Plat, which defines the properties to the northeast of Corner 1 and southeast of Corner 2 shows Corner 1 as being 167.6 feet (254 links) west of the stone at Corner 2, matching the original federal offset at this corner recorded in 1820. Hence, an uncertainty of approximately 20 feet east-west is attributed to the position of Corner 1. The post called in the surveys was found and is notably the only physical evidence observed of the line bearing north from Corner 1. As additional research is required to resolve the conflict between the surveys and plat, the final position of Corner 1 will be established at a later date. The position of Corner 2 is affirmed at this time in support of establishing alignment for corners to the east in association with the imminent reconstruction of the County Road 600 South bridge over Grassy Branch. Corner 1 was originally established as a wood post in 1819 and Corner 2 was originally established as a wood post in 1820.

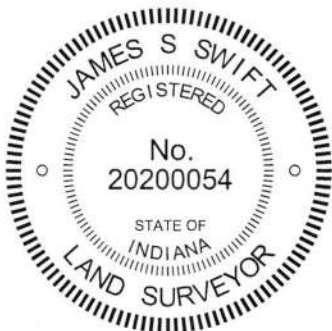

Kenneth E. Hedge
Kenneth E. Hedge, County Surveyor

James S. Swift
James S. Swift, IN LS 20200054
July 9, 2019

Harrison Township

Section 33 T18N, R1W	Section 34 T18N, R1W
Section 4 T17N, R1W	Section 3 T17N, R1W