

SECTION CORNER RECORD

SW 500-400

BOONE COUNTY SURVEYOR'S OFFICE

State Plane grid coordinates NAD83 (2011):

North: 1718964.75 East: 3103733.23 (U.S. survey feet)

Type of monument: Harrison, 4" disk 'Section Corner'

Depth: 3 inches above adjacent ground

Indiana tie card references:

IN02_T18NR1W29_80 IN02_T18NR1W28_72

IN02_T18NR1W32_08 IN02_T18NR1W33_00

CORNER WITNESS DETAIL

SCALE 1" = 20'

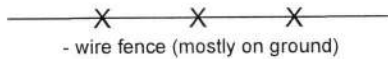
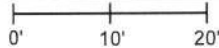

- wire fence (mostly on ground)

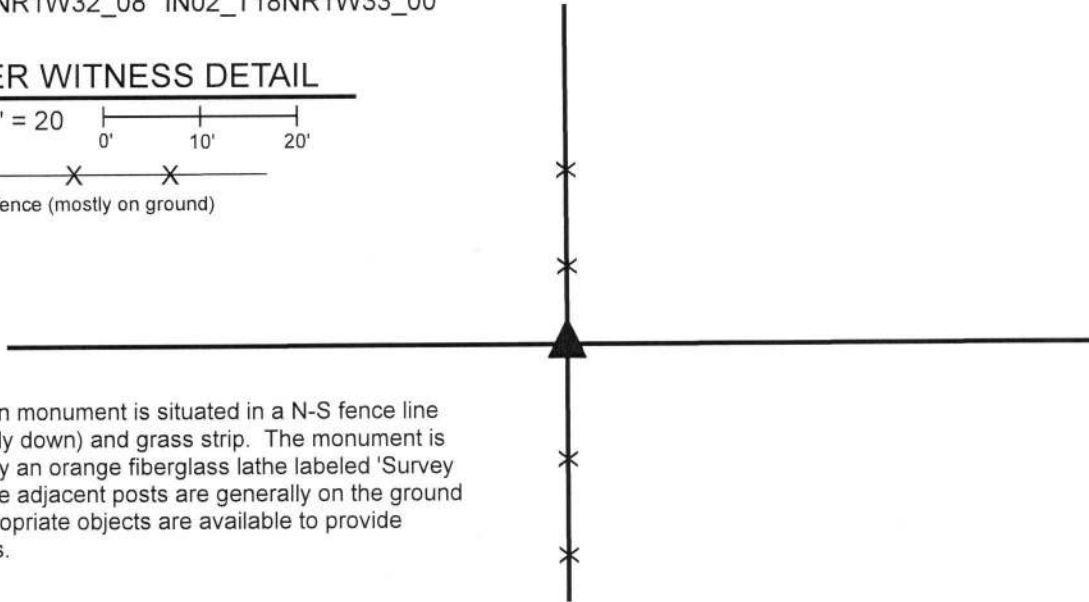

The Harrison monument is situated in a N-S fence line (fence mostly down) and grass strip. The monument is witnessed by an orange fiberglass lathe labeled 'Survey Marker.' The adjacent posts are generally on the ground and no appropriate objects are available to provide distance ties.

The Harrison monument was set over the base of a wood corner post found.

No specific descriptions of this corner were found in the BCS Surveyor's Record beyond the original establishment of the corner as a wood post in 1820. The corner is noted as the terminal point for measurements in BCS records on 1855 and 1857. No recent BCS tie cards were found referencing the corner. The corner is shown as a wood headpost on a survey by Ronald E. Wharry, LS #S0420, dated December 29, 2000 and recorded in Survey Book 5, page 36 in the Office of the Boone County Recorder.

This corner was excavated on March 29, 2019. Prior to excavation, an 8 inch by 8 inch wood corner post was found in a section of North-South fence. As found, the above-ground portion of the post was no longer attached to the ground and was suspended amidst standing fencing, leaning substantially toward the east. The post was attached to fencing to the north and south and had evidence of fencing cut to the east. The post was still attached to a wood brace on the north side and a notch for a former brace was observed on the east side. The aforementioned Wharry survey shows fencing to the north, south, and east. Excavation in the vicinity of the post revealed a remnants of a wagon wheel found approximately two feet north of the post and numerous rocks were found around the post. Two stones were found below the wagon wheel. Neither the wheel nor stones could be positively identified as marking the corner and appeared to simply be lying partially embedded in the ground adjacent to the post. Two large rocks are situated immediately east of the post. A sandstone rock was found at 18 inches deep, immediately south of the post and several small rocks were found adjacent to the north and west edges of the post. The base of the post was found at approximately 14 inches deep. None of the rocks bore the characteristics of stones set purposely to mark the corner. The position of the post fit well with the relative locations of proximate corners and fit with the position of the corner as depicted on the Wharry survey. The base of the post was held as marking the corner. The remnants of the base of the post were left in the ground. Three sections of 1/2 inch diameter rebar, 2 feet long were driven around the remnants of the base of the post. The top of the base of the post and the rebars were encased in concrete and a Harrison monument was set directly above the base of the post.

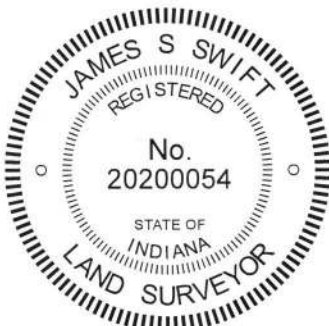

Kenneth E. Hedge
Kenneth E. Hedge, County Surveyor

James S. Swift
James S. Swift, IN LS 20200054
May 22, 2019

Jackson Township

Section 29 T18N, R1W	Section 28 T18N, R1W
Section 32 T18N, R1W	Section 33 T18N, R1W

SECTION CORNER RECORD

SW 600-300

BOONE COUNTY SURVEYOR'S OFFICE

DATA FOR CORNER 2 ONLY:

State Plane grid coordinates NAD83 (2011):

North: 1713689.49 East: 3109261.13 (U.S. survey feet)

Type of monument: Harrison, 4" disk 'Section Corner'

Depth: Four inches above adjacent ground

Indiana tie card references:

IN02_T18NR1W33_80 IN02_T18NR1W34_72

IN02_T17NR1W04_08 IN02_T17NR1W03_00

① S.E. Corner, Section 33
S.W. Corner, Section 34
T 18 N, R 1 W
POSITION NOT YET DETERMINED
SEE NOTES

② N.W. Corner, Section 3
N.E. Corner, Section 4
T 17 N, R 1 W
HARRISON MONUMENT SET



CORNER WITNESS DETAIL

SCALE 1" = 60'

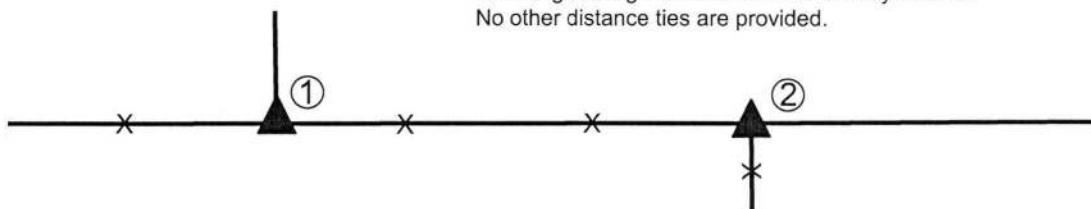

Note: The Harrison monument marking Corner 2 is situated at the east edge of a wood corner post at the intersection of fences to the south and west, witnessed by an orange fiberglass lathe labeled 'Survey Marker.' No other distance ties are provided.

The Harrison monument at Corner 2 was set in place of a stone found. The precise position of Corner 1 has not yet been established as of the date of publication of this document.

A BCS record of February 22, 1894 states, with respect to Corner 2, "Found from red oak stump after running line." The record does not specify the monument found. No specific descriptions of Corner 1 were found in the BCS Surveyor's Record beyond the original establishment of the corner as a wood post in 1819. An entry of September 30, 1971 calls Corner 1 as "Stone Found Railroad Rail put in" but no further information was found with respect to this entry and it is believed most likely to be a reference a different corner entirely.

The stone at Corner 2 was found with the top approximately 2 inches above flush at the east edge of an ancient corner post, being at the corner of fences to the south and west. The stone is known to have been held as marking the corner by numerous surveys in the past including a survey by Dewey L. Witte, LS #29800022, recorded in Survey Book 11, pages 16-17 in the Office of the Boone County Recorder and a survey by Mark A. Schepers, LS #29500001, recorded in Survey Book 18, page 63 in said Recorder's Office. The stone is also shown as marking the Corner 2 on Bruner Minor Plat recorded in Plat Book 14, page 27 in said Recorder's Office. The stone was found, apparently undisturbed in May, 2018. The position of the stone matched closely with the position shown on the aforementioned surveys and plat. The stone was horizontal and oriented NW-SE. It measured 21 inches NW-SE by 10 inches NE-SW by 8 inches tall. A clear and distinct etched "+" mark was found on the approximate top center of the rock. Although, evidently not disturbed in position in recent years, the stone was not particularly stable in the ground, and was able to be moved with a shovel with reasonably minimal effort. Being neither vertical nor oriented in cardinal directions, the stone does not fit the characteristics associated with most found and accepted corner stones. However, the mark on the stone was readily visible and it is known to have been held as marking the corner by numerous surveyors. Given the obvious mark on the top of the stone and the acceptance of the monument as marking the corner by previous surveyors along with a lack of obvious contrary evidence, the stone was held as marking Corner 2. The stone was removed and another, smaller, though vertical, stone was found below. The lower stone was left in place and a Harrison Monument was set in place of the etched mark on the top stone on May 16, 2019. Minimal uncertainty is associated with the position of Corner 2, as monumented. However, significant uncertainty is associated with the position of Corner 1. The two recorded surveys referenced above both call Corner 1 as a wood corner post found approximately 148 feet west of the stone. The Bruner Minor Plat, which defines the properties to the northeast of Corner 1 and southeast of Corner 2 shows Corner 1 as being 167.6 feet (254 links) west of the stone at Corner 2, matching the original federal offset at this corner recorded in 1820. Hence, an uncertainty of approximately 20 feet east-west is attributed to the position of Corner 1. The post called in the surveys was found and is notably the only physical evidence observed of the line bearing north from Corner 1. As additional research is required to resolve the conflict between the surveys and plat, the final position of Corner 1 will be established at a later date. The position of Corner 2 is affirmed at this time in support of establishing alignment for corners to the east in association with the imminent reconstruction of the County Road 600 South bridge over Grassy Branch. Corner 1 was originally established as a wood post in 1819 and Corner 2 was originally established as a wood post in 1820.

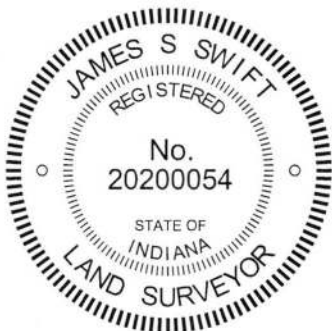

Kenneth E. Hedge
Kenneth E. Hedge, County Surveyor

James S. Swift
James S. Swift, IN LS 20200054

July 9, 2019

Harrison Township

Section 33 T18N, R1W	Section 34 T18N, R1W
Section 4 T17N, R1W	Section 3 T17N, R1W