

SECTION CORNER RECORD

NE 900-800

BOONE COUNTY SURVEYOR'S OFFICE

State Plane grid coordinates NAD83 (CORS96):

North: 1794194.48 East: 3166488.82 (U.S. survey feet)

Type of monument: Harrison, 4" disk 'Section Corner'

Depth: six inches below adjacent gravel road surface

Indiana tie card references:

IN02_T20NR2E17_80 IN02_T20NR2E16_72

IN02_T20NR2E20_08 IN02_T20NR2E21_00

CORNER WITNESS DETAIL

SCALE 1" = 40'

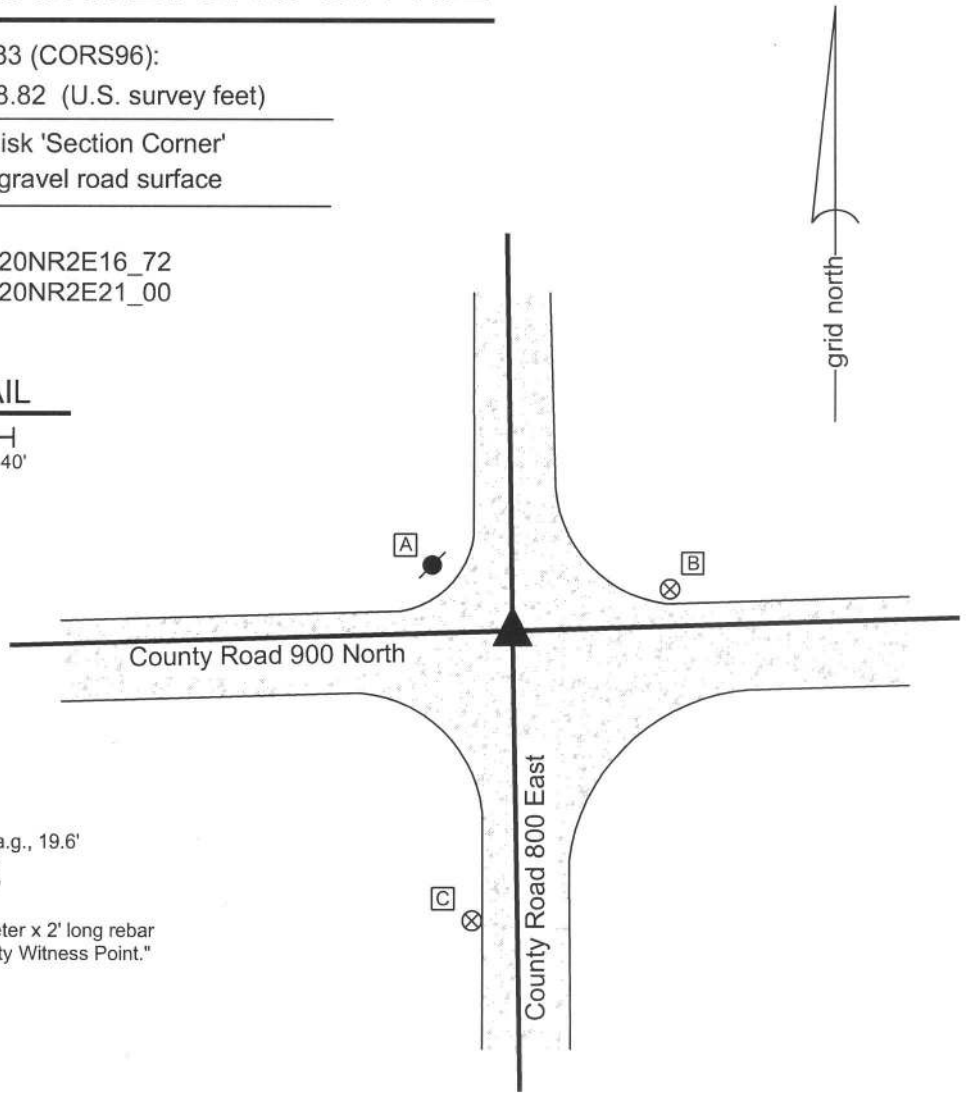
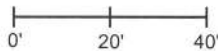

- A - Mag nail set in S.E. side power pole, 2' a.g., 19.6'
- B - Boone County witness mark, flush, 33.8'
- C - Boone County witness mark, flush, 61.1'

Boone County witness mark is a 3/8" diameter x 2' long rebar bearing a metal cap stamped "Boone County Witness Point."

The Harrison monument was set over a stone found.

A BCS record of April 28, 1883 states "found from Oak stump, set no monument." Subsequent records of 1903, 1908 mention the corner as the terminal point for measurements, but do not specifically describe a monument. A BCS tie card dated August 21, 1974 states "no stone found." This corner was excavated on September 10, 2013. Prior to excavation a railroad spike was found at 6 inches deep at the intersection of the gravel roads. The source of the railroad spike is not known. Excavation revealed a piece of an old wood stake found below the railroad spike. Further excavation revealed a stone found at 18 inches deep, slightly north of the railroad spike. With the top 8 inches of the stone exposed, it measured 8 inches E-W by 8 inches N-S. The stone was vertical with a distinct high point and was embedded in the clay layer below the road with the top of the stone at the bottom of the road bed. The stone fit very well with local evidence in the form of visual reckoning of the longer centers of the two roads, fit the characteristics of stones found at many other corners throughout the county and was accepted as the best available evidence of the corner. The stone was left in place, the top 3 inches were encased in concrete and a Harrison monument was set over the top high point. The railroad spike, removed during excavation, had been 1.3 feet south and 0.3 foot east of the stone. This corner was originally established as a wood post in 1821.

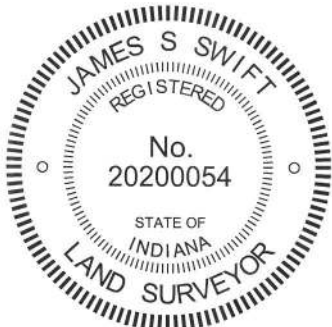

Kenneth E. Hedge
 Kenneth E. Hedge, County Surveyor

James S. Swift
 James S. Swift, IN LS 20200054
 February 5, 2015

Marion Township

Section 17 T20N, R2E	Section 16 T20N, R2E
Section 20 T20N, R2E	Section 21 T20N, R2E

PHOTOGRAPHIC DOCUMENTATION

Date of photography: September 10, 2013

View of the stone from above and west.



View of the stone from above and north.



View from the east, looking across the stone and west along County Road 900 North.



View from the south, looking across the stone and north along County Road 800 East.



For details and documentation, refer to related sheet "Section Corner Record."

SECTION CORNER RECORD

NE 900-850

BOONE COUNTY SURVEYOR'S OFFICE

State Plane grid coordinates NAD83 (CORS96):

North: 1794274.46 East: 3169149.43 (U.S. survey feet)

Type of monument: Harrison, 4" disk 'Section Corner'

Depth: six inches below adjacent gravel road surface

Indiana tie card references:

IN02_T20NR2E16_76

IN02_T20NR2E21_04



CORNER WITNESS DETAIL

SCALE 1" = 30'

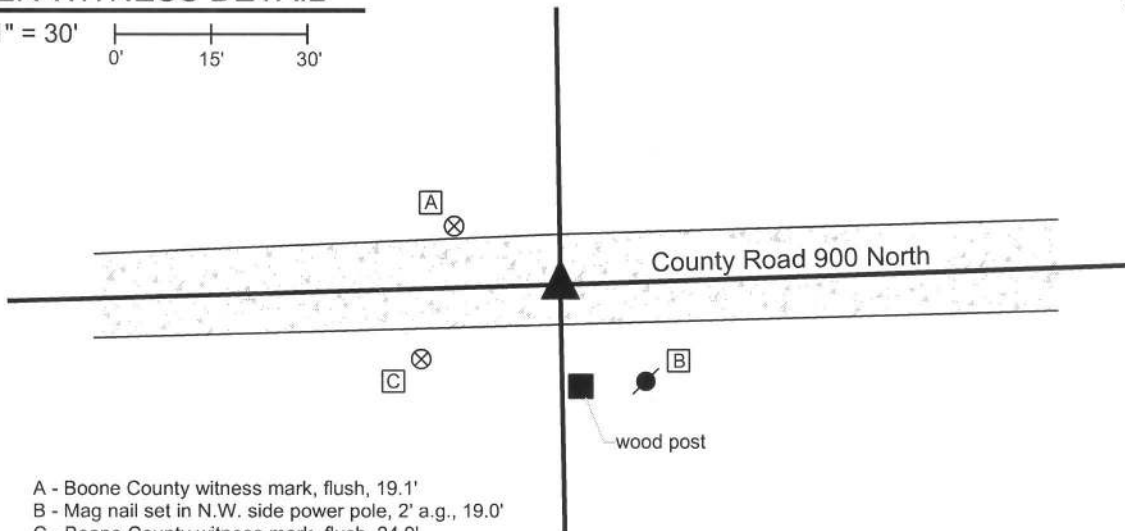
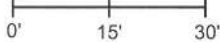

- A - Boone County witness mark, flush, 19.1'
- B - Mag nail set in N.W. side power pole, 2' a.g., 19.0'
- C - Boone County witness mark, flush, 24.9'

Boone County witness mark is a 3/8" diameter x 2' long rebar bearing a metal cap stamped "Boone County Witness Point."

The harrison monument was set in place of a stone found.

A BCS record of September 30, 1872 states "found from stump of Oak." A BCS record of November 10, 1903 states "Run line "G" to "E". F set rock + 6, 20,22." A BCS tie card dated August 17, 1974 states "No stone."

This corner was excavated on September 10, 2013. Prior to excavation, a vertical section of railroad rail was found at 11 inches deep in the gravel road. Excavation revealed a stone found at 18 inches deep, west of the rail. The stone was removed, measured and found to be 19 inches tall by 22 inches N-S by 9 inches E-W. No specific marks were found on the stone, nor were any noted in the 1903 record. The stone was of similar proportions as that described in the 1903 record and it is noted that the only substantial variation between the record and measured dimensions was in the E-W dimension, being measured as 6 inches whereas the record reports 9 inches. The stone was accepted as marking the corner. A harrison monument was set in position of the center of the top of the stone.

The rail had been 1.5 feet east and 0.7 foot south of the stone. It is believed that the rail was most likely set in association with the creation of the 1974 tie card. Clearly the statement "no stone" on that record was erroneous. The rail was removed during excavation.

This corner was originally established as a wood post in 1821.

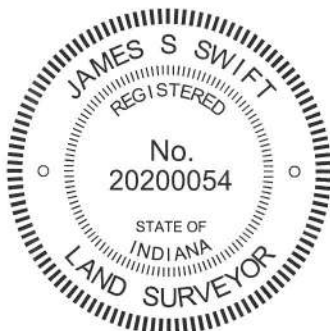

Kenneth E. Hedge, County Surveyor

James S. Swift, IN LS 20200054
February 5, 2015

Marion Township

Section 16
T20N, R2E

Section 21
T20N, R2E

PHOTOGRAPHIC DOCUMENTATION

Date of photography: September 10, 2013

View of the stone being exposed.



View of the stone from above and east.



View of the stone from above and west.



View from the north, showing the stone and the post on the south side of the road.



The stone and rail, removed from the road.



For details and documentation, refer to related sheet "Section Corner Record."

SECTION CORNER RECORD

BOONE COUNTY SURVEYOR'S OFFICE

NE 900-900

State Plane grid coordinates NAD83 (CORS96):

North: 1794361.35 East: 3171813.19 (U.S. survey feet)

Type of monument: Harrison, 4" disk 'Section Corner'

Depth: One inch below adjacent road surface

Indiana tie card references:

IN02_T20NR2E16_80 IN02_T20NR2E15_72

IN02_T20NR2E21_08 IN02_T20NR2E22_00

CORNER WITNESS DETAIL

SCALE 1" = 40'

- A - Boone County witness mark, flush, 25.24'
- B - Mag nail set in S. side power pole, 2' a.g., 51.06'
- C - Mag nail set in N.W. corner wood post, 1.5' a.g., 16.29'

Boone County witness mark is a 3/8" diameter x 2' long rebar bearing a metal cap stamped "Boone County Witness Point."

The harrison monument was set in place of a vertical section of railroad rail found. A BCS record of February 17-18, 1869 states "Found from stump of Beech and stake. Reestablished set two rocks. One 9.8 by 6 in. marked +. Top rock 13.9.5 1/2 +." No recent BCS tie cards were found referencing this corner.

Excavation was performed at this corner on July 18, 2013. Prior to excavation, a railroad rail was found at 9 inches deep in a hole in the asphalt roadway. Excavation of an area approximately centered on the rail and extending 2.5 feet east, south and west and extending 3 feet north at the northwest corner of the hole and 1 foot north at the northeast corner of the hole (due to the presence of a phone line marked on the pavement) revealed no further evidence of the corner. The bottom of the road bed was found at 20 inches deep, which is substantially deeper than the grade of the surrounding land. No explanation is offered for this, as typically the depth of the road bed generally relates to the elevation of the surrounding ground. Excavation was performed to 30 inches deep, well into the clay layer below the road and probing was performed to another 2 feet deep in the immediate vicinity of the rail. The lack of documentation for the rail is problematic, as most rails set for corners in Boone County were set by representatives of this office. Some rails are believed to have been set by employees of Carl Anderson after he ceased being County Surveyor in 1972. It is known that a common practice of the crews which set the rails were to remove a stone, if found, and replace it with a rail. Without documentation it is not possible to know if a stone previously found and replaced with a rail, but that represents one possible explanation for why no stone was found. Another explanation relates to the deep road bed where previous experience would guide one to expect a shallow road bed, given the similar elevations of the road and the surrounding ground. Perhaps the stone was removed during excavation for the more substantial road bed, whenever and if, that may have happened. The rail fits with local evidence of the corner being in the center of the N-S roadway and in line with the old end post to the east. The rail was accepted as the best available evidence of the corner and replaced with a harrison monument in the same position.

This corner was originally established as a wood post in 1821.

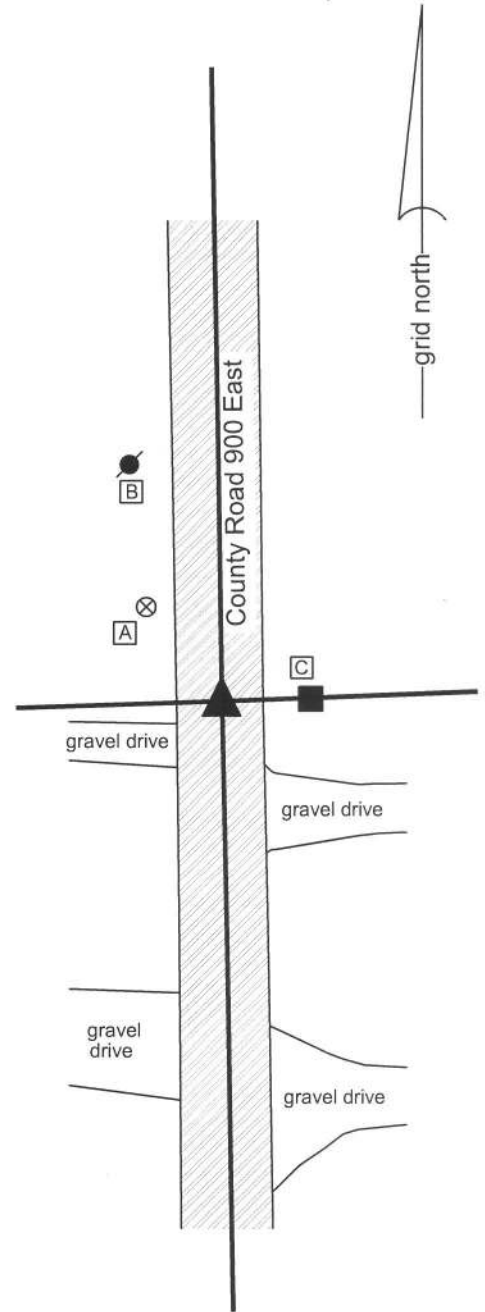

Kenneth E. Hedge
 Kenneth E. Hedge, County Surveyor

James S. Swift
 James S. Swift, IN LS 20200054
 February 5, 2015

Marion Township

Section 16 T20N, R2E	Section 15 T20N, R2E
Section 21 T20N, R2E	Section 22 T20N, R2E

SECTION CORNER RECORD

NE 950-800

BOONE COUNTY SURVEYOR'S OFFICE

State Plane grid coordinates NAD83 (CORS96):

North: 1796837.30 East: 3166448.48 (U.S. survey feet)

Type of monument: Harrison, 4" disk 'Section Corner'

Depth: two inches below adjacent road surface

Indiana tie card references:

IN02_T20NR2E17_44

IN02_T20NR2E16_36



CORNER WITNESS DETAIL

SCALE 1" = 30'
0' 15' 30'

- A - N. edge metal stop sign post, flush, 12.65'
- B - Boone County witness mark, flush, 26.65'
- C - Boone County witness mark, flush, 27.88'

Boone County witness mark is a 3/8" diameter x 2' long rebar bearing a metal cap stamped "Boone County Witness Point."

The harrison monument was set in place of a 5/8 inch diameter rebar found.

A BCS record of April 28, 1883 states, with respect to this corner, "Point found but not marked." A BCS tie card dated August 24, 1974 states "stone found." A Clinton County tie card dated March, 2009 shows the corner as an "IRON BAR 2" deep, 3' W CL RD."

This corner was excavated on October 11, 2013. Prior to excavation a 5/8 inch diameter rebar was found in the west half of the road, in apparent agreement with the 2009 Clinton County tie card. Excavation of an area extending 3 feet north, 5 feet east, 4 feet south and 3 feet west of the rebar revealed no further evidence. No distance ties remain from the 1974 BCS tie card which references a stone found. It is not specifically known whether the found rebar is in the same position as the stone found in 1974. Nonetheless, the found rebar was the only evidence of the corner found and was held as marking the corner. The rebar was removed and replaced with a harrison monument in the same position.

This corner was originally established as a wood post in 1821.

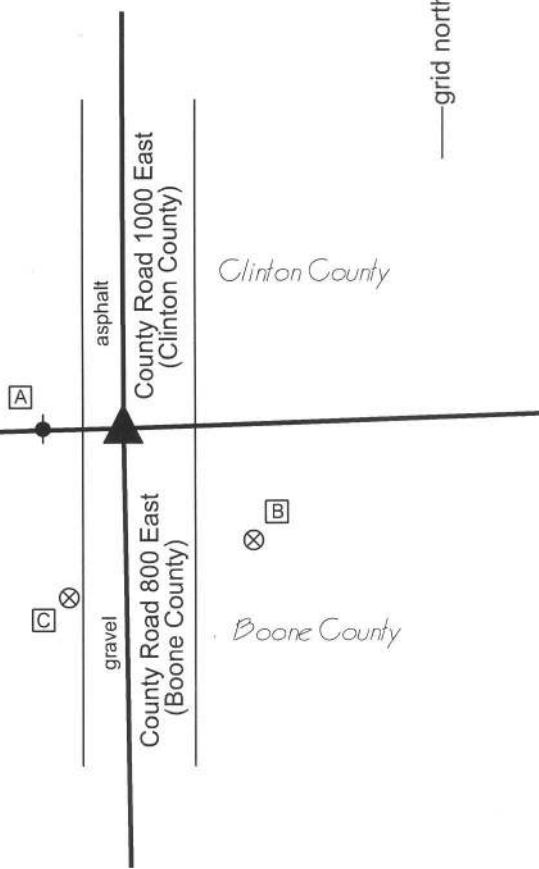

 Kenneth E. Hedge, County Surveyor

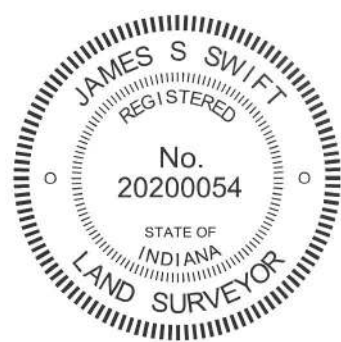

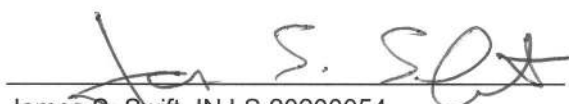
 James S. Swift, IN LS 20200054
 February 5, 2015



Sugar Creek Twp
Clinton County

SECTION CORNER RECORD

NE 950-900

BOONE COUNTY SURVEYOR'S OFFICE

State Plane grid coordinates NAD83 (CORS96):

North: 1797012.05 East: 3171766.08 (U.S. survey feet)

Type of monument: Harrison, 4" disk 'Section Corner'

Depth: One inch below adjacent road surface

Indiana tie card references:

IN02_T20NR2E16_44

IN02_T20NR2E15_36

CORNER WITNESS DETAIL

SCALE 1" = 30'

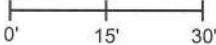

- A - Boone County witness mark, flush, 20.94'
- B - Speed Limit 40 sign, E. edge, flush, 52.83'
- C - Mag nail set in S. side wood post, 2' a.g., 24.76'

Boone County witness mark is a 3/8" diameter x 2' long rebar bearing a metal cap stamped "Boone County Witness Point."

Clinton County

Boone County

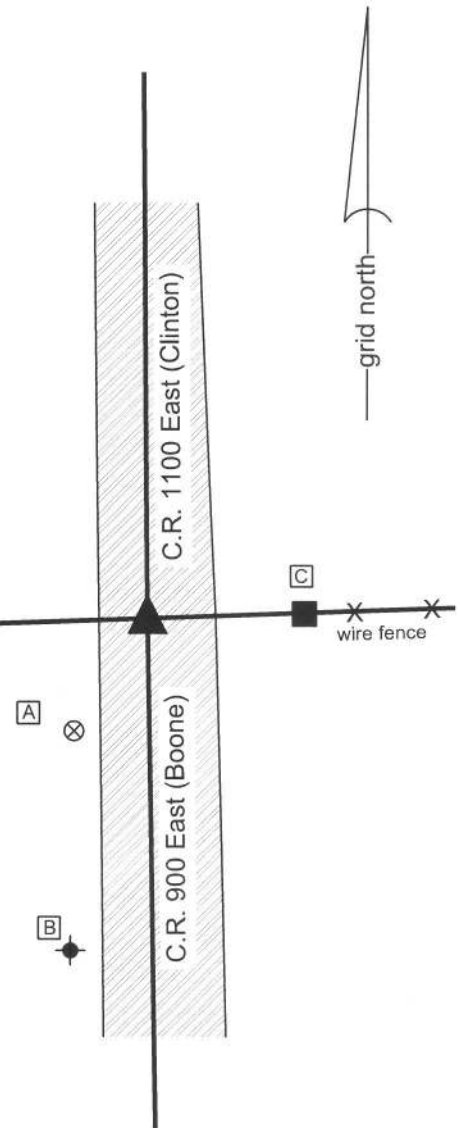

The Harrison monument was set over a stone found.

No specific descriptions of this corner were found in the BCS Surveyor's Record, though the corner is mentioned as the terminal point for measurements in records of 1838 and 1872. A undated, loose sheet found in the pages of the BCS Surveyor's record shows this corner as being marked by a rock 13.10.7 + over another rock 7.5.3 1/2 +. The source of this sheet is not known but it appears quite old and references several other corners, at which the described rocks were also found. No recent BCS tie cards were found referencing this corner. A Clinton County tie card shows the corners as being a stone 4 inches deep.

This corner was excavated on October 10, 2013 with Dan Sheets, Clinton County Surveyor, present. No metallic monument was found prior to excavation, though the distance ties from the 1974 tie card were yet present. Excavation of the point indicated to be the corner on the 1974 tie card yielded a stone found at 4 inches deep. With 5 inches of the top of the stone exposed, it measured 11 inches N-S by 8 inches, E-W, approximating the dimensions described on the undated sheet mentioned above. The stone was embedded in the clay layer below the road, protruding approximately 4 inches into the bottom of the road bed. The top 5 inches of the stone were encased in concrete and a Harrison monument (4 inches tall) was set over the high point of the stone, near the north edge.

This corner was originally established as a wood post in 1821.

Kenneth E. Hedge, County Surveyor



James S. Swift, IN LS 20200054
February 5, 2015

Sugar Creek Twp
Clinton County
Marion Township
Boone County

Section 16 T20N, R2E	Section 15 T20N, R2E
-------------------------	-------------------------