

SECTION CORNER RECORD

NW 400-300

BOONE COUNTY SURVEYOR'S OFFICE

State Plane grid coordinates NAD83 (CORS96):

North: 1766697.91 East: 3108886.25 (U.S. survey feet)

Type of monument: 5/8" rebar with metal cap stamped "Boone County Surveyor"

Depth: Flush with adjacent ground

Indiana tie card references:

IN02_T19NR1W09_80 IN02_T19NR1W10_72

IN02_T19NR1W16_08 IN02_T19NR1W15_00

CORNER WITNESS DETAIL

SCALE 1" = 40'



Note: the capped rebar is approximately 1 foot west of the asphalt golf cart path and approximately 25 feet southeasterly along the edge of the path from the intersection of the south edge of the path with the south edge of the adjacent path. Additional, specific distance ties are not provided.

The rebar was set in a computed position.

A BCS record of October 12, 1912 states "located from line tree 5.86 [chains] north of corner. Drove stake." The corner is also included in a metes and bounds description written out in the BCS Surveyor's Record, dated June 7, 1943. This description places the corner at 2648 feet south of the east quarter corner of section 9. The description also places the east quarter corner at 2649 feet east of the center of section. The east quarter corner (see documentation for corner NW 450-300) was established per a stone found in 1970. The center of section (NW 450-350) has not been excavated, though a nail at the county road intersection is believed to be set over the top of a railroad rail slanted over a stone, per BCS records of 1970. The distance between the east quarter corner and the nail believed to be marking the center of section agrees precisely with the 1943 distance, within uncertainties of significant digits.

No monumentation or evidence of the subject corner was found in the immediate vicinity of the expected position thereof. A well established, ancient fence was found to the north, beginning approximately 350 feet north of the corner. The subject corner was established at 2648.13 feet from the east quarter corner on a line prolonged from the east quarter corner south along the existing, ancient fence. Establishing the corner as such holds the best available evidence of the section line in the form of the fence, holds the distance from the 1943 description and honors the same approach to establishing the corner as the 1912 corner record. The precise distance of 2648.13 feet, rather than 2648.0, was borrowed from a survey by C. David Helton dated June 15, 1998 and recorded as instrument 9809245 in the Office of the Boone County Recorder. The position of the corner as defined by the fence prolonged to the south (i.e. the approach held to compute the position of this corner) falls approximately 1.7 feet west of the position of the corner held by Helton, as computed from remote points shown on that survey.

This corner was originally established as a wood post in May, 1829.

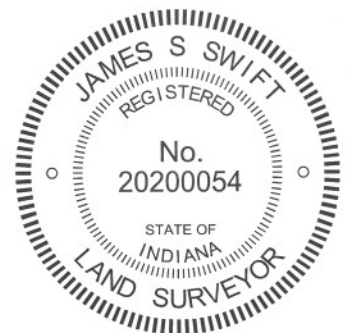
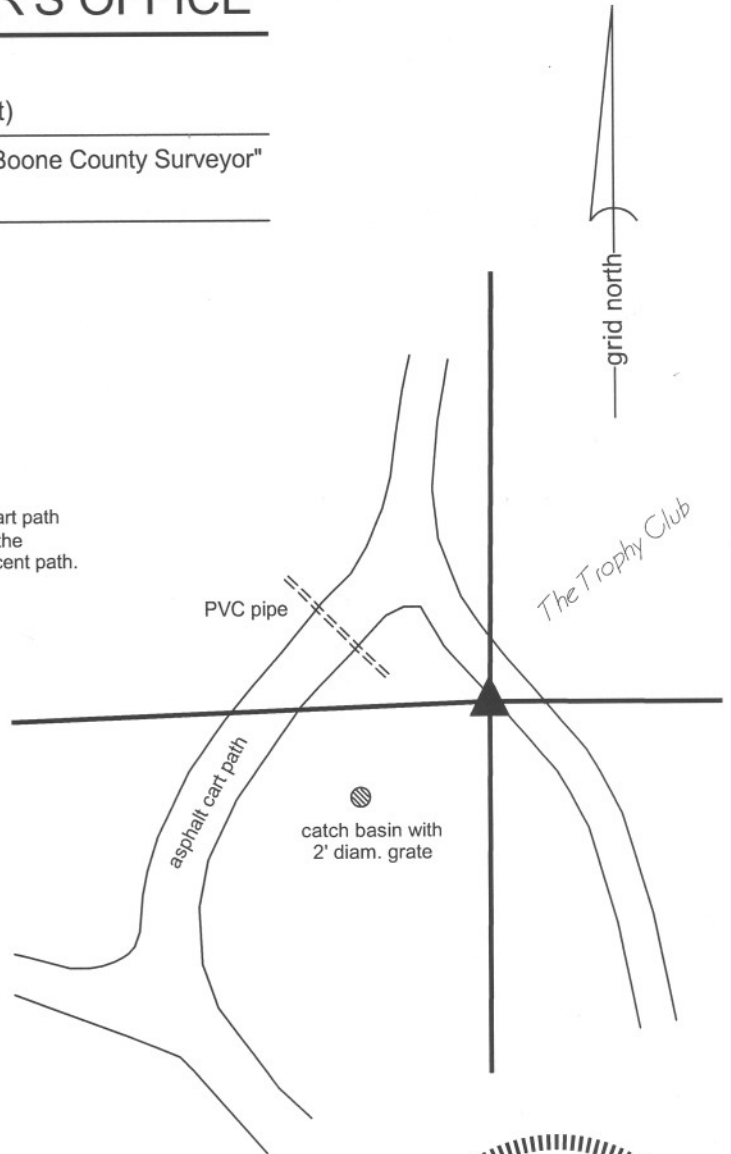

Kenneth E. Hedge
Kenneth E. Hedge, County Surveyor

James S. Swift
James S. Swift, IN LS 20200054
January 15, 2013

Washington Township

Section 9 T19N, R1W	Section 10 T19N, R1W
Section 16 T19N, R1W	Section 15 T19N, R1W

Center Township

SECTION CORNER RECORD

BOONE COUNTY SURVEYOR'S OFFICE

NW 450-300

State Plane grid coordinates NAD83 (CORS96):
 North: 1769345.95 East: 3108909.04 (U.S. survey feet)

Type of monument: Harrison, 4" disk 'Section Corner'
 Depth: Flush with adjacent road surface

Indiana tie card references:
 IN02_T19NR1W09_44
 IN02_T19NR1W10_36



CORNER WITNESS DETAIL

SCALE 1" = 40'

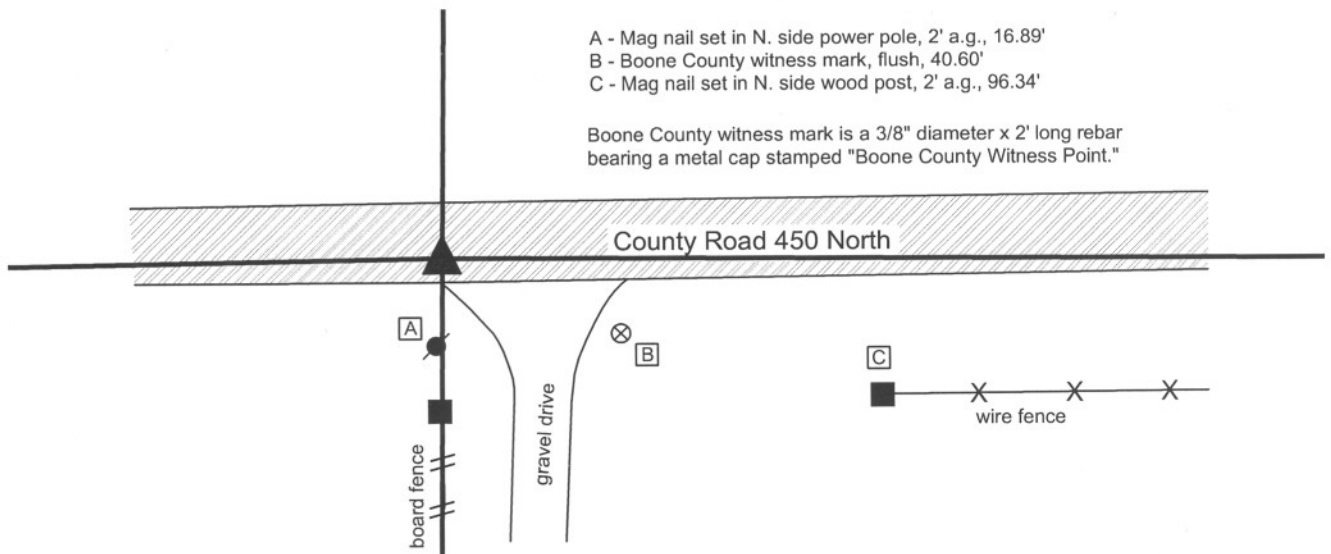

The harrison monument was set over a vertical section of railroad rail found.
 No specific descriptions of this corner were found in the BCS Surveyor's record, though it is mentioned in a metes and bounds description written out in said record, dated 1943. A BCS tie card dated August 1970 states "stone located. Set rail."
 The railroad rail was found 11 inches deep in a hole in the asphalt. It is known that is was a common practice for BCS field crews in 1970 to remove a stone, when found, and replace it with a rail. The reference on the tie card to "stone located. Set Rail" is accepted as confirmation that the stone was most likely removed. The rail was accepted as marking the corner. The rail was left in place and a harrison monument was set directly over the top of the rail on May 3, 2012.
 This corner was originally established as a wood post in May, 1829.



Kenneth E. Hedge
 Kenneth E. Hedge, County Surveyor

James S. Swift
 James S. Swift, IN LS 20200054
 January 15, 2013

Washington Township

