

SECTION CORNER RECORD

NW 250-200

BOONE COUNTY SURVEYOR'S OFFICE

State Plane grid coordinates NAD83 (CORS96):

North: 1758777.24 East: 3114222.50 (U.S. survey feet)

Type of monument: Harrison, 4" disk 'Section Corner'

Depth: One inch below adjacent road surface

Indiana tie card references:

IN02_T19NR1W22_44

IN02_T19NR1W23_36

CORNER WITNESS DETAIL

SCALE 1" = 40'

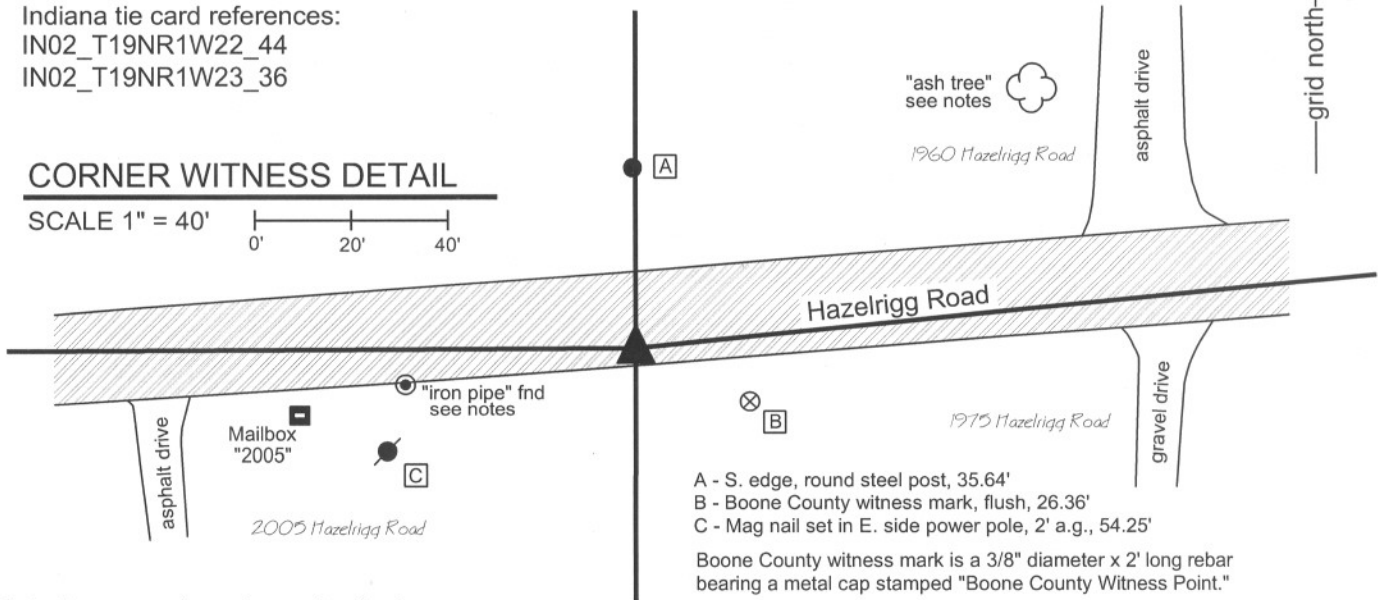

- A - S. edge, round steel post, 35.64'
- B - Boone County witness mark, flush, 26.36'
- C - Mag nail set in E. side power pole, 2' a.g., 54.25'

Boone County witness mark is a 3/8" diameter x 2' long rebar bearing a metal cap stamped "Boone County Witness Point."

The harrison monument was set over a stone found.

A BCS record of September 14-17, 1857 states "Reest'd. Set Rock 5x22." A BCS record of October 12, 1912 states, with respect to this corner, "Taken out by contractors grading road, and replaced in same point. June 5, 1886." It is not clear from the record how the two dates, 10/12/1912 and 6/5/1886 relate to the actions described. It is also not clear that the same object which was taken out was replaced. It is only stated that it was replaced at the same point.

This corner was excavated on August 12, 2010. Prior to excavation, significant confusion appeared to exist with respect to the location of this corner. The deeds for the parcels on the south side of Hazelrigg Road contain various references for ties to the land section, including references to a wooden headpost at the southeast corner of section 22, an iron bar at the southeast corner of section 22, a tie to the "intersection of the west line of section 23 with the East-West centerline of said Section 23" and a references to an "iron pipe pin, set for the east quarter section corner of said Section 22..." The last quote is taken directly from Instrument 9810158 in the Office of the Boone County Recorder. The description contains a bearing/distance tie for the "iron pipe pin" to a 36 inch Ash tree. Both the tree and the iron pipe were found. With the exception of the specific call for the iron pipe pin, the descriptions of the parcels on the south side of the road indicate that the surveyors who created those descriptions did not know the specific location the east quarter corner of section 22.

Investigation of evidence of the section line to the north of Hazelrigg Road yields much more clarity of the location of the section line. Sections of an ancient north-south fence were found in the woods approximately 1500 feet north of the corner. The parcel for the INDOT garages on US 52 is clearly fenced with newer chain link type fence. The westerly of the fences is slightly east of old fence. The easterly of these fences is at 400 feet east of the line defined by the remnants of fence, which is the record east-west dimension for the INDOT parcel. A steel post on the north side of Hazelrigg Road appears to be the easterly edge of an old gate for the entrance to the property immediately northwest of the corner. Holding the stone found at the corner to the north (see NW-300-200) and extending the line to the south through the remnants of ancient fence, the line appears to fit well with INDOT parcel and the parcels on the north side of the road. Excavation was performed in Hazelrigg Road at the point where this N-S line intersects a line defined by the easterly extension of the approximate center of Hazelrigg Road as it exists at the center of section 22 and for approximately 1000 feet east, prior to angling to the south. No metal monumentation was found at this point prior to excavation. Excavation revealed a stone found embedded in the clay layer below the road near the estimated position of the corner. The stone is at 26 inches deep and is 8 inches N-S by 7 inches E-W by 4 1/2 inches tall. The stone, being embedded in the clay layer below the road and oriented in cardinal directions, fits with characteristics of other stones found marking section corners throughout the county. It does not match the description of "5x22" called for in the 1857 record, but it is noted that that particular stone was found to have been displaced in 1886 or 1912 and it is not clear that the same stone was replaced. The found stone fits well with evidence of the line to the north in the form of the steel post on the north edge of the road, the ancient fence at 1500 feet north and the INDOT fences. It fits well with evidence to the west in the form of the center of Hazelrigg Road as it exists west of the point where it bends to the south. The stone was held as marking the corner and left in place. The harrison monument was set directly over the top, center of the stone.

It is noted that the "iron pipe pin" called for in Instrument 9810158 is located 7 feet south and 48 feet west of the corner marked by the stone. Aside from the deed call for this object to be marking the corner, no other evidence was found to support this position as the corner. It does not fit with any of the evidence to the north and no evidence was found with which it does fit, except the deed descriptions specifically called from it. Holding this point as the corner would cause significant disruptions of the occupied lines to the north, especially with respect to the well established fencing around the INDOT garage on U.S. 52. The "iron pipe pin" is considered erroneous as a position for the corner.



Kenneth E. Hedge
Kenneth E. Hedge, County Surveyor

James S. Swift
James S. Swift, IN LS 20200054

March 30, 2012, Revised April 30, 2012

Center Township

