

SECTION CORNER RECORD

NW 800-100

BOONE COUNTY SURVEYOR'S OFFICE

State Plane grid coordinates NAD83 (CORSS96):

North: 1787910.37 East: 3119517.40 (U.S. survey feet)

Type of monument: Harrison, 4" disk 'Section Corner'

Depth: One inch below adjacent road surface

Indiana tie card references:

IN02_T20NR1W23_80 IN02_T20NR1W24_72

IN02_T20NR1W26_08 IN02_T20NR1W25_00



CORNER WITNESS DETAIL

SCALE 1" = 40'

- A - Boone County witness mark, flush, 21.2'
- B - Mag nail set in N. side wood corner post, 2' a.g., 23.8'
- C - Mag nail set in N. side wood post, 2' a.g., 32.0'

Boone County witness mark is a 3/8" diameter x 2' long rebar bearing a metal cap stamped "Boone County Witness Point."

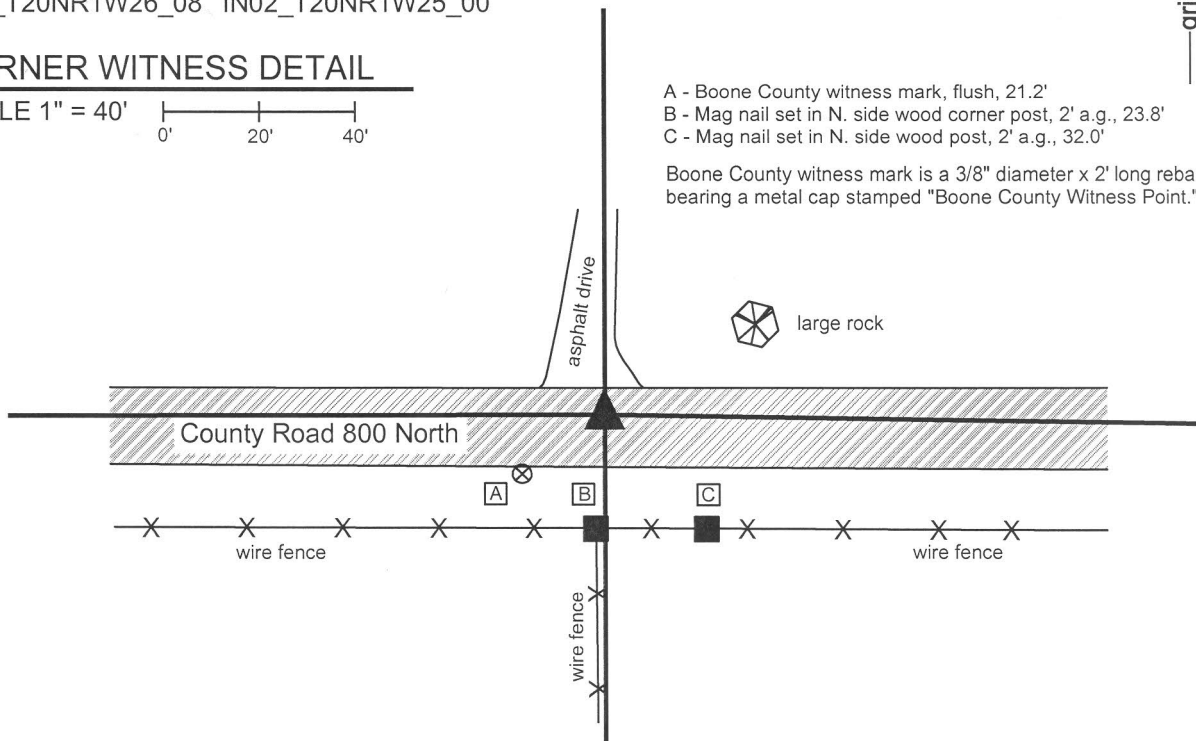

The Harrison monument was set in place of a railroad spike found.

A BCS record of August 25th 1859 states, with respect to this corner, "Rock from which another Rock 48 [links], N 28 1/2° E, 60 [links]." A BCS record of August 21, 1893 states "witness rock here." No recent BCS tie cards were found referencing this corner.

Excavation was performed at this corner on June 16, 2014. Prior to excavation, a railroad spike was found at the surface of the road, slightly north of the physical center of the road. A large rock was nearby, at approximately 60 links distance. The azimuth from the railroad spike to the rock was more like 58 degrees, than 28 degrees. This rock did not bear the characteristics of a "witness stone." Excavation of an area extending 2 feet north, 2 feet east, 4.5 feet south and 4.5 feet west of the railroad spike yielded no further evidence of the corner. Excavation was performed in an area sufficiently large to include the center of the road at the approximate intersection of the fence to the south and the center of the road at 60 links distance from the aforementioned large rock. The bottom of the road bed is at approximately 1 foot, under which a grey clay layer exists to about 16 inches. From 16 inches and deeper, a brown clay exists. Excavation was performed to at least 20 inches deep. The source of the railroad spike is not known and no explanation is offered as to why the stone which was known to exist in 1859 and 1893 was not found. The railroad spike fits with with adjacent section corners, is called for as marking the corner for some adjoining properties and is believed to represent the position of the corner from which other adjacent properties were described. It is noted that a position being S28°W, 60 links from the aforementioned large rock would fall well south of the roadway and would not fit with any of the local evidence of the corner. As no contrary evidence was found, the railroad spike was held as marking the corner. The railroad spike was removed during excavation and replaced with a Harrison monument set in the same position.

This corner was originally established as a wood post in 1822.

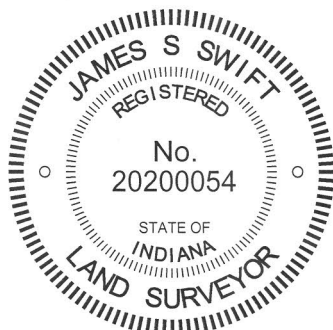

Kenneth E. Hedge
 Kenneth E. Hedge, County Surveyor

James S. Swift
 James S. Swift, IN LS 20200054
 March 27, 2015

Washington Township

